

31 Pads

Professional \ Floor cleaner \ Single disc machines \ BDS 43/150 C \ Spare parts list BDS43/150C,410C \ Accessories \ Pads

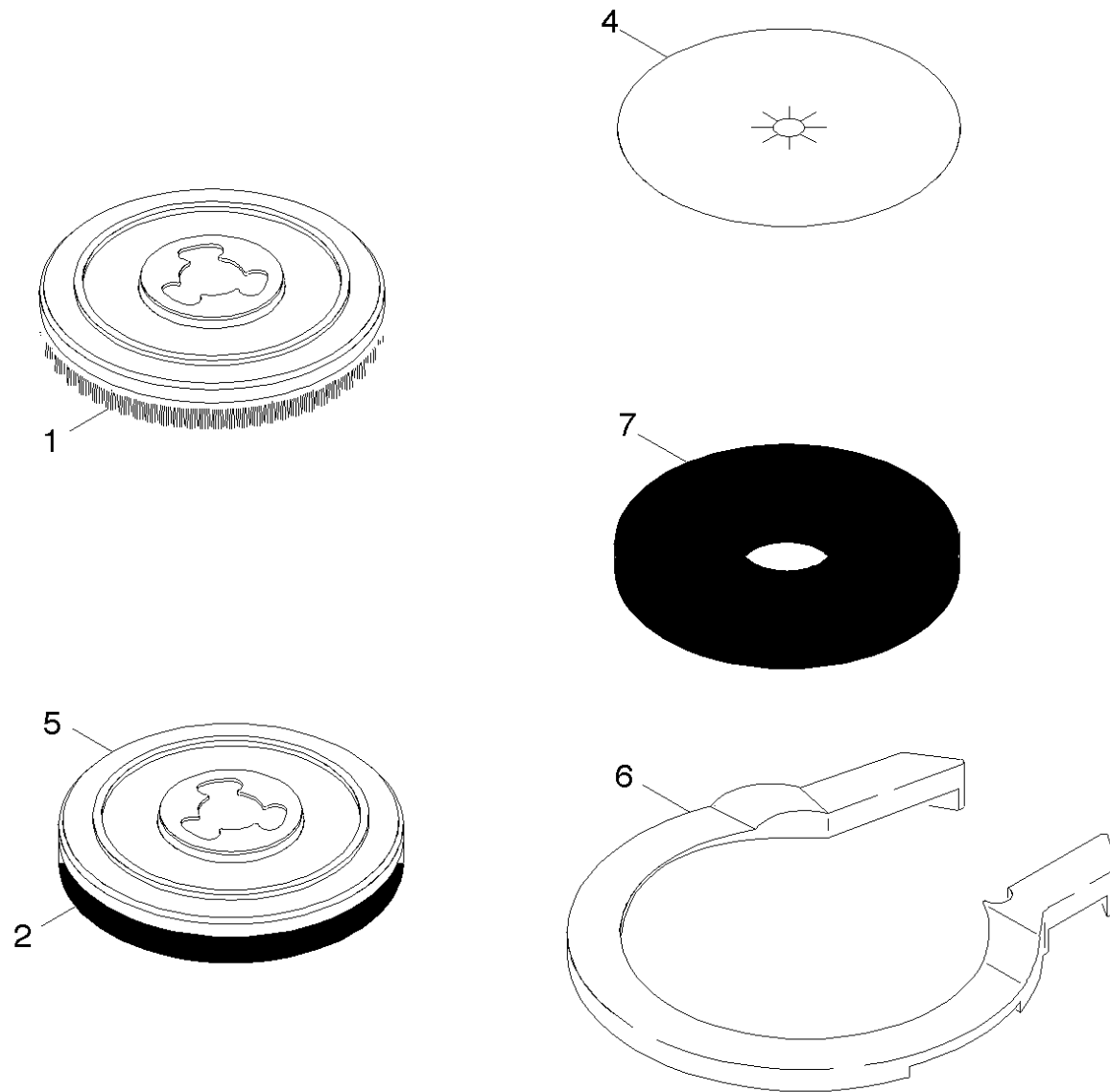

POS	Article no.	Description	Quantity	Unit	Foot note text
1	6.369-895.0	Scrubbing brush red (old colour white)	1.000	ST	
	Item text1: 1.291-202.0 / -214.0 / -215.0 / -218.0				
1	6.369-897.0	Polishing brush	1.000	ST	
	Item text1: 1.291-204.0 / -216.0				
1	6.369-898.0	Brush black (old colour grey)	1.000	ST	
	Item text1: 1.291-202.0 / -214.0 / -215.0 / -218.0				
1	6.369-896.0	Brush Shampoo BDS 43/150/DUO C	1.000	ST	
	Item text1: 1.291-202.0 / -214.0 / -215.0 / -218.0				
2	6.370-138.0	Polishing pad beige	1.000	ZSA	
	Item text1: 1.291-204.0 / -216.0				
2	6.371-257.0	Diamond pad yellow set 5x Ø432	1.000	ST	
	Item text1: 1.291-202.0 / -214.0 / -215.0 / -218.0				
2	6.369-473.0	Pad black	1.000	ZSA	
	Item text1: 1.291-202.0 / -214.0 / -215.0 / -218.0				
2	6.905-526.0	Pad micro-fibre	1.000	ZSA	
	Item text1: 1.291-202.0 / -214.0 / -215.0				
2	6.369-472.0	Pad green	1.000	ZSA	
	Item text1: 1.291-202.0 / -214.0 / -215.0 / -218.0				
2	6.369-469.0	Polishing pad white	1.000	ZSA	
	Item text1: 1.291-204.0 / -216.0				
2	6.369-470.0	Pad red	1.000	ZSA	
2	6.369-471.0	Pad blue	1.000	ZSA	
	Item text1: 1.291-202.0 / -214.0 / -215.0 / -218.0				
4	6.990-009.0	Grinding wheel	1.000	ZSA	
	Item text1: 1.291-202.0 / -214.0 / -215.0				
4	6.990-007.0	Grinding wheel	1.000	ZSA	
	Item text1: 1.291-202.0 / -214.0 / -215.0				
4	6.990-008.0	Grinding wheel	1.000	ZSA	
	Item text1: 1.291-202.0 / -214.0 / -215.0				
5	6.369-934.0	Grinding disk screed BDS 43/150 C	1.000	ST	
	Item text1: 1.291-202.0 / -214.0 / -215.0				
5	6.369-902.0	Disk grinding	1.000	ST	
	Item text1: 1.291-202.0 / -214.0 / -215.0				

31 Pads

Professional \ Floor cleaner \ Single disc machines \ BDS 43/150 C \ Spare parts list BDS43/150C,410C \ Accessories \ Pads



POS	Article no.	Description	Quantity	Unit	Foot note text
5	6.369-899.0	Disk LOW SPEED 420	1.000	ST	
	Item text1: 1.291-202.0 / -214.0 / -215.0 / -218.0				
5	6.369-900.0	Disk HIGH SPEED	1.000	ST	
	Item text1: 1.291-204.0 / -216.0				
5	6.369-901.0	Disk DUO SPEED	1.000	ST	
6	6.369-910.0	Additional weight 10KG	1.000	ST	
7	6.371-257.0	Diamond pad yellow set 5x Ø432	1.000	ST	YELLOW
	Item text1: 1.291-202.0 / -203.0 / -207.0				
7	6.371-256.0	Diamond pad white set 5x Ø432	1.000	ST	WHITE
	Item text1: 1.291-202.0 / -203.0 / -207.0				
7	6.371-238.0	Diamond pad green set 5x Ø432	1.000	ST	GREEN
	Item text1: 1.291-202.0/ -203.0 / -207.0 / -214.0				
	Item text2: / -215.0/ -218.0				