

# 10 Suction bar v-shaped 1000mm

Professional \ Floor cleaner \ Walk behind \ B 60 W Bp \*EU \ Documentation B 60 W \ Spare parts list B 60 W \ Suction bar \ Suction bar \ Suction bar v-shaped 1000mm \ Suction bar v-shaped 1000mm

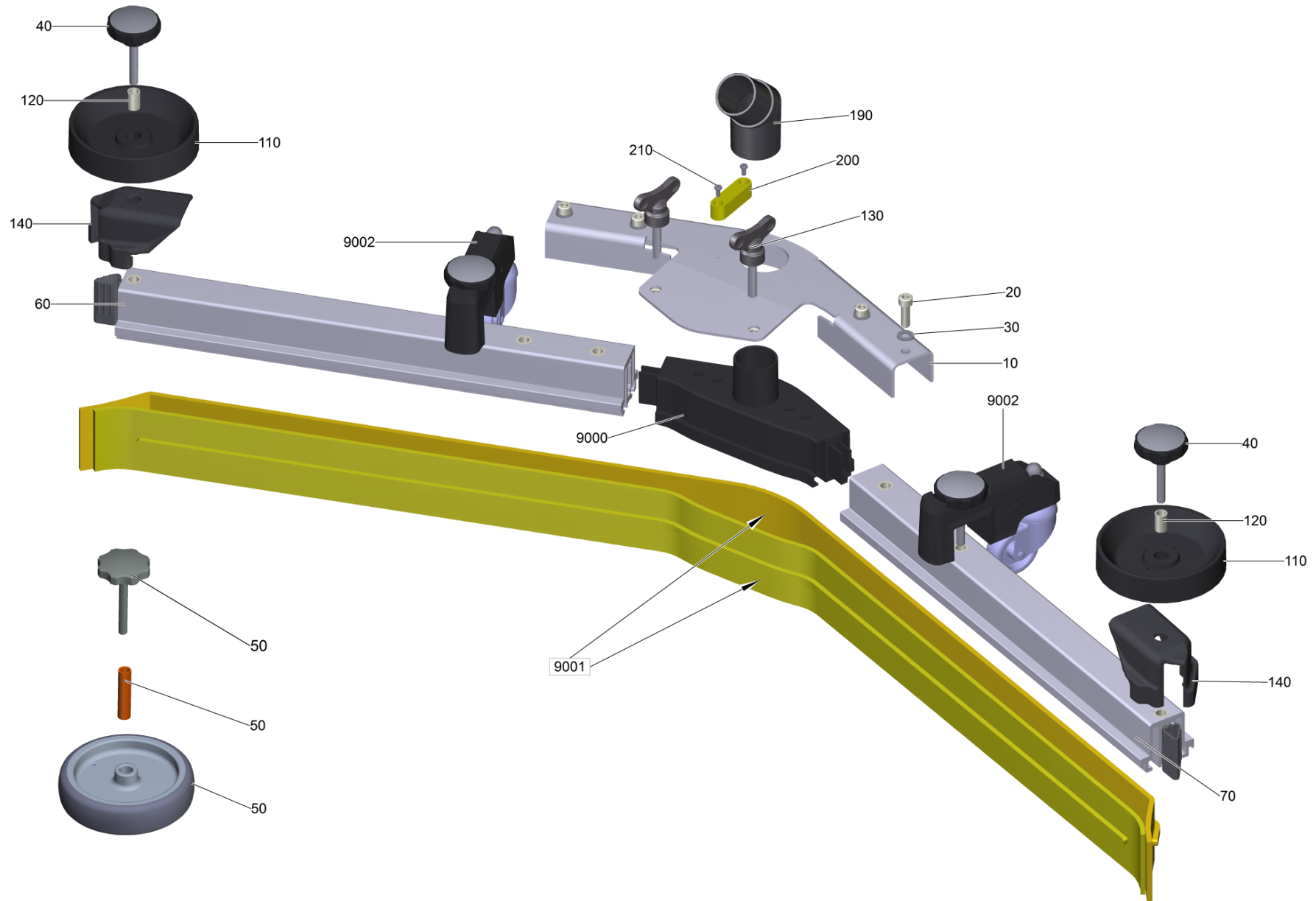

## 10 Suction bar v-shaped 1000mm

Professional \ Floor cleaner \ Walk behind \ B 60 W Bp \*EU \ Documentation B 60 W \ Spare parts list B 60 W \ Suction bar \ Suction bar \ Suction bar v-shaped 1000mm \ Suction bar v-shaped 1000mm

**KÄRCHER**

POS	Article no.	Description	Quantity	Unit	Foot note text
10	4.044-003.0	Holder complete V-profile	1	PC	
190	5.034-056.0	Angle adapter pipe	1	PC	
9001	6.273-024.0	Rubber lip set corrugated oil resistant	1	PC	
9000	4.034-007.0	Suction nipple complete	1	PC	
200	6.803-071.0	Level	1	PC	
140	2.885-294.0	End piece left / right spare parts set	1	PC	
70	4.035-223.0	Profile pre-assembled left AB 1000 mm	1	PC	
60	4.035-222.0	Profile pre-assembled right AB 1000 mm	1	PC	
50	4.435-005.0	Deflector roll suction bar complete	1	PC	VERSION 2
9500	4.035-619.0	Set deflector roll stack formation SB	1	PC	
110	5.515-346.0	Deflector roll suction bar D120	2	PC	VERSION 1
120	5.094-231.0	Sleeve suction bar in VA	2	PC	VERSION 1
130	5.305-008.0	Wing screw M8x30 VA	2	PC	
210	7.305-019.0	Countersunk screw M4x16 -8.8-P2R (In6Rd)	2	PC	
210	7.306-056.0	Screw M4x8 -8.8-R2R (In6Rd)	2	PC	
40	6.321-243.0	Star grip stainless steel D50x48	2	PC	VERSION 1
9002	4.035-171.0	Support roller complete replacement	2	PC	
9003	4.035-557.0	Support roller complete replacement	2	PC	
20	7.306-142.0	Cylinder head screw M 8x25-A4-70 ISO 47	4	PC	
30	7.312-017.0	Washer 8-A2 ISO 7089	4	PC	