

2. Various HD-M units, Cage and ST (1.150- /1.151- /1.524-9xx.0)

Control piston pressure switch
(4.624-301.3 /-414.3 /-416.3)

Service Bulletin.

No. 2021-011 dated 08/02/2021

Classification level III

- Problem:** After closing the handgun, the unit switches OFF only after a delay or not at all.
- Cause:** The control piston pressure switch is available in different versions for various units in the HD Middle Class.
There may possibly also be air left in the pump.
- Solution:** If the unit switches OFF with a delay, it is advisable to install the reworked, standardised control piston pressure switch (4.580-104.3). Correct switching OFF of the unit is thus improved.
The control piston pressure switch was already introduced in **SB 2019-004, point 4.**
Venting the unit correctly is also important. See point 6 (unit ventilation) of this bulletin.
The new control piston pressure switches are reverse-compatible. They can be fitted in existing cylinder heads without any problems.

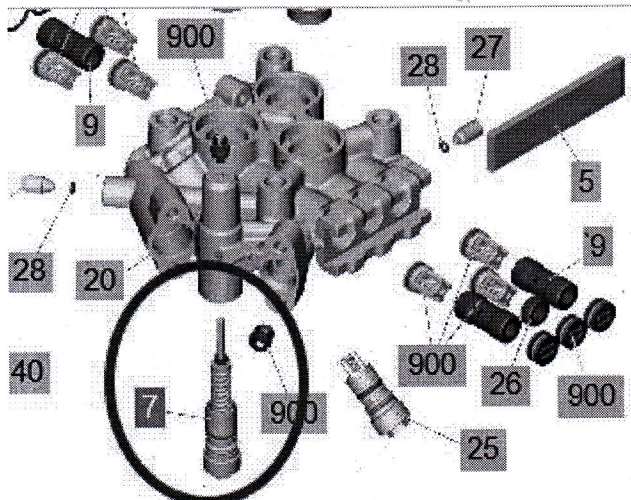

Fig. 1:

Pos. 7 Control piston
pressure switch new
4.580-104.3

2. Various HD-M units, Cage and ST (1.150- /1.151- /1.524-9xx.0)

Control piston pressure switch
(4.624-301.3 /-414.3 /-416.3)

Service Bulletin
No. 2021-011 dated 08/02/2021
Classification level III

Units	Old control piston	New control piston
HD 6/15 M, HD 7/17 M (1.150-9xx.0 /1.151- 9xx.0)	4.624-301.3	4.580-104.3
HD 6/14 M, HD 7/14 M (1.524-9xx.0)	4.624-416.3	4.580-104.3
HD 7/16 M, HD 8/18 M (1.524-9xx.0)	4.624-414.3	4.580-104.3

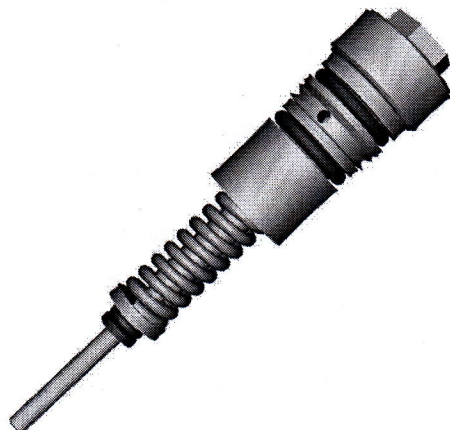

**Fig. 1: Control piston old,
12 mm Ø , with cylinder lining**

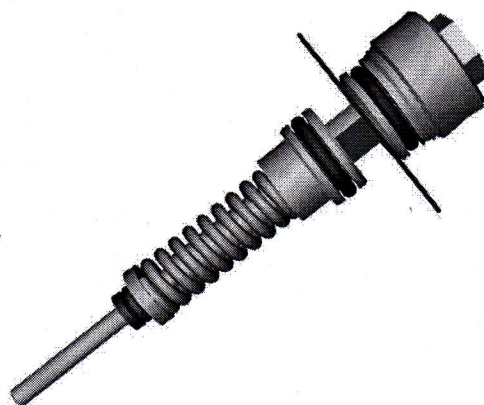

**Fig. 2: Control piston new,
14 mm Ø, without cylinder lining,
two-part**

Note:

Change / Improvement in production since: 31/07/2019

Unit:	Manufacture No.:	Serial No.:
HD 6/15 M	1.150-930.0	23499
HD 6/15 MX Plus	1.150-931.0	18401
HD 6/15 M Plus	1.150-932.0	18732
HD 6/15 M Plus	1.150-933.0	10384
HD 6/15 MX Plus	1.150-934.0	10524
HD 6/15 M	1.150-935.0	11462
HD 2.3/15 M Cage Ed	1.150-936.0	10006
HD 6/15 M Edition Power Control	1.150-937.0	10216

KÄRCHER

2. Various HD-M units, Cage and ST (1.150- /1.151- /1.524-9xx.0)

Control piston pressure switch
(4.624-301.3 /-414.3 /-416.3)

Service Bulletin

No. 2021-011 dated 08/02/2021

Classification level III

HD 6/15 MX Plus Loxam	1.150-938.0	11727
HD 3.0/20 M Cage Ea	1.150-939.0	10006
HD 6/15 M Plus	1.150-940.0	10126
HD 6/15 M	1.150-941.0	10000
HD 6/15 MXA Plus	1.150-943.0	10018
HD 6/15 MXA Plus	1.150-944.0	10072
HD 6/15 M	1.150-945.0	40000
HD 6/15 M St	1.150-950.0	10436
HD 6/15 M St	1.150-951.0	10116
HD 6/15 M Portable	1.150-952.0	10000
HD 6/15 M Cage	1.150-970.0	10256
HD 6/15 M Cage	1.150-971.0	10374
HD 7/17 M	1.151-930.0	11402
HD 7/17 MX Plus	1.151-931.0	11342
HD 7/17 M Plus	1.151-932.0	11112
HD 7/15 M	1.151-933.0	10102
HD 7/15 M	1.151-934.0	10102
HD 7/17 M	1.151-935.0	10048
HD 7/17 MXA Plus	1.151-936.0	10000
HD 7/17 M	1.151-941.0	10216
HD 7/17 M St	1.151-950.0	10576
HD 7/17 M Portable	1.151-951.0	10000
HD 7/17 M Cage	1.151-960.0	10100
HD 7/14-4 M	1.524-930.0	11778
HD 7/14-4 MX Plus	1.524-931.0	11182
HD 7/14-4 M Plus	1.524-932.0	10744
HD 6/16-4 M Plus	1.524-933.0	11385
HD 6/16-4 MX Plus	1.524-934.0	10835
HD 6/15-4 M Plus	1.524-935.0	10026
HD 7/12-4 M Plus	1.524-936.0	10483

KÄRCHER

2. Various HD-M units, Cage and ST (1.150- /1.151- /1.524-9xx.0)

Control piston pressure switch
(4.624-301.3 /-414.3 /-416.3)

Service Bulletin

No. 2021-011 dated 08/02/2021

Classification level III

HD 7/12-4 M ST	1.524-937.0	10144
HD 6/11-4 M Plus	1.524-938.0	10252
HD 6/11-4 M St	1.524-939.0	10178
HD 6/16-4 M Cage	1.524-940.0	10242
HD 7/13-4 M	1.524-941.0	10150
HD 7/14-4 M Cage	1.524-942.0	10268
HD 7/14-4M Plus	1.524-943.0	10194
HD 3.0/20-4 M Cage	1.524-944.0	10012
HD 6/16-4 MXA Plus	1.524-945.0	10000
HD 7/14-4 MXA Plus	1.524-947.0	10000
HD 7/12-4 M Cage	1.524-948.0	10000
HD 7/16-4 M	1.524-955.0	10637
HD 7/16-4 MX Plus	1.524-956.0	10286
HD 7/16-4 M Plus	1.524-957.0	10288
HD 7/16-4 MX Car	1.524-958.0	10384
HD 7/16-4 MXA Plus	1.524-959.0	10000
HD 7/16-4 M Cage	1.524-960.0	10172
HD 7/16-4 MXA Car	1.524-961.0	10060
HD 8/18-4 M	1.524-970.0	10670
HD 8/18-4 MX Plus	1.524-971.0	11127
HD 8/18-4 M Plus	1.524-972.0	10900
HD 8/18-4 MX Plus Farmer	1.524-973.0	11067
HD 8/18-4 M	1.524-975.0	10294
HD 8/18-4 MXA Plus	1.524-976.0	10099
HD 8/18-4 MXA Plus Farmer	1.524-977.0	10060
HD 8/18-4 M St	1.524-980.0	10504
HD 8/18-4 M Cage	1.524-981.0	10255
HD 8/18-4 M Cage Farmer	1.524-982.0	11955
HD 8/18-4 M St	1.524-983.0	10012
HD 8/16-4 M Cage	1.524-984.0	10078

KÄRCHER

**2. Various HD-M units,
Cage and ST (1.150-
/1.151- /1.524-9xx.0)**

**Control piston pressure switch
(4.624-301.3 /-414.3 /-416.3)**

Service Bulletin

No. 2021-011 dated 08/02/2021

Classification level III

HD 8/16-4 M Cage

1.524-985.0

10078

**Warranty
handling:**

Causing fault

4.624-301.3

Fault code

200

Valid until

30/09/2022