

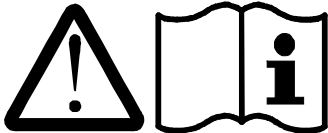

KÄRCHER

NT 65/2 Eco



www.karcher.com

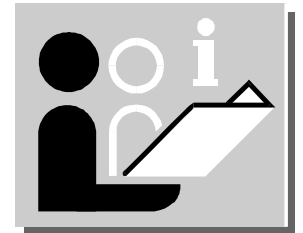

5.960-157 A2005229 07/03

NT 65/2 Eco



Inhaltsverzeichnis	DE	Seite
Inbetriebnahme		6
Betriebsanleitung		7
Kärcher-Niederlassungen		125
Technische Daten / Schaltplan / Ersatzteilliste		126/127/128
Zubehör / Filtersysteme		129/131

Vor erster Inbetriebnahme Betriebsanleitung und Sicherheitshinweise Nr. 5.956-249 unbedingt lesen! Dieses Gerät ist für den gewerblichen Gebrauch geeignet, z.B. in Hotels, Schulen, Krankenhäusern, Fabriken, Läden, Büros und Vermietergeschäften.

Lists of contents	EN	Page
Commissioning		6
Operating Instructions		12
Kärcher branches		125
Technical Data / Wiring diagram / Spare Parts List		126/127/128
Accessories / Filter systems		129/131

Prior to initial startup, operating manual and safety instructions no. 5.956-249 must be consulted! This machine is suitable for industrial use, for instance in hotels, schools, hospitals, factories, shops, offices and on hire.

Tables des matières	FR	Page
Mise en service		6
Notice d'instructions		17
Filiales Kärcher		125
Caractéristiques techniques / Schéma de câblage / Liste des pièces de rechange		126/127/128
Accessoires / Systèmes de filtres		129/131

Avant la première mise en service, lire absolument le mode d'emploi et les 5.956-249 remarques de sécurité! Cet appareil est adapté à l'usage professionnel, p. ex. dans les hôtels, les écoles, les hôpitaux, les usines, les magasins, les bureaux et les locations.

Indici	IT	Pagina
Messa in funzione		6
Istruzioni per l'uso		22
Filiali Kärcher		125
Dati tecnici / Schema elettrico / Elenco pezzi di ricambio		126/127/128
Accessori / Sistemi del filtro		129/131

Prima della prima messa in funzione leggere assolutamente le istruzioni per l'uso e le avvertenze per la sicurezza n. 5.956-249! Questo apparecchio è adatto per settori commerciali, per es. hotel, scuole, ospedali, fabbriche, negozi, uffici e noleggi.

Inhoudsopgave	NL	Pagina
Inbedrijfstelling		6
Gebruiksaanwijzing		27
Kärcher – filialen		125
Technische gegevens / Schakelschema / Reserveonderdelenlijst		126/127/128
Accessoires / Filtersystemen		129/131

**Vóór de eerste ingebruikneming de gebruiksaanwijzing en de veiligheidsinstructies nr.: 5.956-249 beslist lezen!
Dit apparaat is geschikt voor professioneel gebruik, bijv. in hotels, scholen, ziekenhuizen, winkels, kantoren en verhuurbedrijven.**

Índices	ES	Paginación
Puesta en servicio		6
Instrucciones de servicio		32
Filiales de Kärcher		125
Datos técnicos / Diagrama de conexiones / Lista de piezas de requesto		126/127/128
Accesorios / Sistemas de filtros		129/131

**Las instrucciones de servicio y las indicaciones de seguridad núm. 5.956-249 se deben leer imprescindiblemente antes de la primera puesta en servicio!
Este aparato es apropiado para el uso a escala industrial, p. ej. en hoteles, centros escolares, hospitales, fábricas, tiendas comerciales, oficinas y empresas dedicadas al alquiler.**

NT 65/2 Eco



Índices	PT	Página
Colocação em funcionamento		6
Manual de instruções		37
Filiais da Kärcher		125
Dados técnicos / Esquema de ligações / Lista de peças sobresselentes		126/127/128
Acessórios / Sistemas de Filtro		129/131

Antes da primeira colocação em funcionamento, ler atentamente. o manual de instruções e as indicações de segurança nº5.956-249!

Este aparelho destina-se ao uso industrial, nomeadamente em hotéis, escolas, hospitais, fábricas, lojas, escritórios e empresas de aluguer.

Πίνακες περιεχομένων	EL	σελίδα
Θέση σε λειτουργία		6
Οδηγίες λειτουργίας		42
Αντιπροσωπείες Kärcher		125
Τεχνικά χαρακτηριστικά/Κυκλωματικό διάγραμμα/ανταλλακτικά		126/127/128
εξαρτήματα / Συστήματα φίλτρων		129/131

Πριν από την πρώτη θέση λειτουργίας διαβάστε οπωσδήποτε τις Οδηγίες χρήσης και Υποδείξεις ασφάλειας. αρ. 5.956-249 !
Αυτή η συσκευή είναι κατάλληλη για την επαγγελματική χρήση, π.χ. σε ξενοδοχεία, σχολεία, νοσοκομεία, εργοστάσια, καταστήματα, γραφεία και εταιρείες δανεισμού συσκευών.

Indholdfortegnelser	DA	Side
Idrifttagning		6
Driftsvejledning		48
Kärcher agenturer		125
Tekniske data / Strømskema / Reservedelsliste		126/127/128
Tilbehør / Filtersystemer		129/131

Inden første idrifttagning skal driftsvejledningen og sikkerhedshenvisningerne nr. 5.956-249 læses!

Dette apparat er beregnet til erhvervsmæssig brug, f.eks. i hoteller, skoler, sygehuse, fabrikker, forretninger, kontorer og udlejningsforretninger.

Innholdsfortegnelser	NO	Side
Igangsetting		6
Bruksanvisning		53
Kärcher filialer		125
Tekniske data / Koplingskjema / Reservedelsliste		126/127/128
Tilbehør / Filtersystemer		129/131

Før første gangs bruk må bruksanvisning og sikkerhetsanvisning nr. 5.956-249 ubetinget leses!

Denne maskinen er egnet til bruk i næringslivet, f.eks. i hoteller, skoler, sykehus, fabrikker, butikker, kontorer og utleiebutikker.

Innehållsförteckningar	SV	Sid
Idrifttagning		6
Driftinstruktion		58
Kärcher filialer		125
Tekniska data / Kopplingschema / Reservdelslista		126/127/128
Tillbehör / Filtersystem		129/131

Läs noga instruktionsboken och säkerhetsanvisningarna

nr.: 5.956-249 innan aggregatet tas i bruk!

Denna apparat är lämplig för användning inom näringslivet, t.ex. hotell, skolor, sjukhus, fabriker, butiker, kontor och uthyrningsaffärer.

Sisällysluettelo	FI	Sivu
Käyttöönnotto		6
Käyttöohje		63
Kärcher-toimipisteet		125
Tekniset tiedot / Kytentäkaavio / Varaosalista		126/127/128
Lisävarusteet / Suodatinjärjestelmät		129/131

Ennen ensimmäistä käyttöönottoa on käyttöohje ja turvallisuusohjeet numero. 5.956-249 ehdottomasti luettava!

Tämä laite soveltuu ammattimaiseen käyttöön esim. hotelleissa, kouluissa, sairaaloissa, tehtaissa, myymälätiloissa, toimistoissa ja vuokrausliikkeissä.

NT 65/2 Eco



Tartalomjegyzék	HU	Oldal
Üzembevétele		6
Üzemeltetési utasítás		68
Kärcher telephelyek		125
Műszaki adatok / Kapcsolási rajz / Cserealkatrészlista		126/127/128
Kellékek / Szűrőrendszerek		129/131

Az első üzembevétele előtt Üzemeltetési utasítást és a számú biztonsági utalást. 5.956-249 feltétlenül elolvasni!

E készülék ipari célra készült, például szállodákban, iskolákban, kórházakban, gyárakban, raktárakban, irodákban és üzletekben használható.

Obsah	CS	Strana
Uvedení do provozu		6
Návod k obsluze		73
Zastoupení Kärcher		125
Technické údaje / Schéma zapojení / Seznam náhradních dílů		126/127/128
Príslušenství / Filtrační systémy		129/131

Před prvním uvedením do provozu si bezpodmínečně přečtěte návod k obsluze. a bezpečnostní upozornění č. 5.956-249!

Tento přístroj je vhodný pro komerční použití, např. v hotelech, školách, nemocnicích, továrnách, obchodech, kancelářích a půjčovnách.

Kazalo	SL	Stran
Zagon		6
Navodila za obratovanje		78
Kärcher-poslovalnice		125
Tehnični podatki / vezalni načrt / seznam nadomestnih delov		126/127/128
Oprema / Filtrirni sistemi		129/131

Pred prvim zagonom je potrebno prebrati navodila za obratovanje in varnostne napotke št. 5.956-249!

Ta naprava je primerna za gospodarsko rabo, npr. v hotelih, šolah, bolnišnicah, tovarnah, trgovinah, pisarnah in najemnih prostorih.

Spis treści	PL	Strona
Uruchomienie		6
Instrukcja obsługi		83
Filie firmy Kärcher		125
Dane techniczne / Schemat ideowy / Lista części zamiennych		126/127/128
Wyposażenie dodatkowe / systemy filtracyjne		129/131

Przed pierwszym uruchomieniem należy koniecznie przeczytać. Instrukcję obsługi i wskazówki dotyczące bezpieczeństwa nr 5.956-249! do zasysania substancji płynnych.

Urządzenie to przeznaczone jest do użytku przemysłowego, np. w hotelach, szkołach, szpitalach, fabrykach, sklepach, biurach i wypożyczalniach.

Cuprins	RO	Pagina
Luare în exploatare		6
Instrucțiunile de folosire		88
Sucursale Kärcher		125
Date tehnice / Planul de conexiuni / Listă de piese de schimb		126/127/128
Accesoriiile / Sisteme de filtrare		129/131

Înainte de prima luare în exploatare, instrucțiunile de folosire și indicațiile de siguranță nr. 5.956-249 trebuie citite neapărat!

Acest aparat este adecvat folosirii profesionale, de ex. în hoteluri, școli, spitale, fabrici, magazine, birouri și spații comerciale închiriate.

İçindekiler	TR	Sayfa
Servise koyma		6
Kullanma Kılavuzu		93
Kärcher Şubeleri		125
Teknik özellikler/Tevzi planı/Yedek parça listesi		126/127/128
Aksesuar/ Filtre Sistemleri		129/131

Cihazı ilk kez çalıştırmadan önce kullanım kılavuzu güvenli bilgilerini No. 5.956-249 mutlaka okuyun!

Bu cihaz ticari kullanım için uygundur; örn. otellerde, okullarda, hastanelerde, fabrikalarda, dükkanlarda, satış merkezlerinde, bürolarda ve kiralama işletmelerinde kullanılabilir.

Cihazın kullanım ömrü 10 yıldır.

NT 65/2 Eco



Содержание	RU	Страница
Ввод в эксплуатацию		6
Руководство по эксплуатации		98
филиалы фирмы Kärcher		125
Технические характеристики/Электрическая схема/запасные части	126/127/128	
Принадлежности / Фильтровальные системы		129/131

Перед первым пуском руководство по эксплуатации и указания по безопасности №. 5.956-249 следует обязательно прочитать!

Этот прибор предназначен для промышленного применения, например, в гостиницах, школах, больницах, фабриках, магазинах, бюро, арендных помещениях.

Zoznam	SK	Strana
Uvedenie do prevádzky		6
Návod k prevádzke		104
Zastúpenie Kärcher		125
Technické údaje / Schéma zapojenia / Zoznam náhradných dielov	126/127/128	
Príslušenstvo / Filtračné systémy		129/131

Pred prvým zapojením do prevádzky je bezpodmienečne nutné prečítať si Návod k prevádzke a Bezpečnostné pokyny č. 5.956-249. Tento prístroj je určený na použitie v nebytových priestoroch, napr. v hoteloch, školách, nemocniciach, továrňach, obchodoch, kanceláriách a je možné ho za týmto účelom prenajímať.

Sadržaj	HR	Stranica
Puštanje u rad		6
Upute za upotrebu		109
Kärcher-podružnice		125
Tehnički podaci / El. shema / Popis rezervnih dijelova	126/127/128	
Pribor / Filterski sistemi		129/131

Prije prvog puštanja u rad obavezno pročitati Upute za upotrebu i sigurnost pri radu br. 5.956-249! Ovaj uređaj je namijenjen za upotrebu u gospodarstvu, npr. u hotelima, školama, bolnicama, tvornicama, trgovinama, uredima i poslovnima iznajmljivanja.

Sadržaj	SR	Strana
Puštanje u pogon		6
Uputstvo za rukovanje		114
Kärcher-predstavništva		125
Tehnički podaci / Razvodni plan / Spisak rezervnih delova	126/127/128	
Dodatna oprema / Filterski sistemi		129/131

Pre prvog puštanja u pogon obavezno pročitati uputstvo za rukovanje i sigurnosne napomene br. 5.956-249!

Ovaj uređaj je prikladan za službenu upotrebu, na primer u hotelima, školama, bolnicama, fabrikama, prodavnicama, kancelarijama i iznajmljenim radnjama.

Съдържание	BG	Страница
Пускане в експлоатация		6
Упътване за работа		119
Kärcher-Филиал		125
Технически данни/Схема за включване/Списък на резервни части	126/127/128	
Спомагателни принадлежности/Филтърна система		129/131

Преди първото пускане в експлоатация прочетете непременно

Упътването за работа и указание за безопасност № 5.956-249!

Този уред е подходящ за промишлена употреба, напр. в хотели, училища, болници, предприятия, магазини, офиси и дейности с даване под наем.

NT 65/2 Eco

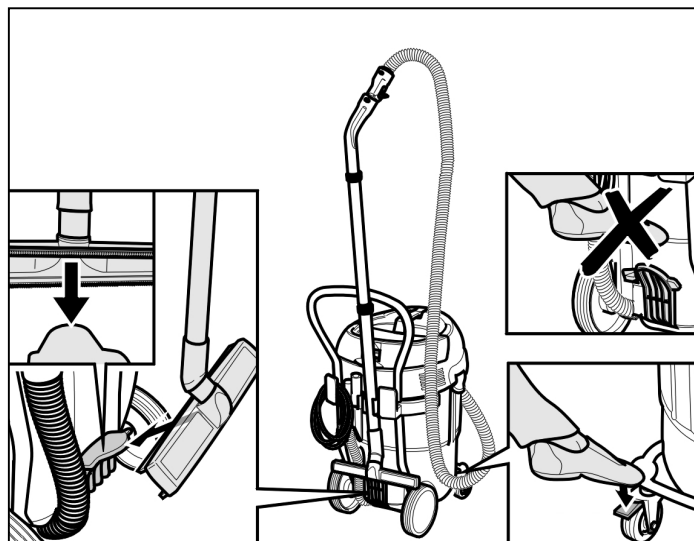
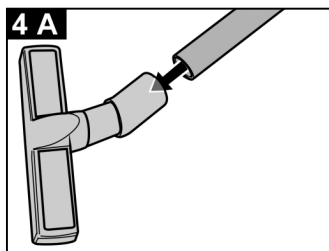
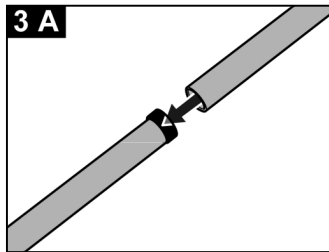
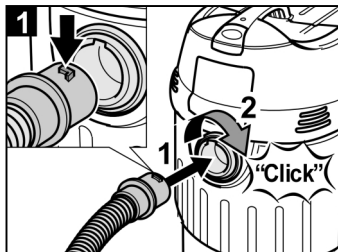
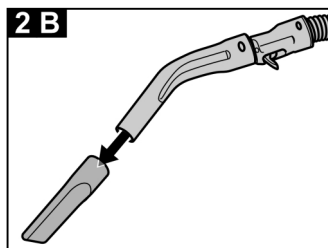
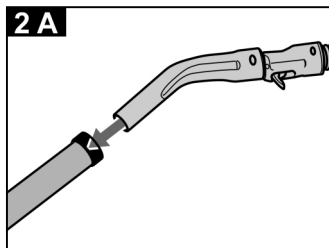
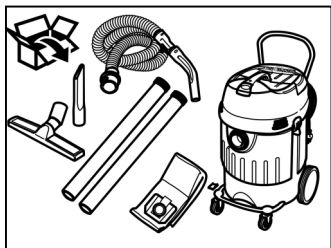

Important

Prior to initial operation of the unit we request you to carefully read the information given in the operating instructions.

Inform your dealer immediately of shipping damage.

Environmental protection

Items used when working, such as fuel, oil, cleaning agent and contaminated maintenance materials, are to be deposited at a special collection point.



Packaging materials, metal and plastic containers are to be set aside for recycling as appropriate.

Disposal of used units

Your Kärcher retailer will provide you with information on disposal means harmless to the environment.

Intended use

- This vacuum cleaner is a cleaning unit for industrial applications.
- The unit is designed for wet and dry cleaning of floors and walls in the home, in business and industrial premises in accordance with these operating instructions.
- When the unit is used it is not permissible for the ambient temperature to exceed 40°C.

Dry suction



Warning!

During vacuuming it is not permitted to ever remove the flat pleated filter.

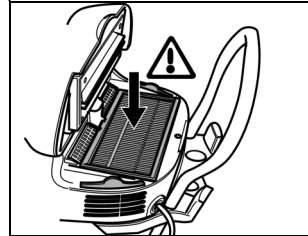

A paper filter bag or a diaphragm filter (special accessories) can additionally be used to vacuum fine dust.

Fitting the paper filter bag

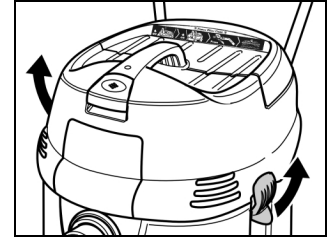

- Unlock and remove the suction head

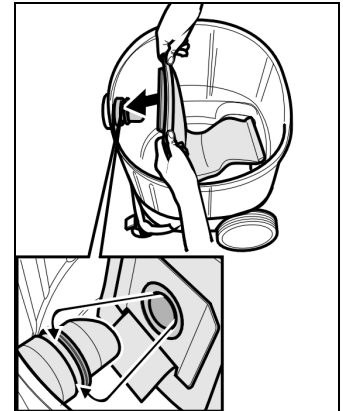

- Attach the paper filter bag

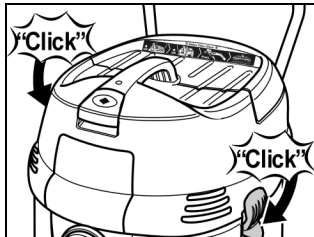

- Replace the suction head and lock it in place

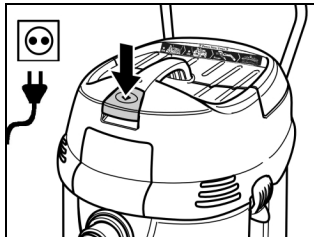

- Insert power plug
- Switch on the machine and start using it

Filter de-duster

Power Filter Clean

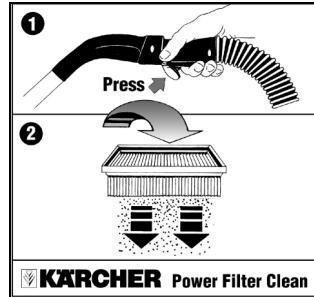

Your vacuum cleaner is provided with a new type of filter cleaner – especially effective for fine dust.

The flat pleated filter is automatically cleaned by an air blast if you press the push button at the handle for approx. 5 to 10 seconds (pulsating sound) Prior to that the Power Filter Clean must be activated.

To activate Power Filter Clean Slider (1) position - down

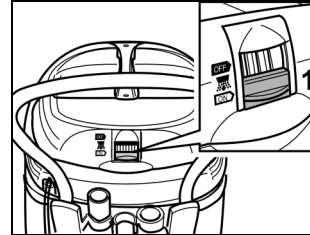

Note:

Actuating the push button at the handle every 5 to 10 minutes increases the filter service life.

To deactivate Power Filter Clean Slider (1) position - up.

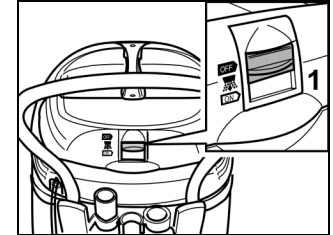

Note:

For vacuuming with the upholstery or crevice nozzle or for predominantly sucking up water.

Wet-vacuuuming

- Remove the paper filter bag

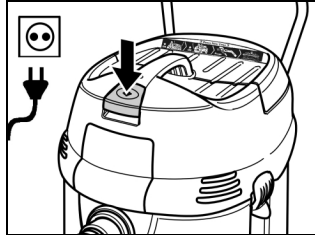

- Insert power plug
- To deactivate Power Filter Clean
- Switch on the machine and start using it

To deactivate Power Filter Clean
Slider (1) position - up.

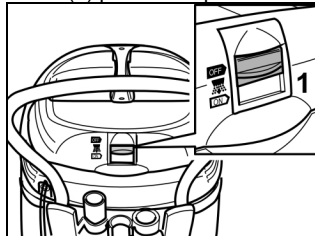

Note:

- It is advisable to deactivate the - Power Filter Clean - function when vacuuming with the upholstery or crevice nozzle or if predominantly water is to be sucked out of a container.

Upon reaching the maximum liquid level the unit automatically turns itself off.

- Switch the appliance off and empty the container.

Automatic shutoff is reset by turning off the unit.

- Clean and dry the flat pleat filter and the electrodes as well as the container after finishing wet vacuuming jobs.

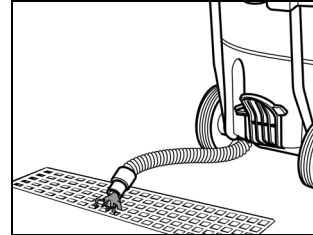

- Drain dirty water using the drain (not provided for all units)



Warning!

- During vacuuming it is not permitted to ever remove the flat pleated filter.
- The paper filter bag and the membrane filter (optional accessories) respectively must always be removed for vacuuming wet dirt. The use of a special filter bag (wet type) is recommended (see filter systems).
- The unit does not switch off when the container is full when non-conductive liquids (e.g. drilling emulsion, oils and greases) are vacuumed. The fill level must be regularly checked and the container emptied before it is too full.
- On request, the unit can be retrofitted by maintenance service with a shutoff for dielectric liquids.

Care and maintenance



Danger!

Always pull out the mains plug when working on the suction machine.

Replacing the flat pleated filter or the exhaust air filter

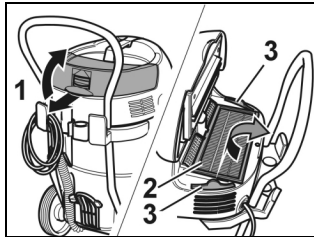

- Open the filter cover (1)
- Replace the flat pleated filter (2) or the exhaust air filter (3)
- Close the filter cover, it must engage audibly

Clean electrodes

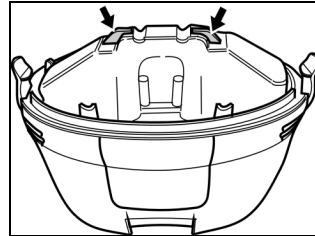

- Unlock and remove the suction head
- Clean electrodes
- Replace the suction head and lock it in place

Fault instructions

The suction turbine does not run

- Check the cable, plug, fuse and socket.
- Switch on the machine.

The suction turbine switches off

- Empty the container.

The suction turbine does not restart following emptying of the container

- Switch the appliance off and wait for 5 s, switch it on again after 5 s.
- Clean the electrodes as well as the space between them.

The suction power decreases

- Remove the parts clogging up the suction nozzle, the suction tube, the Power Filter Clean handle, the suction hose or the flat pleat filter.
- Change the paper filter bag.
- Actuate the filter cleaner: Power Filter Clean several times at the handle.
- Engage the filter cover properly.

- Replace the flat pleat filter.
- Check drain hose for leaks (if provided).

Dust ejects when sucking

- Check the proper mounting position of the flat pleat filter.
- Replace the flat pleat filter.

The (wet-vacuuming) automatic switch-off does not respond

- Clean the electrodes as well as the space between them.
- Constantly check fill level when vacuuming electrically non-conductive liquids.

Power Filter Clean switches regularly

- Detach blocked suction nozzle or end of hose.
- Stop continuous vacuuming from liquid tank or deactivate the Power Filter Clean function (see chapter on wet-vacuuming).
- Remove the parts clogging up the suction nozzle, the suction tube, the Power Filter Clean handle, the suction hose or the flat pleat filter.
- Replace the flat pleat filter.

NT 65/2 Eco

AT

Alfred Kärcher Ges. m.b.H.
Lichtblaustraße 7
A-1220 Wien

AU

Kärcher (Pty.) Ltd.
2/158 Browns Road
Noble Park 3174
Melbourne, Vict.

BE, LU, NL

Kärcher Benelux
Industrieweg 12
2320 Hoogstraden

BR

Kärcher Indústria e Comércio Ltda.
Av. Prof. Benedicto Montenegro

n°419

Paulinia – Estado de Sao Paulo
CEP 13.140-000

CA

Kärcher Cleaning Systems Inc.
1770 Alstep Drive
Mississauga, Ontario L5S1W1

CH

Kärcher Variorapid AG
Industriestr. 16
CH - 8101 Dällikon

CZ

Kärcher spol. S. r. a.
Za Mototschnou
155 00 Praha – Stodůlky

DE

**Alfred Kärcher GmbH & Co
Vertrieb Deutschland
Friedrich - List - Straße 4
D - 71364 Winnenden**

DK

Kärcher A/S
Gejhavegaard 5
DK – 6000 Kolding

ES

Kärcher S.A.
Pol. Industrial Font del Radium
Calle Doctor Trueta 6-7
E - 08400 Granollers (Barcelona)

FR

Kärcher S.A.
Z.A. des Petits Carreaux
5, avenue des Coquelicots
F - 94865 Bonneuil s. Marne/CEDEX

FI

Kärcher Oy
Yrittäjätie 17
FIN - 01800 Klaukkala

GB

Kärcher (U.K.) Ltd.
Kärcher House
Beaumont Road
Banbury Oxon, OX 16 7TB

GR

Kärcher S.A.
Cleaning Systems
99 Aristoutelous & Ioanninon
GR - 136 71 Aharnes

HU

Kärcher Hungaria Kft.
H-2051 Biatorbagy (Vendelpark)
Tormasret ut 2

HK

Kärcher Ltd.
Unit 10, 17/FL. APEC Plaza
49 Hoi Yuen Road
Kwun Tong, Kowloon

IT

Kärcher S.p.A.
Via Elvetia 4
I - 25050 Cantello (VA)

JP

Kärcher (Japan) Co., Ltd.
Irene Kärcher Building
No. 2, Matsusaka-Daira 3-chome
Taiwa-cho, Kurokawa-gun
Miyagi, 981-34, Japan

NO

Kärcher A/S
Gjerdrumsvei 4
Postboks 94, Grefsen
N - 0409 Oslo

PT

Neoparts
Comercio e Indústria Automóvel, Lda
Largo Vitorino Damásio. 10
1200 Lisabon

PL

Kärcher Poland Ltd.
Sp. zo. o.
Ul. Godlewskiego 22
30-198 Kraków

SE

Kärcher AB
Box 24
S - 42502 Hisings - Kärra

USA

Alfred Kärcher Inc.
P.O. Box 6510
1600 Cottontail Lane
Somerset, NJ 08875

ZA

Kärcher (Pty.) Ltd.
P.O. Box 2417
Kempton Park 1620

NT 65/2 Eco

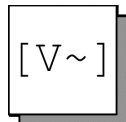

EUR; CH: 230 V/1~50/60 Hz

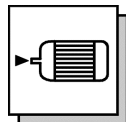

EUR:
P max: 2760 W
P nom: 2400 W



EUR:
CH: max. 235 mbar
max 208 mbar

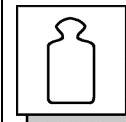

ohne Zubehör
without accessories
sans accessoires 19 kg



10,0 m

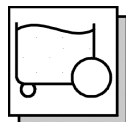

65 l

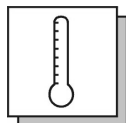

Umgebungs-
temperatur max. 40 °C
Ambient temperature
Température ambiante

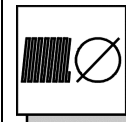

40 mm

H07RN - F2 x 1,5 mm²

EUR: 6.648 - 777
CH: 6.648 - 896

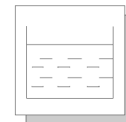

50 l

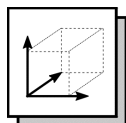

600 mm x 480 mm x 920 mm

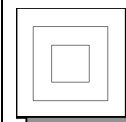

II



74 dB (A)

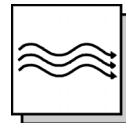





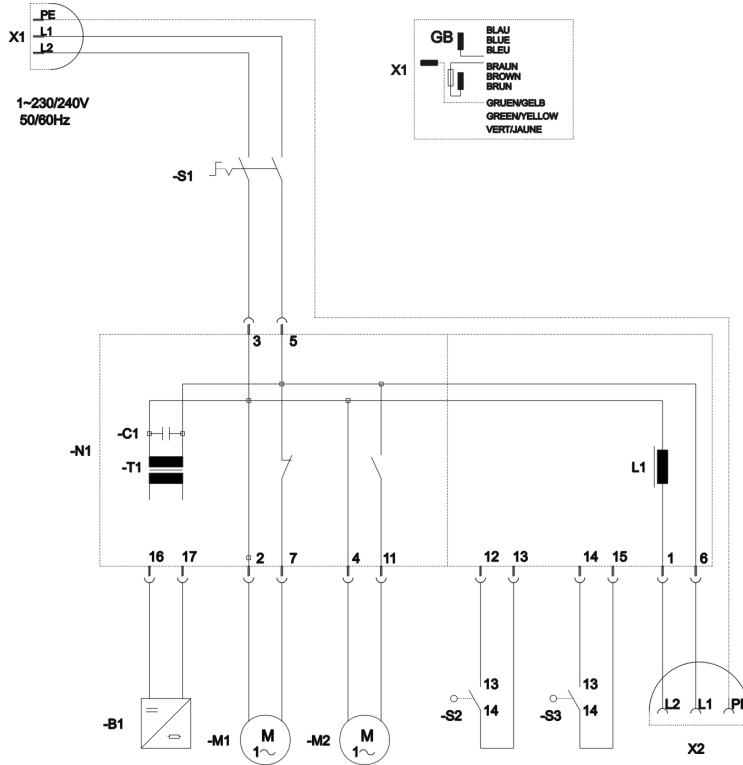



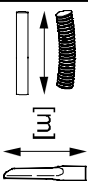
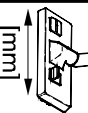

max. 2 x 56 l/s

NT 65/2 Eco

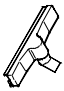

B1	Elektroden Electrodes Interrupteur avancement	X2	Steckdose (Nur TE Version) Socket (Only TE Version) Prise de courant (Seulement Version TE)
C1	Entstörkondensator Interference capacitor Condensateur antiparasites	S2	Umschalter-Betriebsart Druckluft (Nur TE Version) Change over switch operating mode compressed air (Only TE Version) Mode d'exploitation de commutateur d'air comprimé (Seulement Version TE)
L1	Wandler (Nur TE-Version) Converter (Only TE Version) Convertisseur (Seulement Version TE)	S3	Umschalter-Betriebsart Elektronikwerkzeug (Nur TE Version) Change over switch operating mode electric power tool (Only TE Version) Mode d'exploitation de commutateur outil électrique (Seulement Version TE)
M1,M2	Saugturbine Suction turbine Turbine d'aspiration	T1	Transformator Transformer Transformateur
N1	Schaltelektronik Switch-Electronic Interrupteur de électronique		
S1	Hauptschalter Mainswitch Interrupteur général		
X1	Netzstecker Power Supply Alimentation électronique		

		4.440-679 K 4.440-728 K / EL	CDN 40 CDN 40		4,0 4,0	
	4.060-474 K 4.060-533 K / EL	C 40 C 40				
	6.906-321 K 6.906-279 K	C 40 C 40		4,0 10,0		
	6.906-344 K	C 40	2,5			
	5.407-109 K / EL 5.407-111 K / EL	C 40->DN 35 C 40->DN 40				
	5.407-113 K / EL	C 40->C 35				
	5.031-904 K 5.032-427 K / EL	DN 40 DN 40				
	6.902-081 M	DN 40	0,5			
	6.906-531 M	DN 40	1,0			
	6.906-554 K 6.903-018 M 6.903-051 M	DN 40 DN 40 DN 40			360 370 450	

EL = elektrisch leitend
electrical conductive
conducteur électrique

K = Kunststoff
Plastic
Plastique







C = Clip-Verbindung
Clip connection
Connexion de clip

OL = ölbeständig
oil resistant
résistant à l'huile

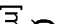
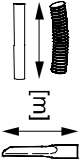
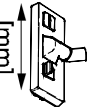
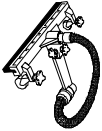



M = Metall
Metal
Métal

G = Gummi
Rubber
Caoutchouc

DN = Konus-Verbindung
Cone connection
Connexion de cône

		 [mm]	 [mm]	 [mm]
	DN 40	DN 40		
	6.903-033 K 6.905-817 M	DN 40 DN 40	0,30 0,40	
	6.902-105 G / OL	DN 40	0,20	
	2.637-217 K	DN 40		
<p>UBS nicht leitende Flüssigkeiten Dielectric media conversion kit UBS fluides non conducteurs</p>				
	6.905-877 G 6.903-062 G 6.903-081 OL 6.903-063 G 6.906-146 OL	360 370 370 450 450	360 370 370 450 450	
	6.905-878 K 6.904-064 K 6.904-065 K		360 370 450	
<p>EL = elektrisch leitend electrical conductive conducteur électrique</p> <p>M = Metall Metal Métal</p>	<p>K = Kunststoff Plastic Plastique</p> <p>G = Gummi Rubber Caoutchouc</p>	<p>C = Clip-Verbindung Clip connection Connexion de clip</p> <p>DN = Konus-Verbindung Cone connection Connexion de cône</p>	<p>OL = ölbeständig oil resistant résistant à l'huile</p>	

Filtersysteme / Filter Systems / Système de filtres **NT 65/2 Eco**

* BIA C geprüft; Rückhaltevermögen ≥ 99,9 % * BIA C approved; Retention ≥ 99,9 % * Contrôle BIA C; Conservation ≥ 99,9 %		Bestell-Nr. Order No. Numéro de référence		Menge Quantity Quantité	Normalstäube Normal dust Poussières normales	Feinstäube Fine dust Poussières fines	Abrasive Stäube Abrasive dust Poussières abrasives	Flüssigkeiten / nasser Schmutz Liquides / wet dirt Liquides / saletés humides
		NT 65/2 Eco	NT 65/2 Eco Tc NT 72/2 Eco Tc					
	Flachfilter * Flat pleated filter * Filtre plat à plis *	6.904-283	6.904-284	1	X	X	X	
	Papierfiltertüte, reißfest 3-lagig * Paper filter bag, tenacious three-fold * Sachet filtre à 3 épaisseurs, résistant à la rupture *	6.904-285	6.904-285	5	X	X	X	
	Membranfilter Diaphragm filter Filtre à membrane	6.904-282	6.904-282	1	X	X	X	
	Spezialfiltertüte / nass Special filter bag / wet Sachet filtre spécial / mouillé	6.904-252	6.904-252	5			X	X
	Flachfilter * (PES) Flat pleated filter * (PES) Filtre plat à plis * (PES)	6.904-284	6.904-284	1				X