

# 80 Reversing rolling mill

Professional \ Sweepers \ Walk behind \ Electric motor \ KM 100/40 W \ Spare parts list KM 100/40 W \ Reversing rolling mill

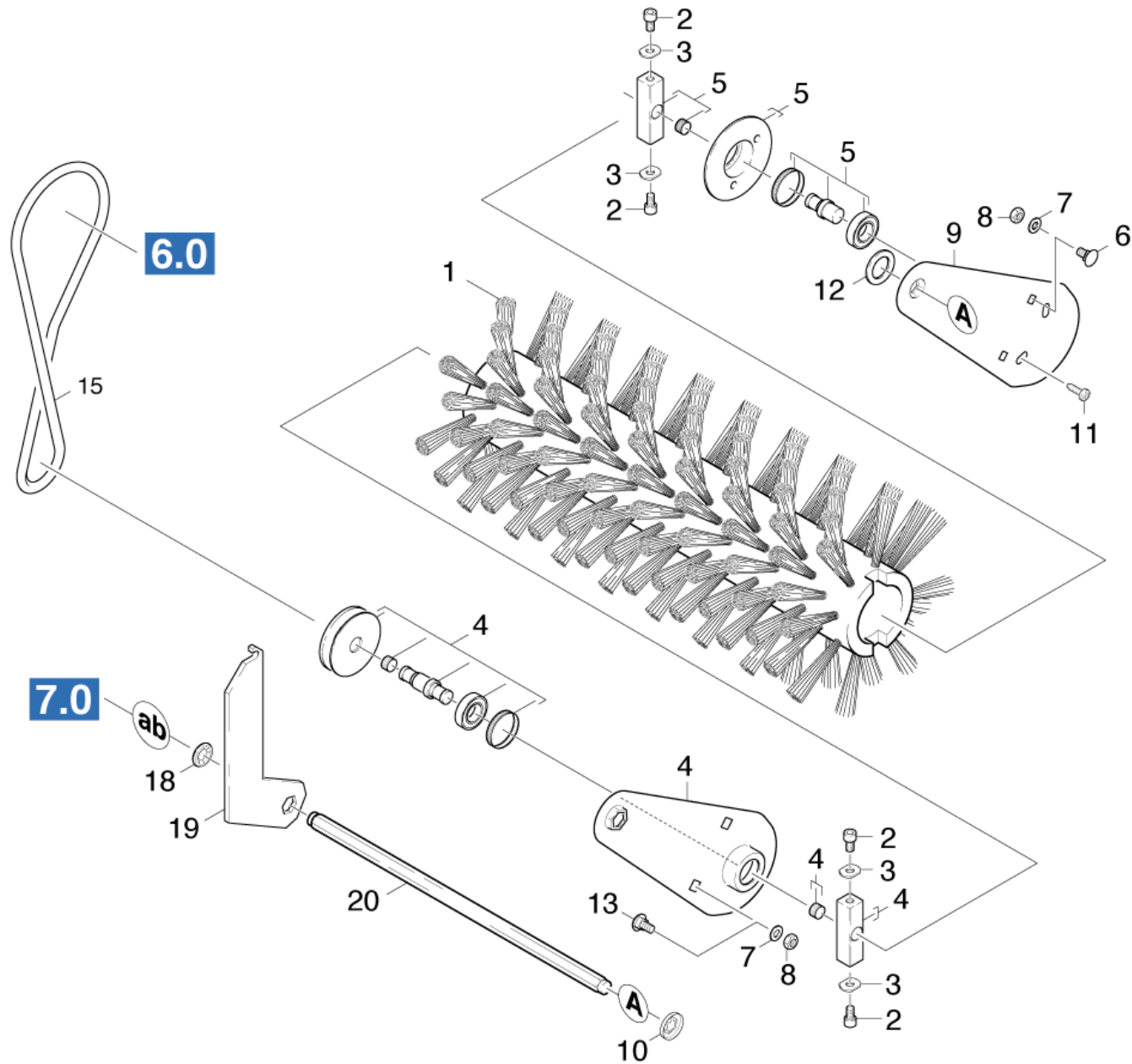

## 80 Reversing rolling mill

Professional \ Sweepers \ Walk behind \ Electric motor \ KM 100/40 W \ Spare parts list KM 100/40 W \ Reversing rolling mill

**KÄRCHER**

POS	Article no.	Description	Quantity	Unit
2	7.306-041.0	Cylinder head screw M8x20 -8.8-A2E ISO	4	PC
8	7.311-427.0	Hexagon nut M8-04-A2E DIN 985	4	PC
10	6.343-175.0	Quick-fastener	1	PC
18	6.343-202.0	Quick-fastener	1	PC
1	6.905-868.0	Reversing rolling mill hard -550 BREIT	1	PC
1	6.905-587.0	Reversing rolling mill middle	1	PC
1	6.905-870.0	Reversing rolling mill soft nature 550mm	1	PC
15	6.348-283.0	Round belt D10	1	PC
13	7.303-193.0	Saucer-head screw M8x16 -4.6-A0P DIN 603	2	PC
6	7.303-204.0	Saucer-head screw M8x20 -4.8-ZNBHL DIN 603	2	PC
11	7.303-068.0	Screw M8x20 -St-R3R (In6Rd)	2	PC
3	5.047-121.0	Sheet metal component retainer reversing	4	PC
4	7.777-999.0	Stockpiling discontinued	1	PC
5	7.777-999.0	Stockpiling discontinued	1	PC
9	7.777-999.0	Stockpiling discontinued	1	PC
19	7.777-999.0	Stockpiling discontinued	1	PC
20	7.777-999.0	Stockpiling discontinued	1	PC
12	6.312-069.0	Washer	1	PC
7	7.312-277.0	Washer 8-200HV-A2E ISO 7093-1	4	PC