

# 40 Carriage complete

Professional \ Floor cleaner \ Compact \ BR 45/22 C \*EU \ Brush-head complete \ Carriage complete

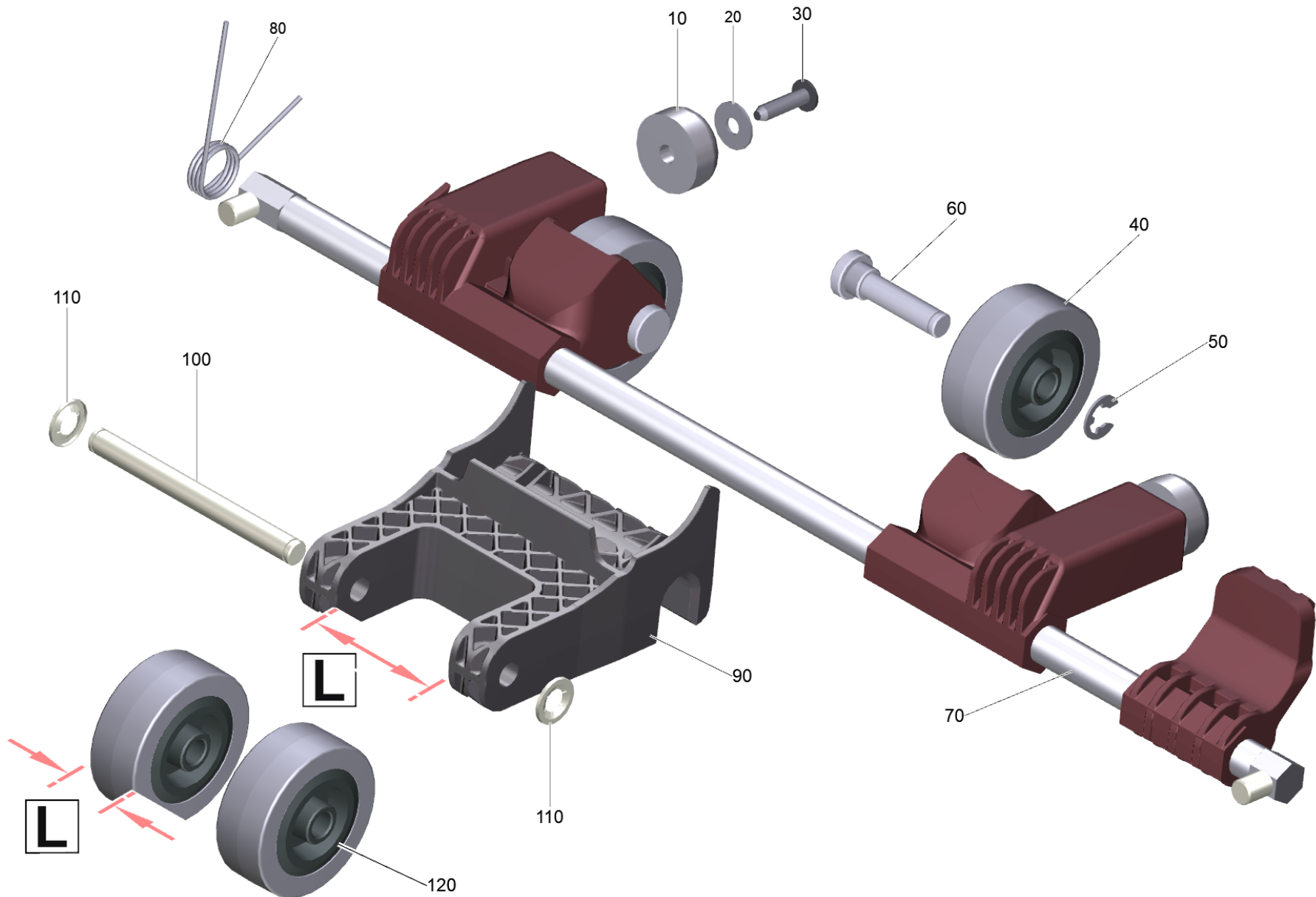

## 40 Carriage complete

Professional \ Floor cleaner \ Compact \ BR 45/22 C \*EU \ Brush-head complete \ Carriage complete

**KÄRCHER**

POS	Article no.	Description	Quantity	Unit	Remark
100	5.037-426.0	Axle transport wheel	1.000	ST	
60	5.037-314.0	Axle wheel height adjustment	2.000	ST	
80	5.037-346.0	Leg spring	1.000	ST	
90	5.037-428.0	Lever transport	1.000	ST	L=47,2mm
110	6.343-119.0	Lock washer	2.000	ST	
50	7.343-300.0	Lock washer 7-A2 DIN 6799	2.000	ST	
70	5.037-410.0	Retaining bracket contact pressure	1.000	ST	
30	7.303-212.0	Screw 5x20 -A2-70 (In6Rd)	2.000	ST	
120	4.037-121.0	Set holder rollers only for replacement	1.000	ST	L=22,5mm
90	4.037-121.0	Set holder rollers only for replacement	1.000	ST	L=46mm
10	5.031-519.0	Stand foot	2.000	ST	
20	7.312-278.0	Washer 5-200HV-A2E ISO7093-1	2.000	ST	
120	6.435-211.0	Wheel D 50mm (Fa. Blickle)	2.000	ST	L=23,3mm
40	6.435-309.0	Wheel oil resistant D50	2.000	ST	