

New Unit Information



BDS 43/150 C BDS 43/150 C

1.291-202

1.291-203

BDP 43/410 C

1.291-204

Configuration for all 3 variants:

- Robust planetary gears.
- High torque for high performance.
- Very quiet.
- Cable storage on the unit.

BDS 43/150 C, BDP 1.291/-202 C**Unit specifications:**

- Working width 430 mm
- Speed 150 rpm
- Mains voltage 220-240 V / 50 Hz / 1 Ph
- Motor rating 1000 W

BDS 43/150 C, 1.291-203**Unit specifications:**

- Working width 430 mm
- Speed 150 rpm
- Mains voltage 120 V / 60 Hz / 1 Ph
- Motor rating 1000 W

BDS 43/410 C, 1.291-204**Unit specifications:**

- Working width 430 mm
- Speed 410 rpm
- Mains voltage 220-240 V / 50 Hz / 1 Ph
- Motor rating 1300 W

View from the front

- 1 Unlock unit switch
- 2 Guide handle
- 3 Unlock lever inclination adjustment
- 4 Upper bracket for cleaning agent tank
- 5 Guide rod
- 6 Lower bracket for cleaning agent tank and cable hanging hook
- 7 Power supply cable - brush motor
- 8 Motor cover
- 9 Transport wheel (2x)
- 10 Mains cable

View from the front with cleaning agent tank/suction unit (option)



- 1 Upper suction hose
- 2 Suction unit
- 3 Suction hose (2x)
- 4 Suction ring
- 5 Cleaning agent supply hose
- 6 Tank inlet for cleaning agent
- 7 Cleaning agent tank
- 8 Handle, valve opening lever for cleaning agent inlet

Guide handle (view from the front)

- 1 Unlock, unit switch
- 2 Lever, unit OFF/ON switch
- 3 Unlock lever inclination adjustment
- 4 Retaining screws for cover
- 5 Plug socket for suction unit (view from rear)

Guide handle open

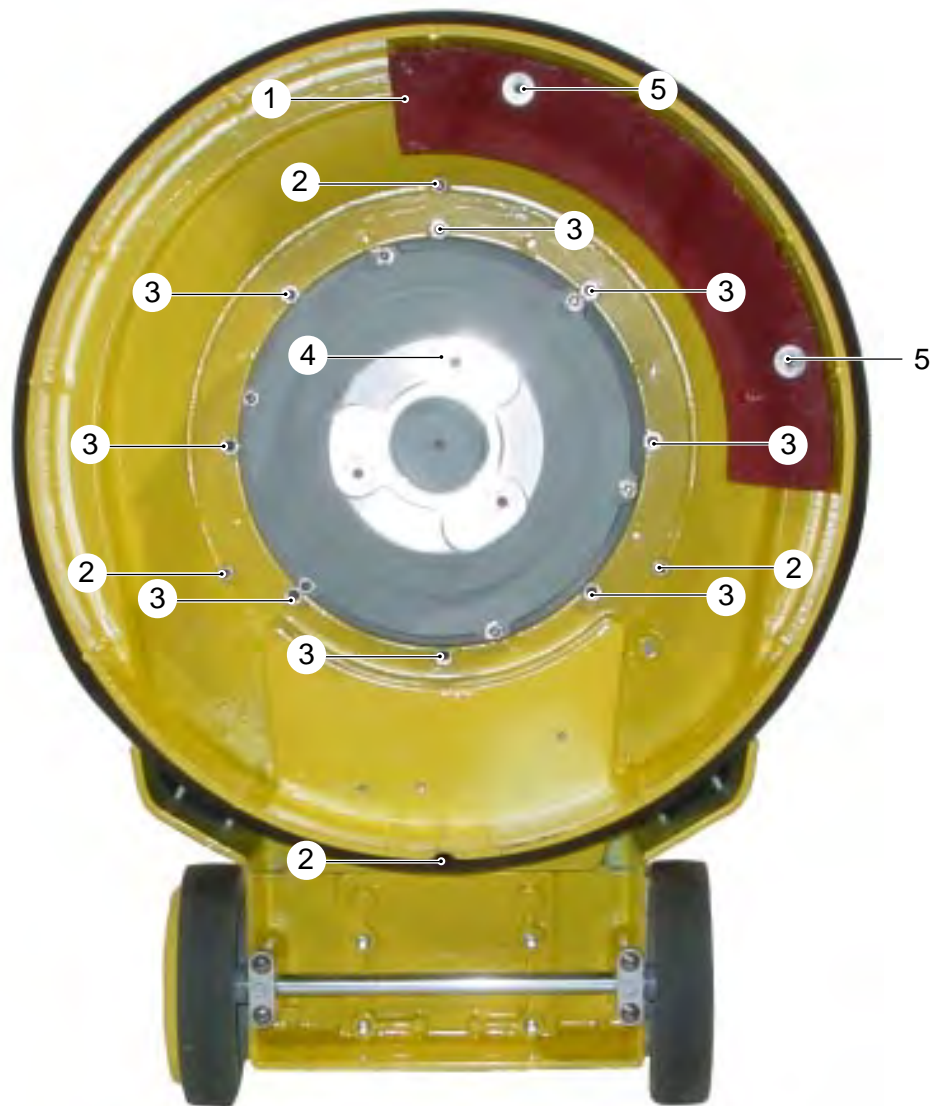

- 1 Unlock, unit switch
- 2 Lever, unit OFF/ON switch
- 3 Unit switch
- 4 Unlock lever inclination adjustment

View from underneath (without disc brush)

- 1 Counterweight
- 2 Retaining screws for motor cover (4x)
- 3 Retaining screws for motor (8x)
- 4 Disc brush attachment
- 5 Retaining screws for counterweight

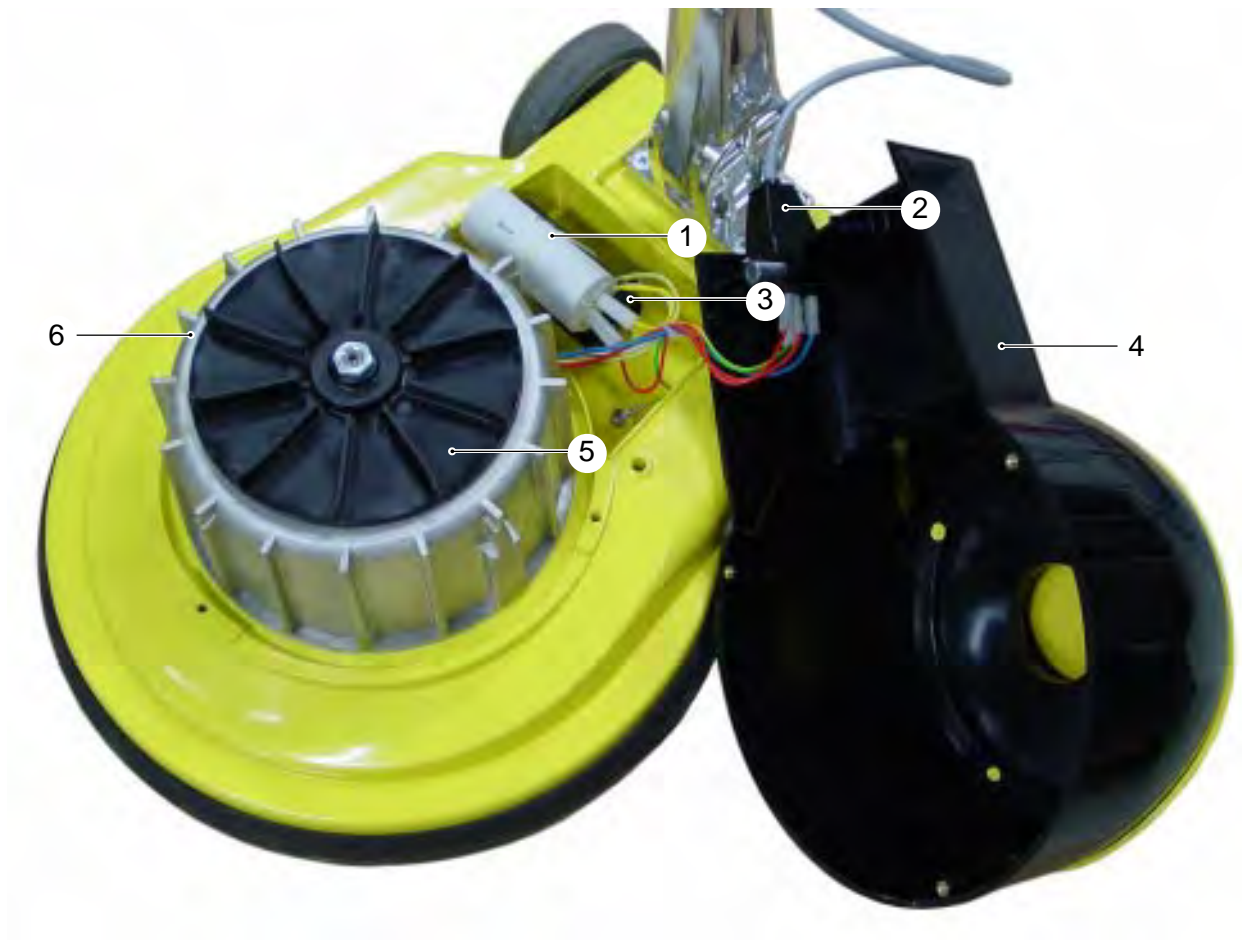
Motor cover removed

- 1 Operating capacitor
- 2 Connecting plug
- 3 Starting capacitor
- 4 Motor cover
- 5 Fan wheel
- 6 Drive motor

Remove motor cover

- Remove the retaining screws (Item 2, page 7) of the motor cover (4) and lift off the motor cover.

Motor dismantled

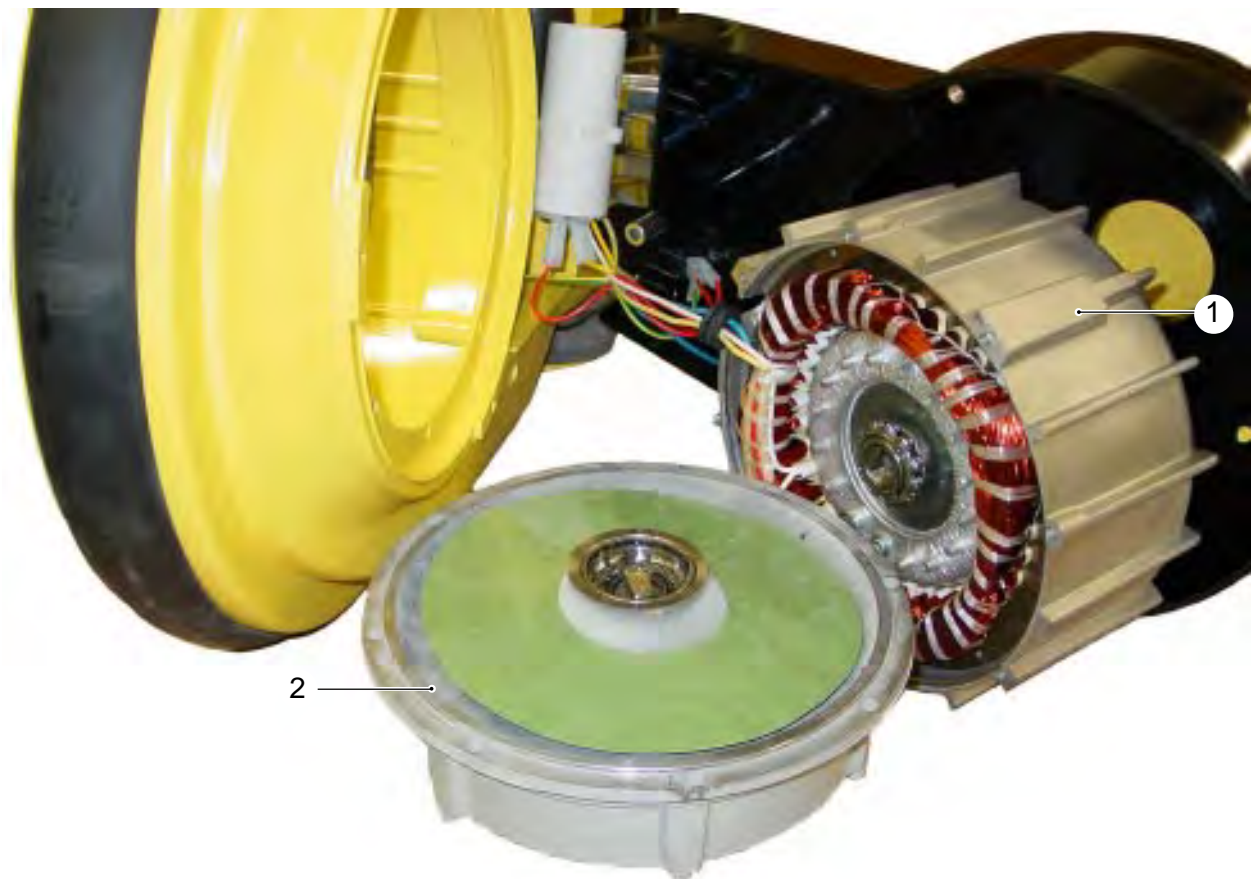

- 1 Motor
- 2 Planetary gear

Disassemble motor and planetary gear

- Remove retaining screws (Item 3, page 7) of the motor (1) and separate the motor from the planetary gear (2).

Note:

The planetary gear assembly is exchanged as a complete unit.

Troubleshooting

Fault	Solution
Poor cleaning result	<ul style="list-style-type: none">– Check pad/brush for wear and replace if necessary.– Remove foreign particles/objects from the pad/brush.– Check the pad/brush for intended application.
Disc won't turn	<ul style="list-style-type: none">– Remove foreign particles/objects from the pad/brush.– Check/replace unit switch.– Check/replace capacitors.– Check/replace motor.– Check/replace gears.– Replace pad (clogged).
Unit runs erratically	<ul style="list-style-type: none">– Pad out of round, replace.– Centre the pad.

Technical specifications

Unit Type	Unit No.	Circuit diagram	Operating instructions	Spare parts list
BDS 43/150 C (220-240 Volt)	1.291-202	0.088-647	5.960-959	5.970-206
BDS 43/150 C (120 Volt)	1.291-203	0.088-648	5.960-959	5.970-206
BDP 43/410 C (220-240 Volt)	1.291-204	0.088-649	5.960-959	5.970-206

The technical data sheet and the circuit diagram will be included in the next issue of the spare parts CD-ROM (DISIS) and are available in the Intranet.

Technical data sheet: Folder: „Central / Service Info Int'l / Technical Specifications“

Circuit diagram: Folder: „Central / Service Info Int'l / Circuit Diagram“

If required, the operating instructions and the spare parts lists can be ordered as a paper copy from the spare parts service by quoting the relevant part number.

Special tools

No special tools are required.

Tightening torque

No details.