

# 23 Cylinder head

Professional \ High pressure cleaner hotwater \ Electric motor \ HDS 895 S \*EU \ Spare parts list HDS 895 S \*EUR \ Pump set \ Cylinder head

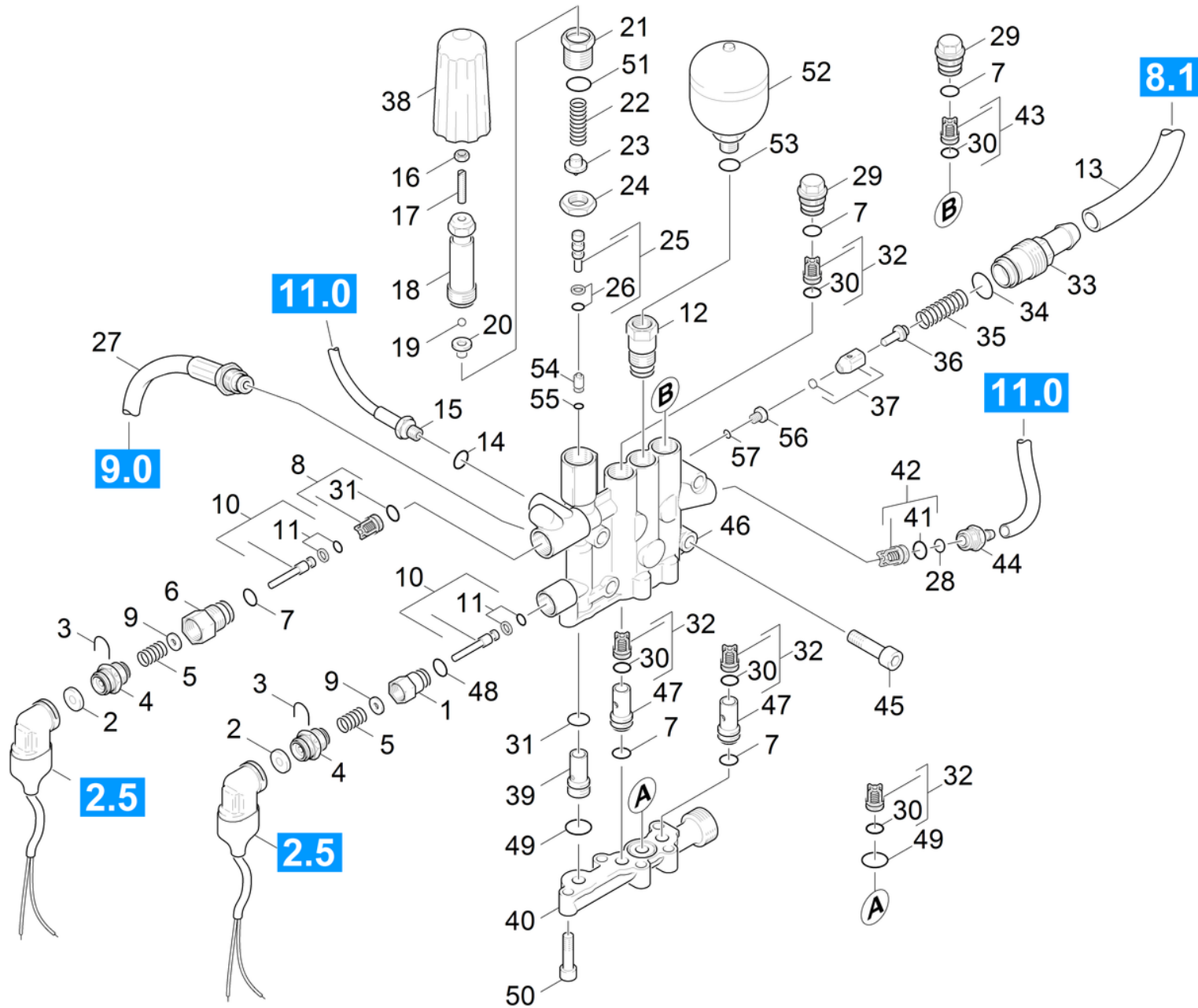

## 23 Cylinder head

Professional \ High pressure cleaner hotwater \ Electric motor \ HDS 895 S \*EU \ Spare parts list HDS 895 S \*EUR \ Pump set \ Cylinder head



POS	Article no.	Description	Quantity	Unit	Foot note text
46	4.550-535.0	Cylinder head complete only for replacem	1.000	ST	
50	7.306-043.0	Cylinder head screw M8x30 -8.8-A2E ISO	5.000	ST	
45	7.306-155.0	Cylinder head screw M12x100 -8.8-A3E IS	4.000	ST	
2	5.367-030.0	Diaphragm	2.000	ST	
38	5.321-579.0	Handle	1.000	ST	
5	5.332-268.0	Helical spring	2.000	ST	
22	5.332-444.0	Helical spring	1.000	ST	
35	5.332-473.0	Helical spring	1.000	ST	
18	5.304-070.0	Hexagonal head screw	1.000	ST	
16	7.311-002.0	Hexagon nut M5 -8-A2E ISO 4032	1.000	ST	
24	5.311-204.0	Hexagon nut M22x1,5	1.000	ST	
27	6.391-596.0	High pressure hose DN 13	1.000	ST	
15	6.389-635.0	High pressure hose pressure gauge	1.000	ST	
21	5.404-082.0	Hollow screw	1.000	ST	
13	6.388-167.0	Hose DN15	1.000	M	TO ORDER AS CUT GOODS
44	5.443-474.0	Hose stem	1.000	ST	
1	5.402-705.3	Joining piece	1.000	ST	
14	7.362-003.0	Joint ring A10x13,5 -Cu DIN 7603	1.000	ST	
53	7.362-005.0	Joint ring A14x18 -Cu DIN 7603	1.000	ST	
28	6.362-151.0	O-Ring d. 10 x 2 NBR 70	1.000	ST	
48	6.362-853.0	O-Ring seal 4,47x1,78	1.000	ST	
55	6.362-386.0	O-Ring seal 5,0 x 1,5-NBR 80	1.000	ST	
57	6.362-703.0	O-Ring seal 6,0x1,5-NBR 70	1.000	ST	
41	6.362-077.0	O-Ring seal 10 x 2,2 NBR 70	1.000	ST	
34	6.362-169.0	O-Ring seal 12,0 X 2,0	1.000	ST	
30	6.363-003.0	O-Ring seal 13,0 X 2,0-NBR 90	6.000	ST	
31	6.362-381.0	O-Ring seal 13x2 - NBR 70	2.000	ST	
7	6.362-481.0	O-Ring seal 14,0 x 2,0 NBR 80	6.000	ST	
51	6.362-079.0	O-Ring seal 18,0 X 2,5	1.000	ST	
49	6.362-547.0	O-Ring seal 20,0x1,5-NBR 70	2.000	ST	
11	6.363-037.0	O-Ring seal complete 1ST.-R.	2.000	ST	
26	6.362-468.0	O-Ring seal complete 1ST.-R.	1.000	ST	
25	4.553-198.0	Piston complete only for replacement	1.000	ST	

## 23 Cylinder head

Professional \ High pressure cleaner hotwater \ Electric motor \ HDS 895 S \*EU \ Spare parts list HDS 895 S \*EUR \ Pump set \ Cylinder head

**KÄRCHER**

POS	Article no.	Description	Quantity	Unit	Foot note text
10	4.553-197.0	Piston complete only for replacement	2.000	ST	
52	6.505-025.0	Pressure accumulator	1.000	ST	
3	5.034-494.0	Retaining bracket	2.000	ST	
4	5.411-148.0	Screw plug	2.000	ST	
39	5.110-865.0	Sleeve	1.000	ST	
47	5.110-853.0	Sleeve	2.000	ST	
100	2.883-913.0	Spare part set pump	1.000	ST	
19	7.401-931.0	Sphere 5 K13 -1.4401 DIN 5401	1.000	ST	
17	7.307-017.0	Threaded pin M5x40 -St-45H-A2E ISO 4026	1.000	ST	
32	2.884-512.0	Valve (3 Stueck)	2.000	ST	
8	4.580-262.0	Valve complete	1.000	ST	
42	4.580-349.0	Valve complete chemistry	1.000	ST	
20	5.582-121.0	Valve disc	1.000	ST	
37	4.582-019.0	Valve disc complete	1.000	ST	
40	5.587-202.0	Valve housing	1.000	ST	
23	5.584-114.0	Valve pin	1.000	ST	
36	5.584-122.0	Valve pin	1.000	ST	
29	5.583-146.3	Valve screw	3.000	ST	
6	5.583-161.0	Valve screw	1.000	ST	
12	5.583-170.0	Valve screw	1.000	ST	
33	5.583-168.0	Valve screw safety valve	1.000	ST	
54	5.581-239.0	Valve seat	1.000	ST	
56	5.581-231.0	Valve seat	1.000	ST	
43	4.580-589.0	Valve with slot	1.000	ST	
9	5.115-796.0	Washer	2.000	ST	