

# HD CAGE CLASSIC

## Robust. Flexible. Reliable.

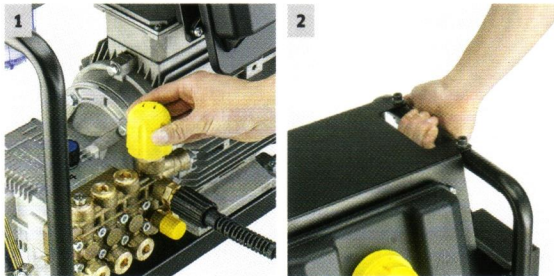

The Cage Classic range is sure to impress with its powerful crankshaft pumps and ceramic pistons. A water filter protects the pump. Mounting to a wall is possible thanks to a robust tubular frame construction. Now available: HD 7/11-4 Cage Classic with single-phase motor



### 1 Durable and reliable

- Four-pole electric motor.
- Brass cylinder head and ceramic piston.

### 2 Robust and secure

- Robust tubular frame pipe frame construction guarantees optimal protection of the machine.
- Integrated handles for transport.

#### HD 9/18-4 Cage Classic

- Durable crankshaft pump with ceramic-coated pistons
- Robust tubular frame construction for maximum protection
- Can be mounted to a wall

#### HD 7/16-4 Cage Classic

- Durable crankshaft pump with ceramic-coated pistons
- Trigger gun storage with automatic machine switch-off
- Can be mounted to a wall

#### HD 7/11-4 Cage Classic

- Durable crankshaft pump with ceramic-coated pistons
- Robust tubular frame construction for maximum protection
- Can be mounted to a wall

#### Technical data

	Ph / V / Hz	3 / 400 / 50	3 / 400 / 50	1 / 230 / 50
Current type	kW	5.9	4.3	3.3
Connection load	l/h	450-900	400-700	520-700
Flow rate	bar / MPa	70-180 / 7-18	70-160 / 7-16	70-110 / 7-11
Working pressure	bar	240	220	150
Max. pressure	°C	60	60	60
Max. water inlet temperature	kg	55	55	50.5
Weight	mm	640 × 360 × 500	780 × 360 × 500	640 × 360 × 500
Dimensions (L × W × H)				

#### Equipment

		Standard trigger gun	Standard trigger gun	Standard trigger gun
Spray gun				
High-pressure hose	m	10	10	10
Spray lance	mm	600	100	600
Switchable triple nozzle		-	-	-
Power nozzle	■	■	■	■
Dirt blaster	-	-	-	-
High-pressure hose reel	-	-	-	-
Servo Control	-	-	-	-

Order No.	1.367-315.0	1.367-314.0	1.367-318.0
-----------	-------------	-------------	-------------

Price			
-------	--	--	--

■ Included in delivery.