

71 Burner cover

Professional \ High pressure cleaner hotwater \ Electric motor \ HDS 895 SX *EU \ Spare parts list HDS 895 S *EUR \ Flow heater \ Burner cover

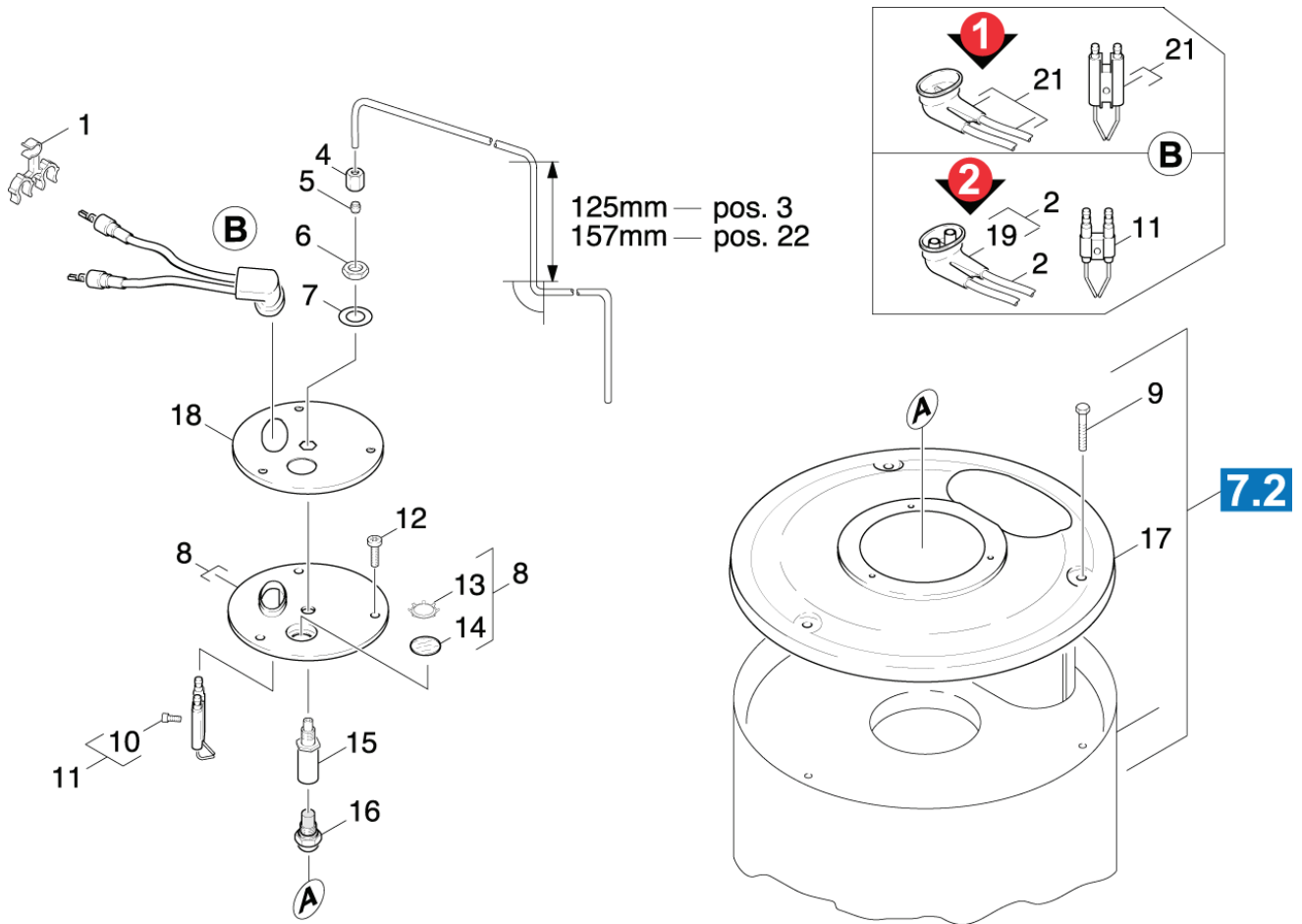

71 Burner cover

Professional \ High pressure cleaner hotwater \ Electric motor \ HDS 895 SX *EU \ Spare parts list HDS 895 S *EUR \ Flow heater \ Burner cover



POS	Article no.	Description	Quantity	Unit
16	6.415-697.0	Burner nozzle 2,0GPH	1.000	ST
	Item text1: / 1.027-313.0			
3	5.423-186.0	Conduit fuel	1.000	ST
22	5.423-187.0	Conduit fuel	1.000	ST
21	2.638-976.0	Conversion kit ignition cable	1.000	ST
11	2.638-974.0	Conversion kit ignition electrode	1.000	ST
17	5.654-066.0	Cover pressure boiler	1.000	ST
8	4.654-218.0	Cover pressure boiler	1.000	ST
18	5.654-059.0	Cover pressure boiler	1.000	ST
5	6.389-263.0	Cutting ring d.4	1.000	ST
14	6.278-018.0	Glass pane	1.000	ST
6	7.311-101.0	Hexagon nut M10x1 -04-A2E ISO 8675	1.000	ST
1	6.647-527.0	Holder	1.000	ST
2	4.821-071.0	IGNITION LEAD (HDS 557CI)	1.000	ST
16	6.415-641.0	Nozzle	1.000	ST
	Item text1: / 1.027-301.0 / -302.0 / -304.0 / -305.0 / -306.0 / -307.0 / -312.0 / -314.0 / -320.0 / -321.0			
15	5.667-055.0	Nozzle holder	1.000	ST
19	5.394-470.0	Protecting cap	1.000	ST
12	7.303-038.0	Screw M5x12 -St-P2R (In6Rd)	3.000	ST
10	7.306-217.0	Screw M5x14 -8.8-R2R (In6Rd)	1.000	ST
9	6.303-258.0	Self-tapping screw	3.000	ST
13	6.343-165.0	Serrated ring	1.000	ST
7	7.312-302.0	Spring washer B10-FST-A2E DIN 137	1.000	ST
4	6.389-262.0	Union nut A 4-LL	1.000	ST