

# 72 Burner cover

Professional \ High pressure cleaner hotwater \ Electric motor \ HDS 558 C \*EU \ Spare parts list HDS 558 C \ Flow heater \ Burner cover

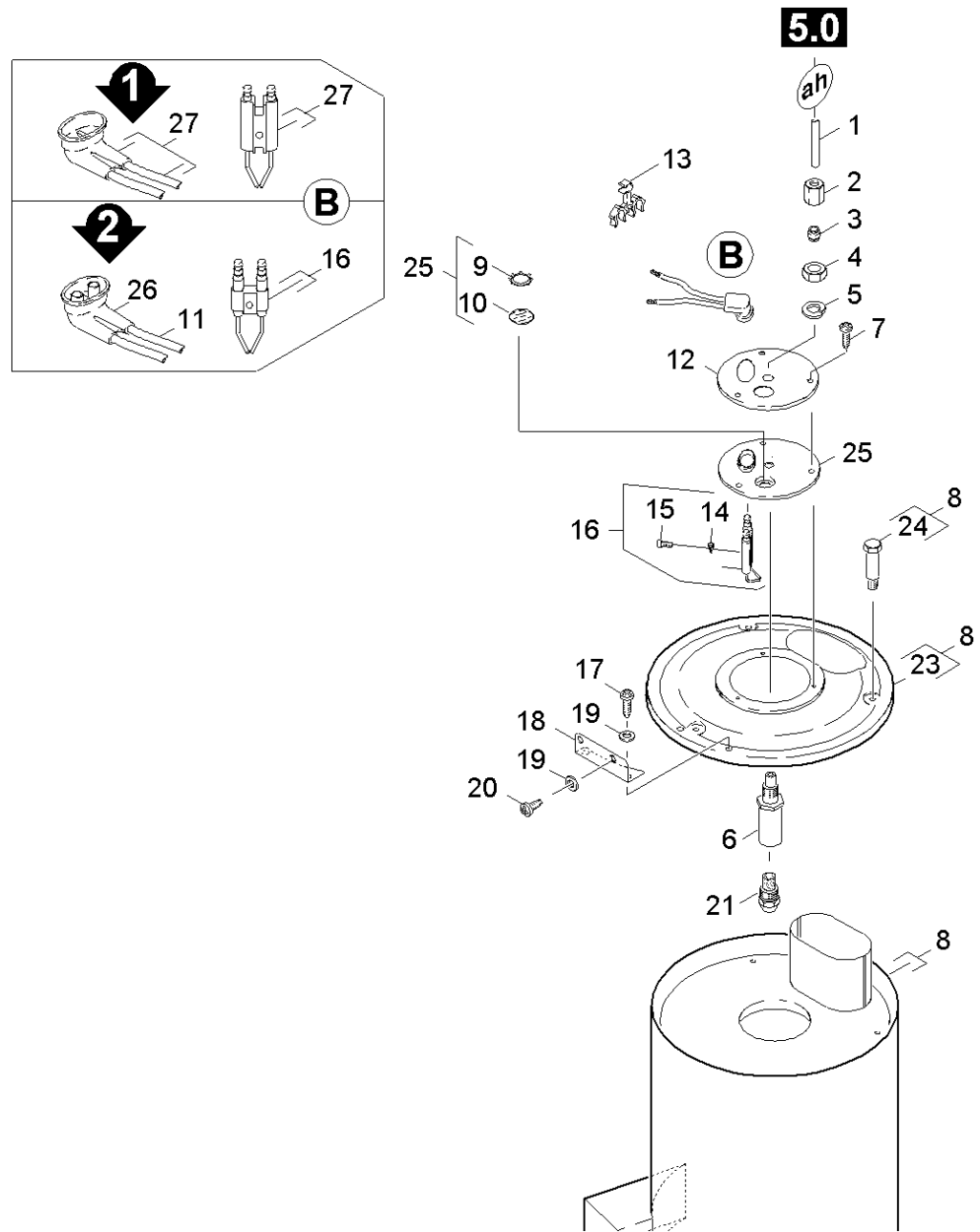

## 72 Burner cover

Professional \ High pressure cleaner hotwater \ Electric motor \ HDS 558 C \*EU \ Spare parts list HDS 558 C \ Flow heater \ Burner cover

**KÄRCHER**

POS	Article no.	Description	Quantity	Unit
1	5.423-253.0	Conduit	1.000	ST
2	6.389-262.0	Union nut A 4-LL	1.000	ST
3	6.389-263.0	Cutting ring d.4	1.000	ST
4	7.311-101.0	Hexagon nut M10x1 -04-A2E ISO 8675	1.000	ST
5	7.312-302.0	Spring washer B10-FST-A2E DIN 137	1.000	ST
6	5.667-055.0	Nozzle holder	1.000	ST
8	4.652-133.0	Outer covering	1.000	ST
9	6.343-165.0	Serrated ring	1.000	ST
10	6.278-018.0	Glass pane	1.000	ST
11	4.821-071.0	IGNITION LEAD (HDS 557CI)	1.000	ST
12	5.654-059.0	Cover pressure boiler	1.000	ST
13	6.647-527.0	Holder	1.000	ST
14	7.312-304.0	Spring washer B 5-FST-A2E DIN 137	1.000	ST
15	7.306-217.0	Screw M5x14 -8.8-R2R (In6Rd)	1.000	ST
16	2.638-974.0	Conversion kit ignition electrode	1.000	ST
17	7.306-090.0	Screw M6x16 -8.8-P2R (In6Rd)	2.000	ST
18	5.762-234.0	Bracket electric control box	1.000	ST
19	7.312-291.0	Washer 6-200HV-P2R ISO7093-1	4.000	ST
20	7.303-047.0	Screw M6x16 -St-R3R (In6Rd)	2.000	ST
21	6.415-775.0	Burner nozzle	1.000	ST
	<b>Item text1:</b> / 1.170-115.0			
21	6.415-664.0	Burner nozzle	1.000	ST
	<b>Item text1:</b> / 1.170-101.0 / -102.0 / -103.0			
	<b>Item text2:</b> / -104.0 / -110.0 / -111.0 / -201.0			
23	4.654-196.0	Cover pressure boiler	1.000	ST
24	6.303-258.0	Self-tapping screw	3.000	ST
25	4.654-218.0	Cover plate pressure boiler	1.000	ST
26	5.394-470.0	Protecting cap	1.000	ST
27	2.638-976.0	Conversion kit ignition cable	1.000	ST