

32 Set cover for replacement HD-MX (4.100-633.0)

Professional \ High pressure cleaner cold water \ Electric motor \ HD 6/15 MXA Plus *EU \ Unit HD 6/15 MXA*EU \ Set cover for replacement HD-MX

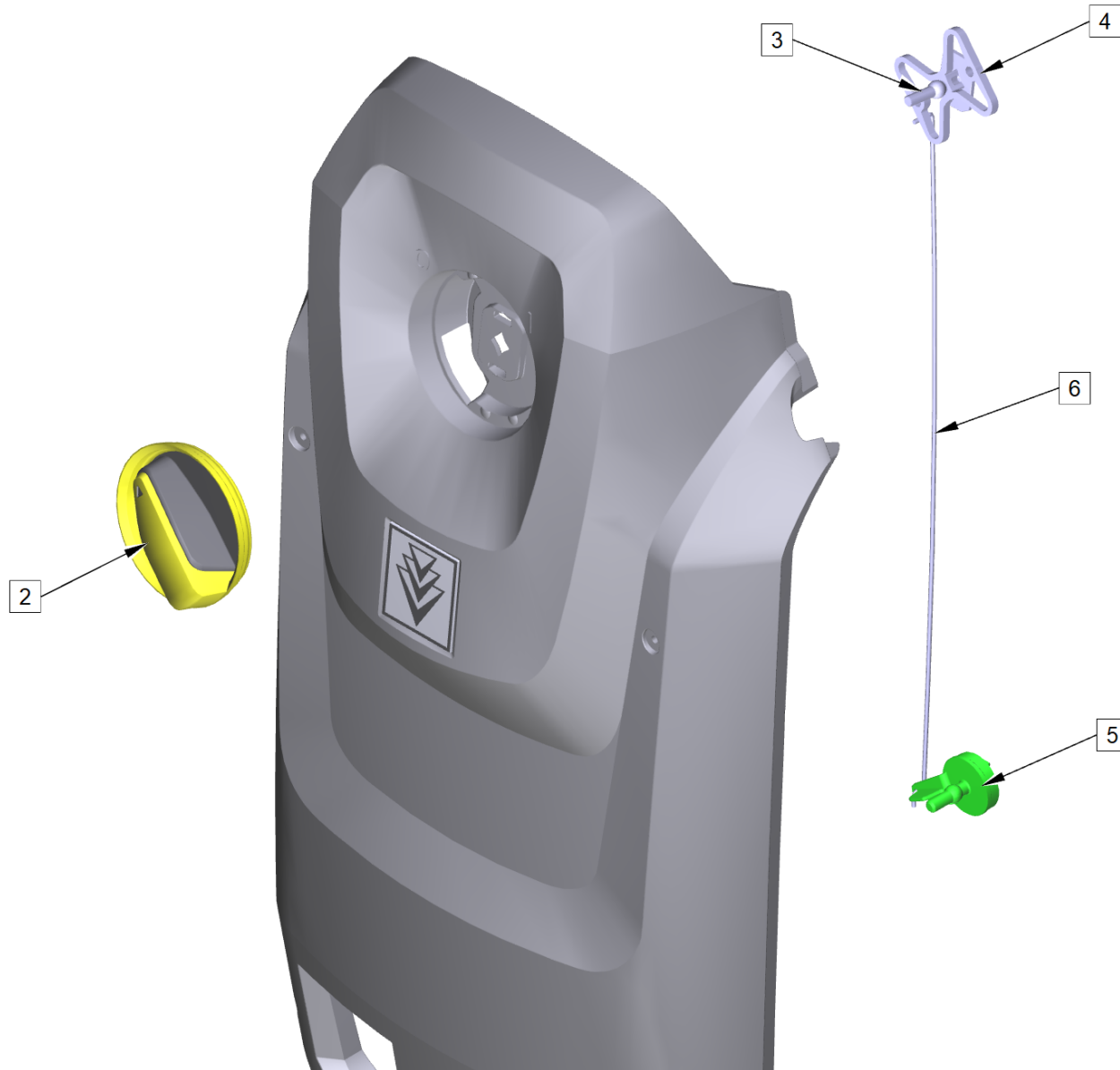

32 Set cover for replacement HD-MX (4.100-633.0)

Professional \ High pressure cleaner cold water \ Electric motor \ HD 6/15 MXA Plus *EU \ Unit HD 6/15 MXA*EU \ Set cover for replacement HD-MX



POS	Article no.	Description	Quantity	Unit
2	5.324-187.0	Handle	1	PC
3	5.034-241.0	Axle handle	1	PC
4	5.105-693.0	Spring tripping segment	1	PC
5	5.645-870.0	Deflection switch	1	PC
6	5.034-175.0	Switch rod	1	PC