

92 Suction bar

Professional \ Floor cleaner \ Walk behind \ BD 55/60 W BAT \ Spare parts list BR/BD 55/60W \ Suction bar \ Suction bar

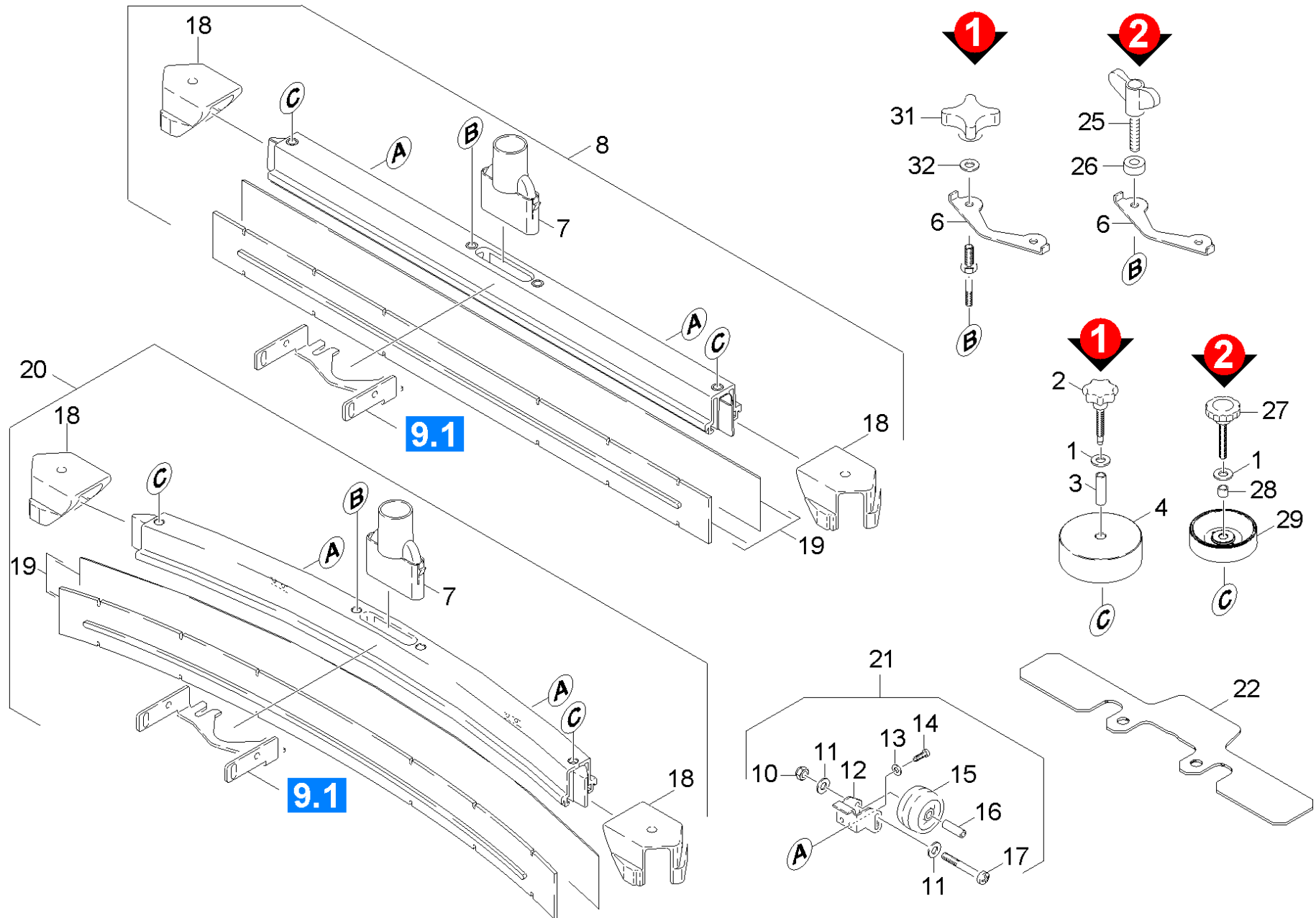

92 Suction bar

Professional \ Floor cleaner \ Walk behind \ BD 55/60 W BAT \ Spare parts list BR/BD 55/60W \ Suction bar \ Suction bar



POS	Article no.	Description	Quantity	Unit	Remark	Foot note text
21	2.639-561.0	Add-on kit support wheels suction bar	1.000	ST		
22	5.128-339.0	Additional weight suction bar	1.000	ST		
16	5.105-245.0	Axle	1.000	ST		
29	5.515-267.0	Deflector roll	2.000	ST	VERSION 2	
18	2.885-294.0	End piece left / right spare parts set	1.000	ST		
10	7.311-422.0	Hexagon nut M 6-1.4305 ISO 10511	1.000	ST		
12	5.044-304.0	Holder roller	2.000	ST		
6	5.007-217.0	Plate	1.000	ST		
6	5.007-619.0	Plate suction bar	1.000	ST		STAINLESS STEEL CONSTRUCTION
4	5.515-096.0	Roller	2.000	ST		VERSION 1
19	6.273-205.0	Rubber lip set anti stripe oil resistant	1.000	ZSA		ANTI-STRIP, OIL RESISTANT
19	6.273-208.0	Rubber lip set oil resistant	1.000	ZSA		OIL RESISTANT
19	6.273-214.0	Rubber lip set standard	1.000	ZSA		STANDARD
14	7.303-037.0	Screw M5x10 -St-P2R (In6Rd)	2.000	ST		
17	7.306-199.0	Screw M 6x50-A2-70 (IN6RD)	1.000	ST		
26	5.112-748.0	Sleeve	2.000	ST	VERSION 2	
28	5.094-231.0	Sleeve suction bar in VA	2.000	ST	VERSION 2	STAINLESS STEEL CONSTRUCTION
26	5.112-810.0	Sleeve VA	2.000	ST	VERSION 2	STAINLESS STEEL CONSTRUCTION
2	6.321-243.0	Star grip stainless steel D50x48	2.000	ST		VERSION 1
27	6.321-239.0	Star grip VA Ø50x43	2.000	ST	VERSION 2	STAINLESS STEEL CONSTRUCTION
31	6.321-133.0	Star handle	2.000	ST		VERSION 1
8	4.777-302.0	Suction bar 940AB	1.000	ST		
20	4.777-055.0	Suction bar curved	1.000	ST		
7	5.031-989.0	Suction nipple	1.000	ST		
3	5.094-050.0	Tube	2.000	ST		VERSION 1
13	7.312-058.0	Washer 5 -A2 ISO 7089	2.000	ST		
11	7.312-026.0	Washer 6 -A2 ISO 7089	2.000	ST		
1	7.312-004.0	Washer 8 -200HV-A3E ISO 7089	2.000	ST		
32	7.312-066.0	Washer 10 -A2 ISO 7089	2.000	ST		VERSION 1
15	6.435-401.0	Wheel D54	2.000	ST		
25	5.305-286.0	Wing screw M8x	2.000	ST	VERSION 2	
25	5.305-296.0	Wing screw M8x40 VA	2.000	ST	VERSION 2	STAINLESS STEEL CONSTRUCTION