

51 Operating elements

Overview technical documents/Professional/Sweepers/Combustion engine/KMR 1550 LPG (1.948-106.0)/Spare parts list KMR 1550 B/50 Cover/51 Operating elements

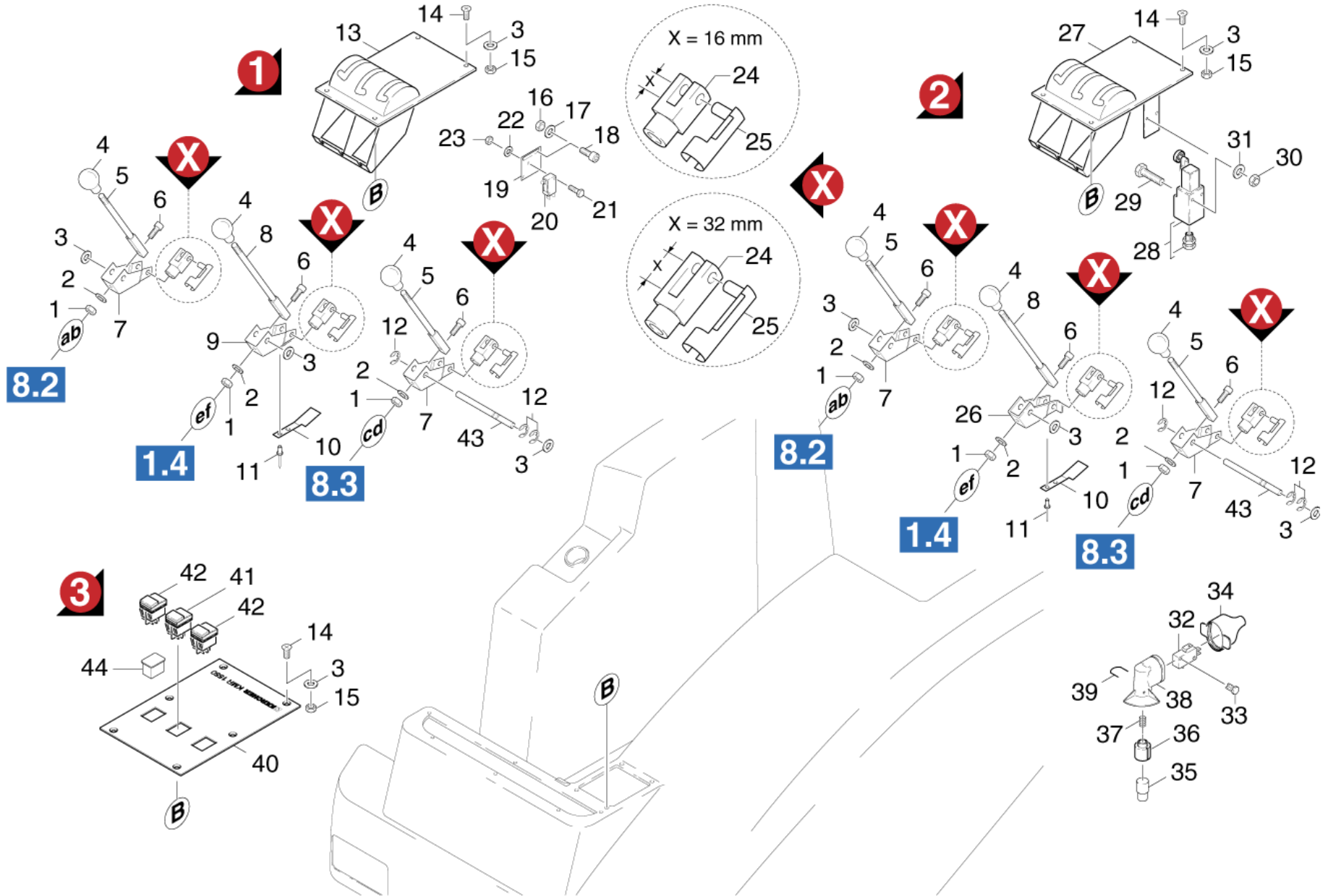

51 Operating elements

Overview technical documents/Professional/Sweepers/Combustion engine/KMR 1550 LPG (1.948-106.0)/Spare parts list KMR 1550 B/50 Cover/51 Operating elements

Rez.daļas/nodil.pakļ.daļas	Poz.	Materiāla Nr.	Nosaukums	Daudzums	Pārdoš. vienība	no sēr. Nr..	līdz sēr. Nr.	Daž. informācija
X-X	1	7.311-425.0	Hexagon nut M6 -04-A2E ISO 10511	3.000	ST	0000000000	0000000000	
X-X	2	7.312-003.0	Washer 6 -200HV-A3E ISO 7090	3.000	ST	0000000000	0000000000	
X-X	3	7.312-260.0	washer	8.000	ST	0000000000	0000000000	
	4	6.321-080.0	Handhold D35	3.000	ST	0000000000	0000010667	
	5	5.107-183.0	Bar	2.000	ST	0000000000	0000010667	
X-X	6	7.306-023.0	cylinder head screw	3.000	ST	0000000000	0000010667	
	7	5.047-551.0	Lever	2.000	ST	0000000000	0000010667	
	8	5.107-182.0	Bar	1.000	ST	0000000000	0000010667	
	9	5.047-703.0	Lever	1.000	ST	0000000000	0000010667	X=16 VERSION 1
	10	6.330-117.0	Spring	1.000	ST	0000000000	0000010667	
X-X	11	6.315-047.0	Blind rivet 3,0	1.000	ST	0000000000	0000010667	
X-X	12	7.343-302.0	Sprostpaplāksne 8 -St-ph DIN 6799	3.000	ST	0000000000	0000010667	
	13	4.605-028.0	Housing	1.000	ST	0000000000	0000010027	VERSION 1
X	14	7.305-063.0	Countersunk screw M6x20 -4.8-A2E ISO 20	6.000	ST	0000000000	0000000000	
	15	7.311-003.0	Hexagon nut M6 -8-A2E ISO 4032	6.000	ST	0000000000	0000000000	
X-X	16	7.311-421.0	Hexagon nut M 5-04-A2E ISO 10511	2.000	ST	0000000000	0000010027	
X-X	17	7.312-002.0	Washer 5-200HV-A3E ISO 7090	1.000	ST	0000000000	0000010027	
	18	7.306-077.0	Screw M5x16 -8.8-R2R (In6Rd)	2.000	ST	0000000000	0000010027	
	19	5.001-656.0	Plate	1.000	ST	0000000000	0000010027	
X-X	20	6.631-788.0	Toggle switch	1.000	ST	0000000000	0000010027	
	21	7.306-406.0	Cylinder head screw M3x16-4.8-A2E ISO 1	1.000	ST	0000000000	0000010027	
	22	7.312-043.0	Washer 3-A2 ISO 7089	2.000	ST	0000000000	0000010027	
	23	7.311-000.0	Hexagon nut M3 -8-A2E ISO 4032	2.000	ST	0000000000	0000010027	
X	24	7.462-006.0	Fork head G8x16 -St-A2E DIN71752	1.000	ST	0000000000	0000010667	X=16MM
X-X	24	7.462-013.0	Fork head G8x32 -St-A2E DIN71752	3.000	ST	0000000000	0000010667	X=32MM

51 Operating elements

Overview technical documents/Professional/Sweepers/Combustion engine/KMR 1550 LPG (1.948-106.0)/Spare parts list KMR 1550 B/50 Cover/51 Operating elements

Rez.daļas/nodil.pakļ.daļas	Poz.	Materiāla Nr.	Nosaukums	Daudzums	Pārdoš. vienība	no sēr. Nr..	līdz sēr. Nr.	Daž. informācija
	25	5.316-817.0	Bolt	1.000	ST	0000000000	0000010667	X=16
X-X	25	6.316-054.0	Bolt	1.000	ST	0000000000	0000010667	X=32
	26	5.048-980.0	Lever	1.000	ST	0000000000	0000010667	X=32 VERSION 2
	27	4.605-045.0	Housing	1.000	ST	0000010028	0000010667	VERSION 2
X-X	28	6.961-213.0	Switch	1.000	ST	0000010028	0000010667	
	29	7.306-167.0	Cylinder head screw M 4x40-8.8-A2E DIN	2.000	ST	0000010028	0000010667	
	30	7.311-001.0	Hexagon nut M4 -8-A2E ISO 4032	2.000	ST	0000010028	0000010667	
X	31	7.312-001.0	Washer 4 -200HV-A3E ISO 7089	2.000	ST	0000010028	0000010667	
X-X	32	6.631-854.0	Mikroslēdzis	1.000	ST	0000010028	0000000000	
	33	5.316-339.0	Bolt	1.000	ST	0000010028	0000000000	
X	34	5.394-338.0	Vāciņš	1.000	ST	0000010028	0000000000	
	35	5.316-317.0	Bolt	1.000	ST	0000010028	0000000000	
	36	5.053-051.0	Kronšteins	1.000	ST	0000010028	0000000000	
	37	5.332-332.0	Leg spring	1.000	ST	0000010028	0000000000	
	38	5.042-851.0	Holder	1.000	ST	0000010028	0000000000	
	39	5.037-101.0	Hook	1.000	ST	0000010028	0000000000	
	40	4.605-068.0	Plate	1.000	ST	0000010668	0000000000	VERSION 3
X-X	41	6.630-006.0	Switch	1.000	ST	0000010668	0000000000	
X-X	42	6.630-005.0	Switch 2-POLIG	2.000	ST	0000010668	0000000000	
	43	5.105-247.0	Axle	1.000	ST	0000000000	0000010067	
X-X	44	6.631-736.0	Blind plug	1.000	ST	0000000000	0000000000	