

New Unit Information



KM 70/20 C

1.517-...

Design:

- The main brush is driven by both wheels.
- Both wheels with freewheel mechanism.
- The main brush consists of 2 half-shells.
- Side brush with steplessly adjustable height.
- Main brush with six height adjustment settings.
- Fine dust filter.
- Brushing system according to the dustpan principle.
- Adjustable push handle (can be folded in for transport).
- Width, sweeping path w/o side brush 430 mm.
- Width, sweeping path with side brush 700 mm.

View from the front

- 1 Push handle
- 2 Retaining screw, push handle
- 3 Wheel
- 4 Debris container
- 5 Carrying handle
- 6 Swivel caster
- 7 Side brush
- 8 Side brush arm
- 9 Adjusting screw, side brush height adjustment
- 10 Adjusting lever, main brush adjustment

Rear view



- 1 Debris container
- 2 Adjusting screw, side brush height adjustment (stepless)
- 3 Side brush arm
- 4 Side brush
- 5 Wheel
- 6 Sealing lip
- 7 Fine dust filter
- 8 Adjusting lever, main brush height adjustment (6 settings)
- 9 Push handle

View from underneath (without debris container)

- 1 Swivel caster
- 2 Sealing strip
- 3 Main brush
- 4 Wheel
- 5 Sealing lip
- 6 Side brush drive belt
- 7 Side brush arm
- 8 Side brush

Side brush arm raised, side brush unscrewed

- 1 Side brush mounting plate
- 2 Mounting plate retaining screw
- 3 Deflection pulleys for drive belt
- 4 Wheel
- 5 Side brush arm
- 6 Side brush drive belt
- 7 Side brush
- 8 Retaining screws for side brush (3x)

Side brush drive



- 1 Main brush
- 2 Side brush drive belt
- 3 Hexagonal nut for retainig the side brush base mounting plate (5)
- 4 Flat washer
- 5 Side brush base mounting plate
- 6 Wheel
- 7 Side brush arm
- 8 Side brush mounting plate, drive shaft

Note:

When installing the drive belt (2) pay attention to the rotational direction of the side brush. When moving forward the side brush must rotate towards the inside.

Main brush



- 1 Fine dust filter
- 2 Main brush
- 3 Retaining screws of the main brush half-shells (6x)

Note:

To dismantle the main brush, unscrew all 6 retaining screws (3). The two main brush half-shells can then be taken out.

Main brush drive

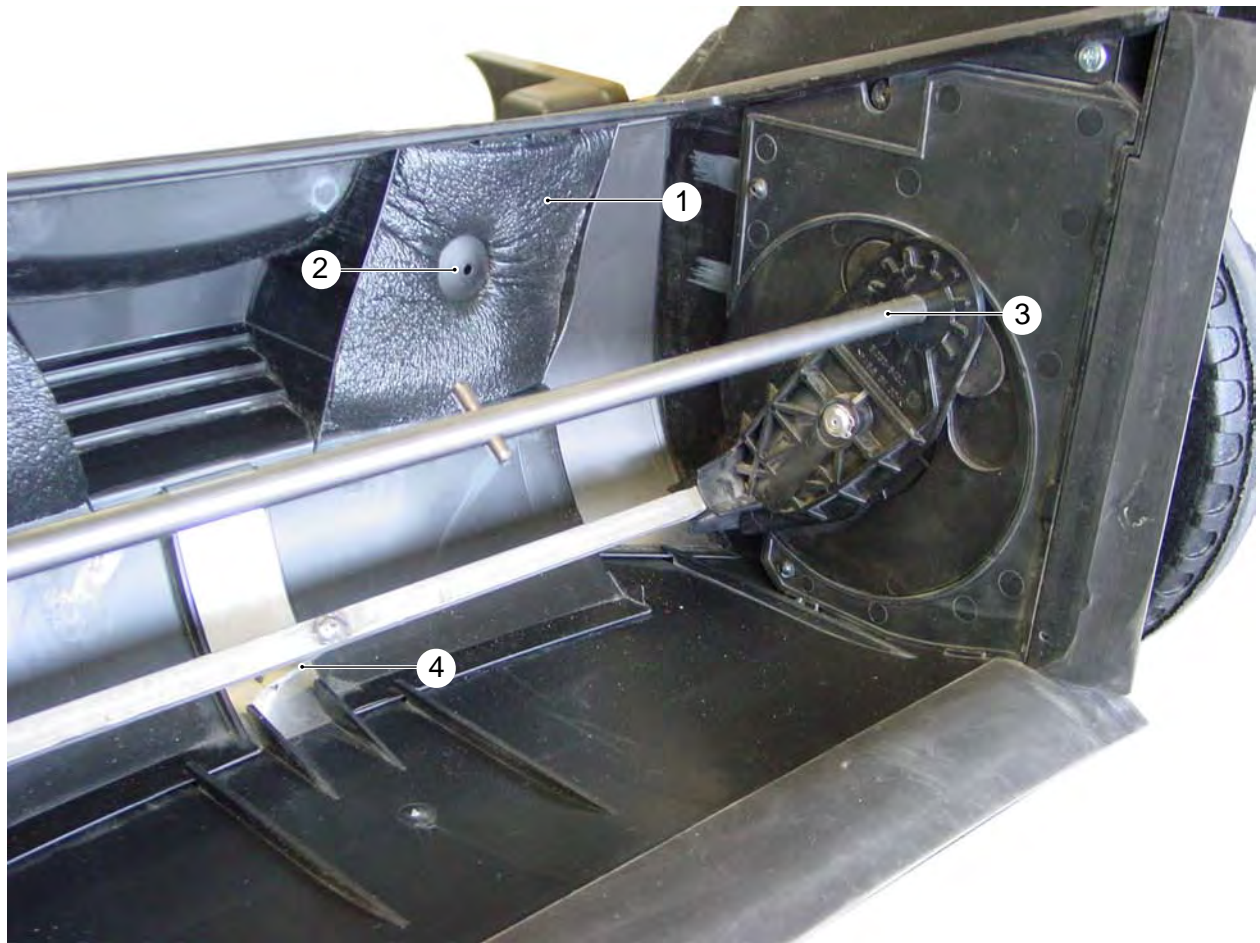

- 1 Fine filter
- 2 Retaining pin for fine filter
- 3 Drive shaft for main brush
- 4 Main brush height adjusting arm

Remove fine filter

- Pull out the retaining pin (2).
- The fine filter (1) can be removed.

Main brush drive



- 1 Wheel
- 2 Flat washer
- 3 Lock washer
- 4 Axle

Remove wheel

- Use a screwdriver to unclip the cap cover in the middle of the wheel (not shown).
- Use wire cutting pliers to disconnect and remove the lock washer (3).
- The wheel can be pulled off the axle (4).

Note:

The lock washer (3) is broken when removed. A new lock washer (3) must be used to reinstall the wheel.

Main brush drive

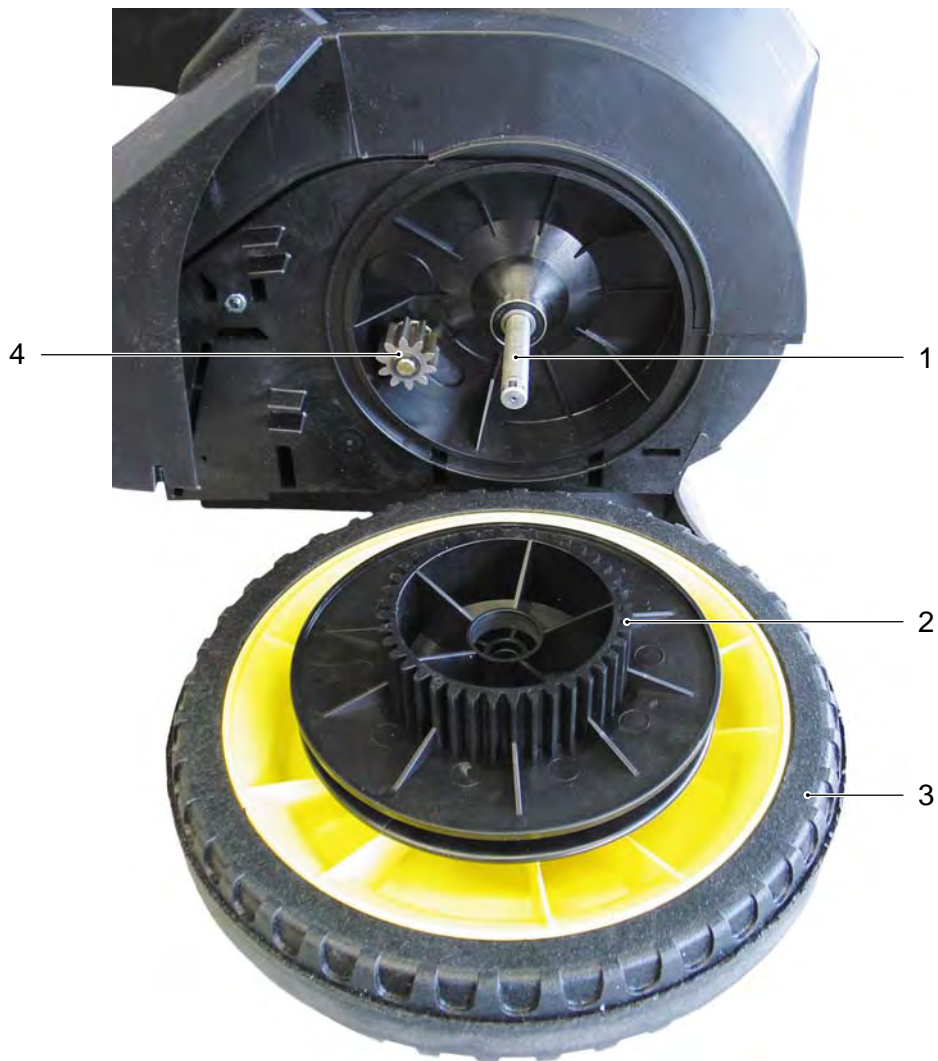

- 1 Axle
- 2 Sprocket-wheel
- 3 Wheel
- 4 Driving gear for main brush (with freewheeling mechanism)

Note:

The main brush is driven by both wheels. Both driving gears with freewheel mechanism.

Troubleshooting

Fault	Solution
Unsatisfactory sweeping result	<ul style="list-style-type: none">– Empty debris container.– Adjust height of main brush/clean/replace.– Adjust height of side brush/clean/replace.– Check/replace sealing strips.– Check/replace the drive belt for side brush.

Technical specifications

Unit Type	Unit No.	Operating instructions	Spare parts list
KM 70/20 C (1 side brush)	1.517-101	5.961-234	5.970-279

The technical data sheet and the circuit diagram will be included in the next issue of the spare parts CD-ROM (DISIS) and are available in the Intranet.

Technical data sheet: Folder: „Central / Service Info Int'l / Technical Specifications“

Circuit diagram: Folder: „Central / Service Info Int'l / Circuit Diagram“

If required, the operating instructions and the spare parts lists can be ordered as a paper copy from the spare parts service by quoting the relevant part number.

Special tool

No special tools are required.

Tightening torque

No details.