

2 Suction bar curved 850mm (4.777-411.0)

Professional \ Floor cleaner \ Walk behind \ B 60 W Bp *EU \ Documentation B 60 W \ Spare parts list B 60 W \ Suction bar \ Suction bar \ Suction bar curved 850mm

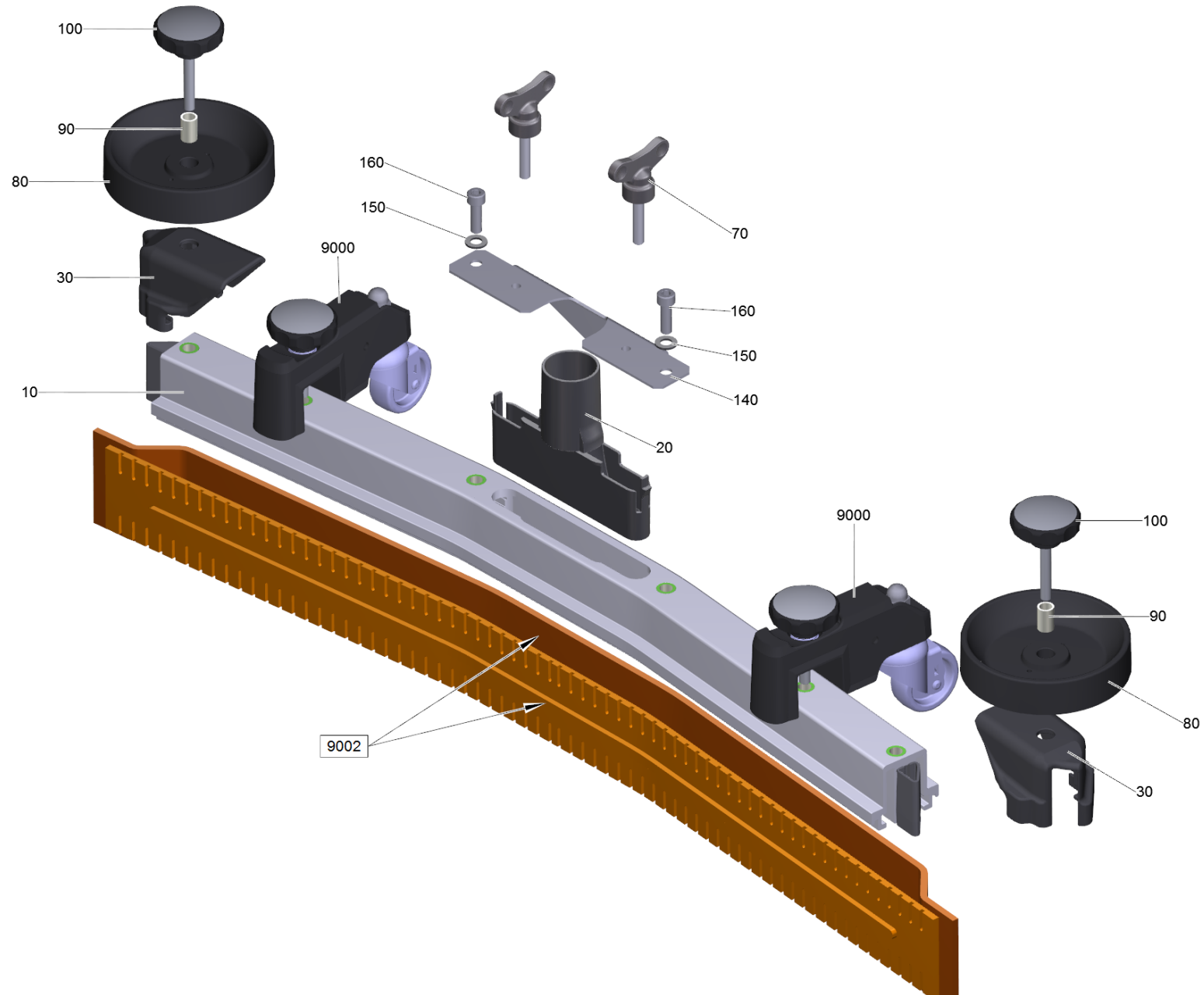

2 Suction bar curved 850mm (4.777-411.0)

Professional \ Floor cleaner \ Walk behind \ B 60 W Bp *EU \ Documentation B 60 W \ Spare parts list B 60 W \ Suction bar \ Suction bar \ Suction bar curved 850mm

KÄRCHER

POS	Article no.	Description	Quantity	Unit	Remark	Foot note text
9002	6.273-290.0	BLADES FOR TEXTURED FLOORS	1.000	ST		
9000	4.035-281.0	Conversion kit support roller deep	2.000	ST	VERSION 2	ORDER QTY. 2
160	7.306-142.0	Cylinder head screw M 8x25-A4-70 ISO 47	2.000	ST		
80	5.515-346.0	Deflector roll suction bar D120	2.000	ST		
30	2.885-294.0	End piece left / right spare parts set	1.000	ST		
9000	4.035-339.0	Roller suction bar	2.000	ST	VERSION 1	
9002	6.273-229.0	Rubber lip set anti stripe oil resistant	1.000	ST		
9002	6.273-207.0	Rubber lip set oil resistant BR-BD530,55	1.000	ZSA		
9002	6.273-213.0	Rubber lip set standard	1.000	ZSA		STANDARD
90	5.094-231.0	Sleeve suction bar in VA	2.000	ST		
100	6.321-243.0	Star grip stainless steel D50x48	2.000	ST		
10	4.035-311.0	Suction bar pre-assembled curved 850mm	1.000	ST		
140	5.100-559.0	Suction bar support plate	1.000	ST		
20	5.033-601.0	Suction nipple	1.000	ST		
150	7.312-017.0	Washer 8-A2 ISO 7089	2.000	ST		
70	5.305-008.0	Wing screw M8x30 VA	2.000	ST		