

22 Cylinder head

Professional \ High pressure cleaner hotwater \ Electric motor \ HDS 796 CW *JP \ Spare parts list HDS 796 CW *J \ Pump set \ Cylinder head

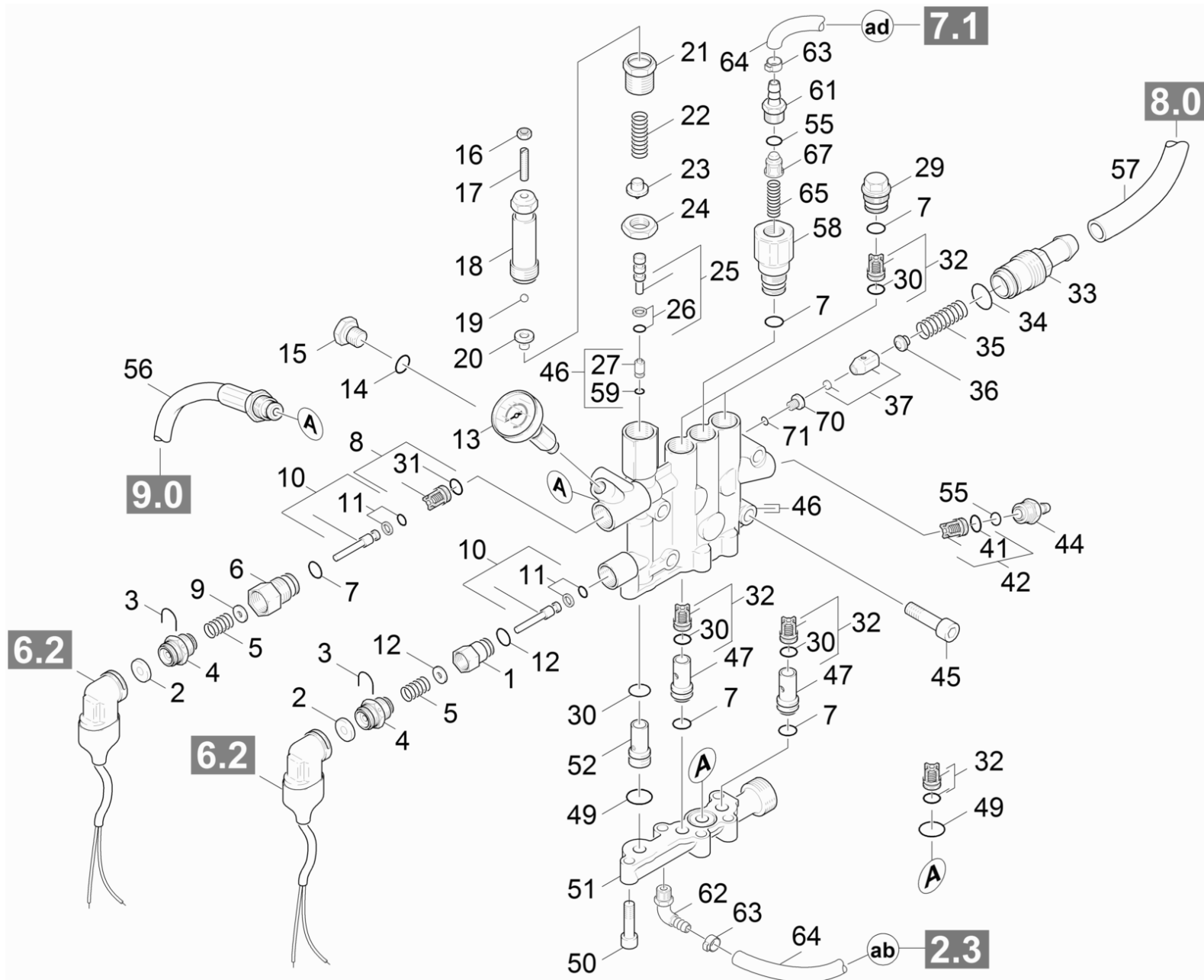

22 Cylinder head

Professional \ High pressure cleaner hotwater \ Electric motor \ HDS 796 CW *JP \ Spare parts list HDS 796 CW *J \ Pump set \ Cylinder head



POS	Preces Nr.	Apraksts	Skaitis	Vienība	Sērijas numurs no	Sērijas numurs līdz	Zemsvītras piezīme
50	7.306-043.0	Cil. galvas skr. M8x30 -8.8-A2E ISO	5.000	ST	0000000000	0000000000	
45	7.306-106.0	Cil. galvas skr. M8x70 -8.8-A2E ISO4	4.000	ST	0000000000	0000000000	
46	4.550-459.0	Cylinder head	1.000	ST	0000000000	0000000000	
26	6.362-468.0	Gredzenblīve, pilns komplekts 1ST.-R.	1.000	ST	0000000000	0000000000	
11	6.363-037.0	Gredzenblīve, pilns komplekts 1ST.-R.	2.000	ST	0000000000	0000000000	
41	6.363-613.0	Gredzenblīve 4 x 2 -NBR90	1.000	ST	0000000000	0000000000	
12	6.362-853.0	Gredzenblīve 4,47x1,78	1.000	ST	0000000000	0000000000	
69	6.362-386.0	Gredzenblīve 5,0 x 1,5-NBR 80	1.000	ST	0000000000	0000000000	
59	6.362-386.0	Gredzenblīve 5,0 x 1,5-NBR 80	1.000	ST			
71	6.362-703.0	Gredzenblīve 6,0x1,5-NBR 70	1.000	ST	0000000000	0000000000	
14	6.362-101.0	Gredzenblīve 8 X 2	1.000	ST	0000000000	0000000000	
55	6.362-151.0	Gredzenblīve 10 x 2 NBR 70	2.000	ST	0000000000	0000000000	
34	6.362-169.0	Gredzenblīve 12,0 X 2,0	1.000	ST	0000000000	0000000000	
30	6.363-003.0	Gredzenblīve 13,0 X 2,0-NBR 90	6.000	ST	0000000000	0000000000	
31	6.362-381.0	Gredzenblīve 13x2 - NBR 70	1.000	ST	0000000000	0000000000	
7	6.362-481.0	Gredzenblīve 14,0 x 2,0 NBR 80	6.000	ST	0000000000	0000000000	
49	6.362-547.0	Gredzenblīve 20,0x1,5-NBR 70	2.000	ST	0000000000	0000000000	
16	7.311-002.0	hexagon nut	1.000	ST	0000000000	0000000000	
21	5.404-082.0	hollow screw	1.000	ST	0000000000	0000000000	
63	6.389-882.0	Hose clip 8,5-10,0	2.000	ST	0000000000	0000000000	
57	6.388-167.0	Hose DN15	1.000	M	0000000000	0000000000	TO ORDER AS CUT GOODS
56	4.440-790.0	Hose SDS	1.000	ST	0000000000	0000000000	
64	6.389-862.0	Hose silicon DN4	2.000	M	0000000000	0000000000	
61	5.443-470.0	Hose stem	1.000	ST	0000000000	0000000000	
44	5.443-455.0	Hose stem	2.000	ST	0000000000	0000000000	
62	6.388-421.0	Leņķveida uzgalis 1/8	1.000	ST	0000000000	0000000000	
19	7.401-931.0	locking ring	1.000	ST	0000000000	0000000000	
13	6.421-215.0	Manometrs 0-300 bāri	1.000	ST	0000000000	0000000000	
2	5.367-030.0	Membrāna	2.000	ST	0000000000	0000000000	
9	5.115-796.0	Paplāksne	2.000	ST	0000000000	0000000000	

22 Cylinder head

Professional \ High pressure cleaner hotwater \ Electric motor \ HDS 796 CW *JP \ Spare parts list HDS 796 CW *J \ Pump set \ Cylinder head



POS	Preces Nr.	Apraksts	Skaits	Vienība	Sērijas numurs no	Sērijas numurs līdz	Zemsvītras piezīme
25	4.553-198.0	Piston complete only for replacement	1.000	ST	0000000000	0000000000	
67	5.584-091.0	Pretvārsta ass	1.000	ST	0000000000	0000000000	
3	5.034-494.0	Retaining bracket	2.000	ST	0000000000	0000000000	
24	5.311-204.0	Sešstūra uzgrieznis M22 x 1,5	1.000	ST	0000000000	0000000000	
18	5.304-070.0	Skrūve ar sešstūru galvu	1.000	ST	0000000000	0000000000	
52	5.110-797.0	sleeve	1.000	ST	0000000000	0000000000	
22	5.332-444.0	Spirālveida atspere	1.000	ST	0000000000	0000000000	
5	5.332-268.0	Spirālveida atspere	2.000	ST	0000000000	0000000000	
35	5.332-414.0	Spirālveida atspere	1.000	ST	0000000000	0000000000	
65	5.332-258.0	Spirālveida atspere	1.000	ST	0000000000	0000000000	
17	7.307-009.0	Thread pin	1.000	ST	0000000000	0000000000	
47	5.110-608.0	Uzmava	2.000	ST	0000000000	0000000000	
10	4.553-197.0	Valve	2.000	ST	0000000000	0000000000	
32	2.884-512.0	Valve (3 Stueck)	1.000	ST	0000000000	0000000000	
8	4.580-262.0	Valve complete	1.000	ST	0000000000	0000000000	
42	4.580-349.0	Valve complete chemistry	1.000	ST	0000000000	0000000000	
37	4.582-019.0	Valve disc complete	1.000	ST	0000000000	0000000000	
51	5.587-201.0	Valve housing	1.000	ST	0000000000	0000000000	
23	5.584-114.0	valve pin	1.000	ST	0000000000	0000000000	
36	5.584-060.0	Valve pin	1.000	ST	0000000000	0000000000	
33	5.583-130.0	Valve screw	1.000	ST	0000000000	0000000000	
58	5.583-165.0	Valve screw	1.000	ST	0000000000	0000000000	
70	5.581-231.0	Vārsta ligzda	1.000	ST	0000000000	0000000000	
68	5.581-239.0	Vārsta ligzda	1.000	ST	0000000000	0000000000	
27	5.581-239.0	Vārsta ligzda	1.000	ST			
6	5.583-161.0	Vārsta skrūve	1.000	ST	0000000000	0000000000	
29	5.583-146.0	Vārsta skrūve	2.000	ST	0000000000	0000000000	
20	5.582-121.0	Vārstu plate	1.000	ST	0000000000	0000000000	
1	5.402-686.0	Vītņots elements	1.000	ST	0000000000	0000000000	
4	5.411-148.0	Vītņtapa	2.000	ST	0000000000	0000000000	
15	5.411-070.0	Vītņtapa	1.000	ST	0000000000	0000000000	