

KÄRCHER

4. HD 6/15 M, HD 7/17 M, Cage and ST

(1.150-9xx.0, 1.151-
9xx.0, 1.524-9xx.0)

Valve (3 ea.) (2.884-916.0),
Spacer (5.110-050.0/-079.0)

Service Bulletin

No. 2021-011 dated 08/02/2021

Classification level III

Problem: No or inadequate operating pressure. The start-up valve (only in 1-phase units) has already been checked/replaced.

Cause: The suction and above all pressure valves (2.884-916.0) can be damaged, see Fig. 1.

Solution: Check and possibly replace pressure and suction valves.

If the pressure valves were damaged, Fig. 3, the newly designed plugs (4.100-824.0/-825.0) made of plastic should be fitted, see Fig. 2. This offers improved support for the valve cages. The previously split spacers and plugs have been put together.

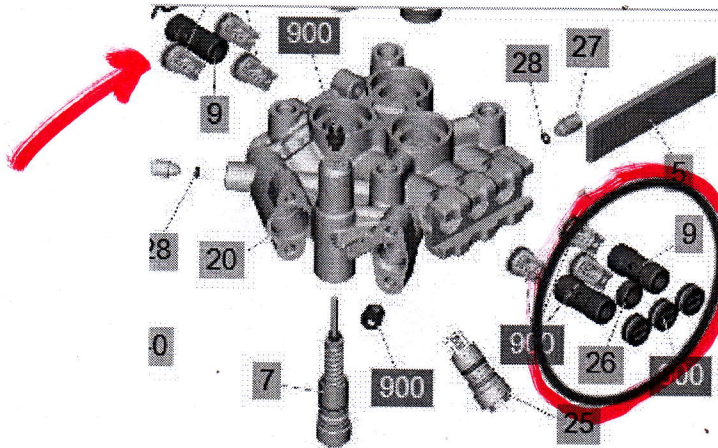

Fig. 1:

Old spacers

Pos. 9, 2x long,
5.110-079.0

Pos 26, 1x short,
5.110-050.0

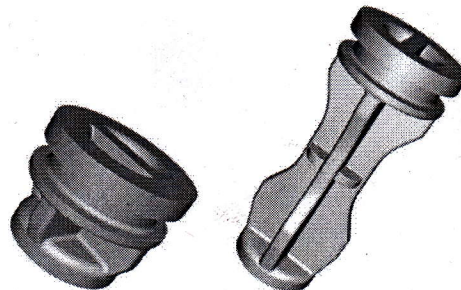

Fig. 2:

New plug, incl. O-ring

Left short (18 mm),
4.100-825.0

Right, long (36 mm),
4.100-824.0

KÄRCHER

4. HD 6/15 M, HD 7/17 M, Cage and ST

(1.150-9xx.0, 1.151-
9xx.0, 1.524-9xx.0)

Valve (3 ea.) (2.884-916.0),
Spacer (5.110-050.0/-079.0)

Service Bulletin

No. 2021-011 dated 08/02/2021

Classification level III

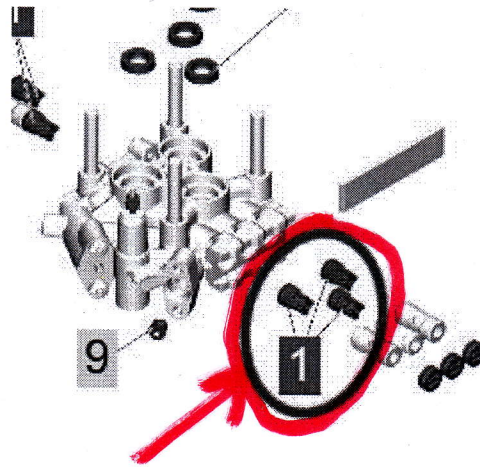

Fig. 3:

Pos. 1, valve (3 ea.)
2.884-916.0

Note:

Change / Improvement in production since: 01/03/2021

Unit:	Manufacture No.:	Serial No.:
HD 6/15 M	1.150-930.0	40000
HD 6/15 MX Plus	1.150-931.0	40000
HD 6/15 M Plus	1.150-932.0	40000
HD 6/15 M Plus	1.150-933.0	40000
HD 6/15 MX Plus	1.150-934.0	40000
HD 6/15 M	1.150-935.0	40000
HD 2.3/15 M Cage Ed	1.150-936.0	40000
HD 6/15 M Edition Power Control	1.150-937.0	40000
HD 6/15 MX Plus Loxam	1.150-938.0	40000
HD 3.0/20 M Cage Ea	1.150-939.0	40000
HD 6/15 M Plus	1.150-940.0	40000
HD 6/15 M	1.150-941.0	40000
HD 6/15 MXA Plus	1.150-943.0	40000
HD 6/15 MXA Plus	1.150-944.0	40000
HD 6/15 M 50Hz	1.150-945.0	40000
HD 6/15 M St	1.150-950.0	40000

KÄRCHER

4. HD 6/15 M, HD 7/17 M, Cage and ST

(1.150-9xx.0, 1.151-
9xx.0, 1.524-9xx.0)

Valve (3 ea.) (2.884-916.0),
Spacer (5.110-050.0/-079.0)

Service Bulletin

No. 2021-011 dated 08/02/2021

Classification level III

HD 6/15 M St	1.150-951.0	40000
HD 6/15 M Portable	1.150-952.0	40000
HD 6/15 Cage-ST	1.150-960.0	40000
HD 6/15 M Cage	1.150-970.0	40000
HD 6/15 M Cage	1.150-971.0	40000
HD 7/17 M	1.151-930.0	40000
HD 7/17 MX Plus	1.151-931.0	40000
HD 7/17 M Plus	1.151-932.0	40000
HD 7/15 M	1.151-933.0	40000
HD 7/15 M	1.151-934.0	40000
HD 7/17 M	1.151-935.0	40000
HD 7/17 MXA Plus	1.151-936.0	40000
HD 7/17 M	1.151-941.0	40000
HD 7/17 M St	1.151-950.0	40000
HD 7/17 M Portable	1.151-951.0	40000
HD 7/17 M Cage	1.151-960.0	40000
HD 7/14-4 M	1.524-930.0	40000
HD 7/14-4 MX Plus	1.524-931.0	40000
HD 7/14-4 M Plus	1.524-932.0	40000
HD 6/16-4 M Plus	1.524-933.0	40000
HD 6/16-4 MX Plus	1.524-934.0	40000
HD 6/15-4 M Plus	1.524-935.0	40000
HD 7/12-4 M Plus	1.524-936.0	40000
HD 7/12-4 M ST	1.524-937.0	40000
HD 6/11-4 M Plus	1.524-938.0	40000
HD 6/11-4 M St	1.524-939.0	40000
HD 6/16-4 M Cage	1.524-940.0	40000
HD 7/13-4 M	1.524-941.0	40000
HD 7/14-4 M Cage	1.524-942.0	40000

KÄRCHER

**4. HD 6/15 M, HD 7/17 M,
Cage and ST
(1.150-9xx.0, 1.151-
9xx.0, 1.524-9xx.0)
Valve (3 ea.) (2.884-916.0),
Spacer (5.110-050.0/-079.0)**

**Service Bulletin
No. 2021-011 dated 08/02/2021
Classification level III**

HD 7/14-4M Plus	1.524-943.0	40000
HD 3.0/20-4 M Cage Ea	1.524-944.0	40000
HD 6/16-4 MXA Plus	1.524-945.0	40000
HD 7/14-4 MXA Plus	1.524-947.0	40000
HD 7/12-4 M Cage	1.524-948.0	40000

Warranty handling:	Causing fault	5.110-079.0
	Fault code	200
	Valid until	30/09/2022