

New Unit Information



BDS 33/190 C

1.291-201

Newly developed single disc floor cleaner for light work and small to medium-sized areas.

Design:

- Drive motor especially developed for single disc machines.
- Robust planetary gears.
- High torque for high performance.
- Very quiet.
- Cable storage on the unit.

Unit specifications:

- Working width 330mm
- Speed 190 rpm
- Mains voltage 220-240 V / 50Hz / 1Ph
- Motor rating 500W

View from the front



- 1 Unlock unit switch
- 2 Guide handle
- 3 Unlock lever inclination adjustment
- 4 Upper bracket for cleaning agent tank
- 5 Mains cable
- 6 Guide rod

- 7 Lower bracket for cleaning agent tank and cable hanging hook
- 8 Power supply cable - brush motor
- 9 Motor cover
- 10 Transport wheel (2x)

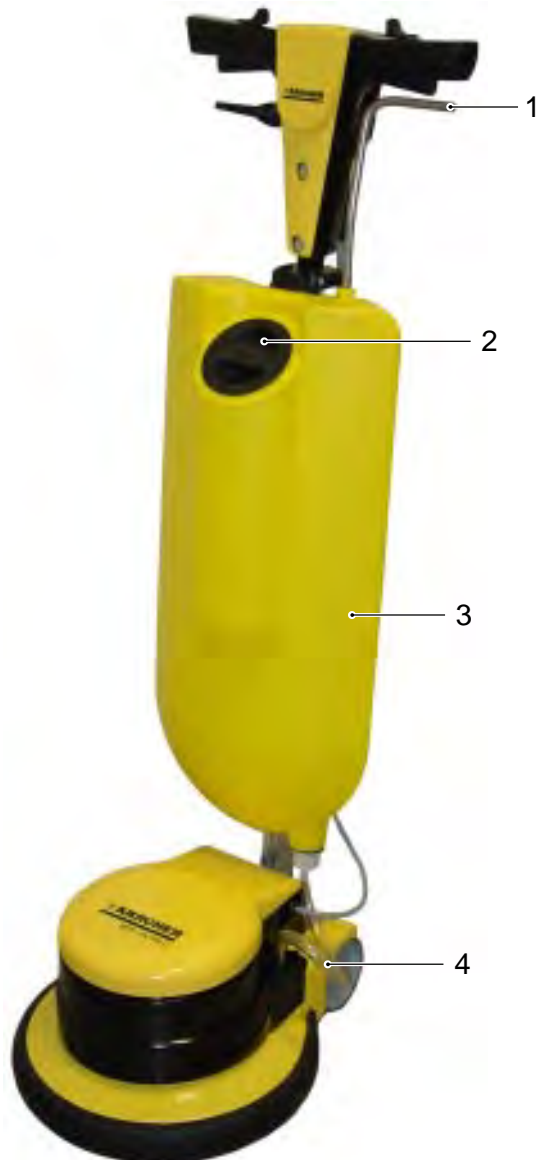
View from the front with cleaning agent tank (option)

- 1 Handle, valve opening lever for cleaning agent
- 2 Tank inlet for cleaning agent
- 3 Cleaning agent tank
- 4 Cleaning agent supply hose

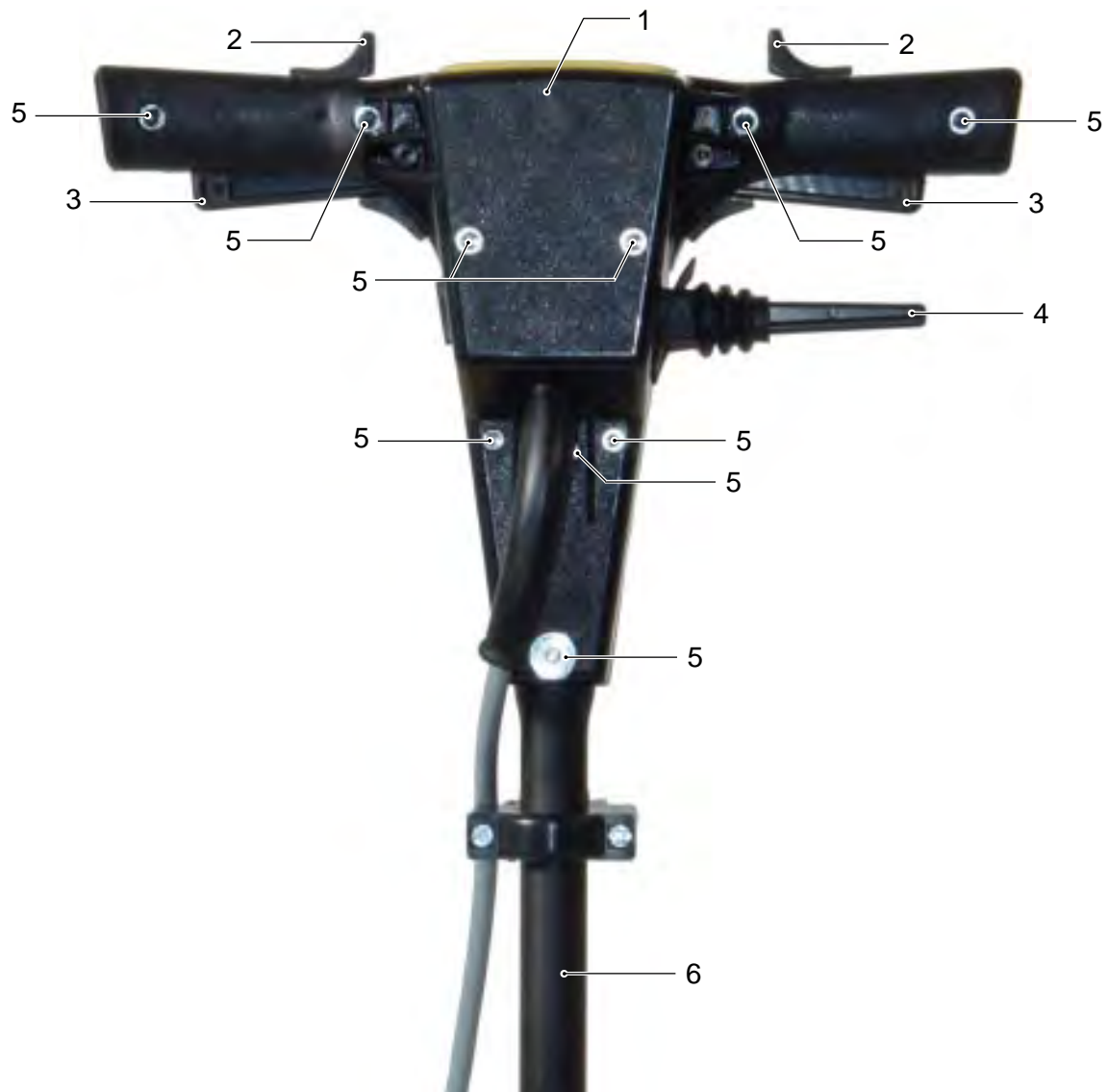
Guide handle (view from the rear)

- 1 Cover
- 2 Unlock unit switch
- 3 Lever, unit OFF/ON switch
- 4 Unlock lever inclination adjustment
- 5 Retaining screws for cover (10x)
- 6 Guide rod

Guide handle open (view from the front)

- 1 Unlock unit switch
- 2 Lever, unit OFF/ON switch
- 3 Unit switch
- 4 Unlock lever inclination adjustment
- 5 Guide rod

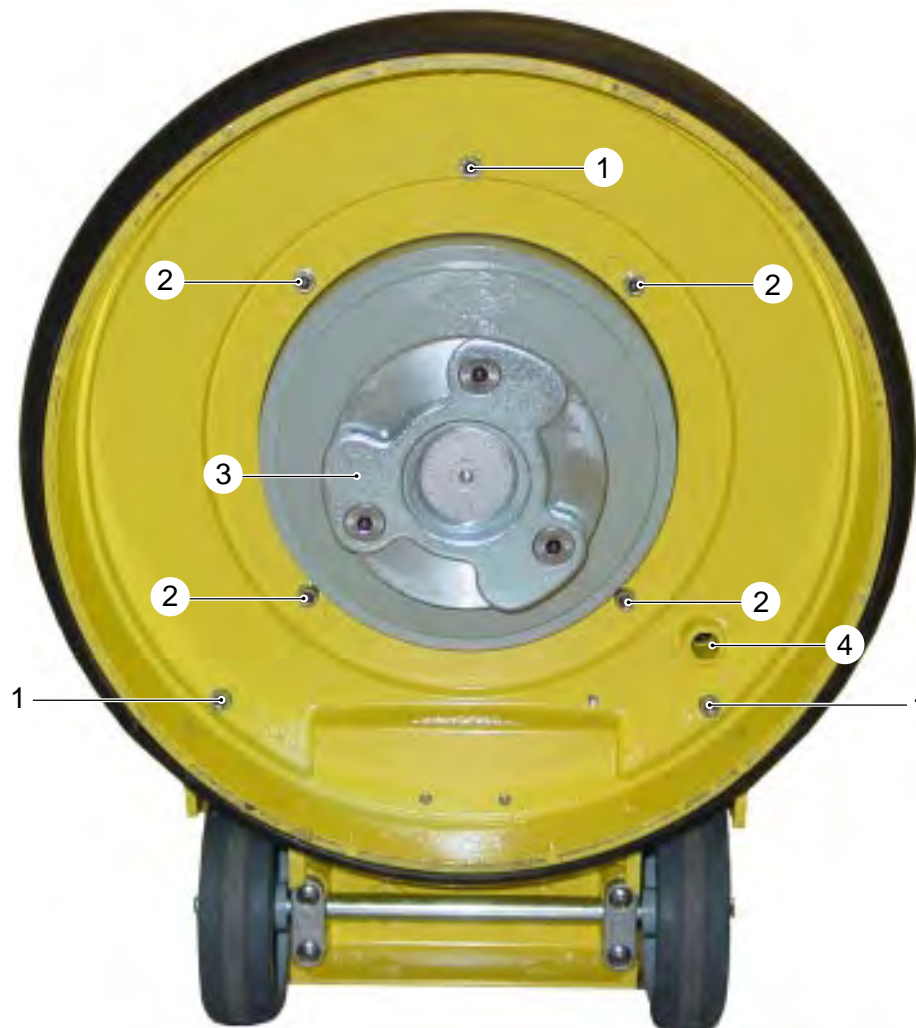
View from underneath (without disc brush)

- 1 Retaining screws for motor cover (3x)
- 2 Retaining screws for motor (4x)
- 3 Disc brush attachment
- 4 Cleaning agent outlet opening

Motor cover removed



Remove motor cover (2)

- Remove the retaining screws (Item 1, page 7) of the motor cover (2).
- Loosen threaded cable connection (1) and push the connection cable several centimetres inwards.
- The motor cover can now be removed and placed to the side.

- 1 Threaded cable connection
- 2 Motor cover
- 3 Operating capacitor
- 4 Starting capacitor
- 5 Brush motor
- 6 Fan wheel

Dismantle motor

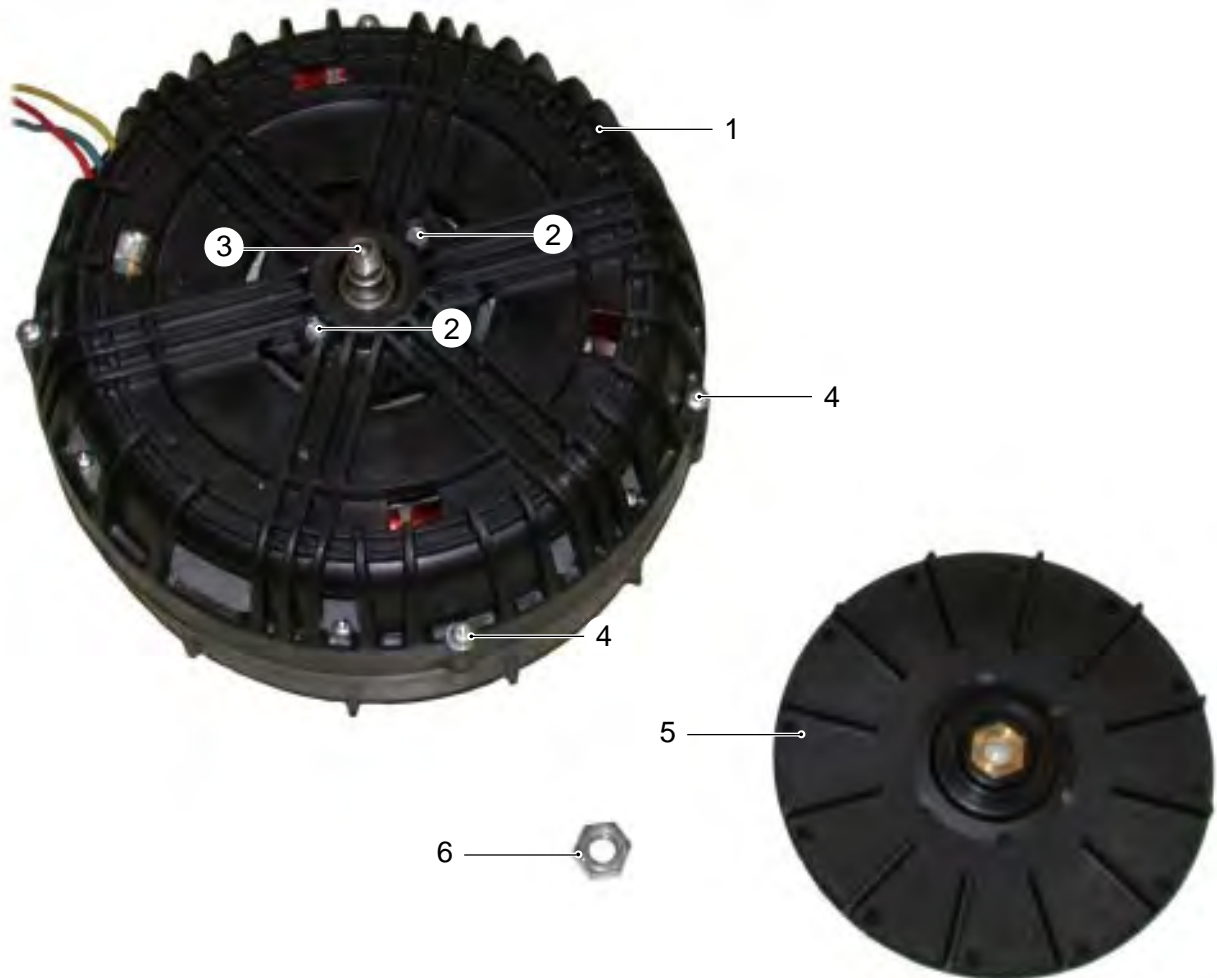

- 1 Upper housing
- 2 Retaining screws centrifugal switch
- 3 Motor drive shaft (rotor)
- 4 Retaining screws upper housing (4x)
- 5 Fan wheel
- 6 Fastening nut - fan wheel

- Remove retaining screws (see Item 2, page 7).
- Disconnect the electrical cables to the motor.
- Completely remove the motor from below.
- Unscrew the fastening nut (6) and pull off the fan wheel (5).
- Unscrew the retaining screws (4) and remove the upper housing (1) together with the fan.

Note:

Beneath the fan wheel (5) there are two retaining screws (2), to which the centrifugal switch is fastened. These must not be unscrewed. The centrifugal regulator is set in the factory and must not be dismantled. If necessary the complete motor must be replaced (see spare parts list).

Dismantle the planetary gears

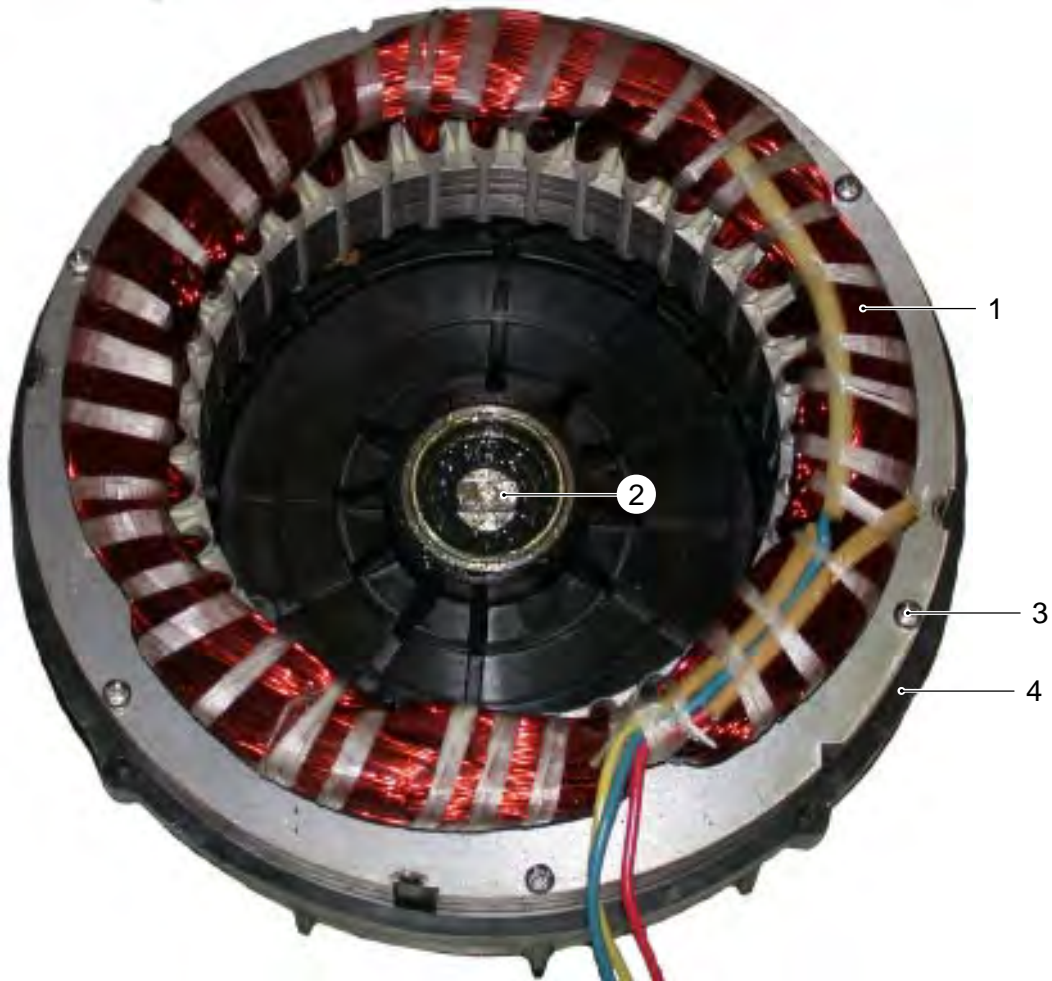

- 1 Motor winding (stator)
- 2 Planetary gear drive connection
- 3 Retaining screws of motor winding (6x) with planetary gear
- 4 Planetary gear

– Remove the retaining screws (3) of the motor winding (1) and remove the motor winding from the planetary gear (4).

Dismantle the planetary gears

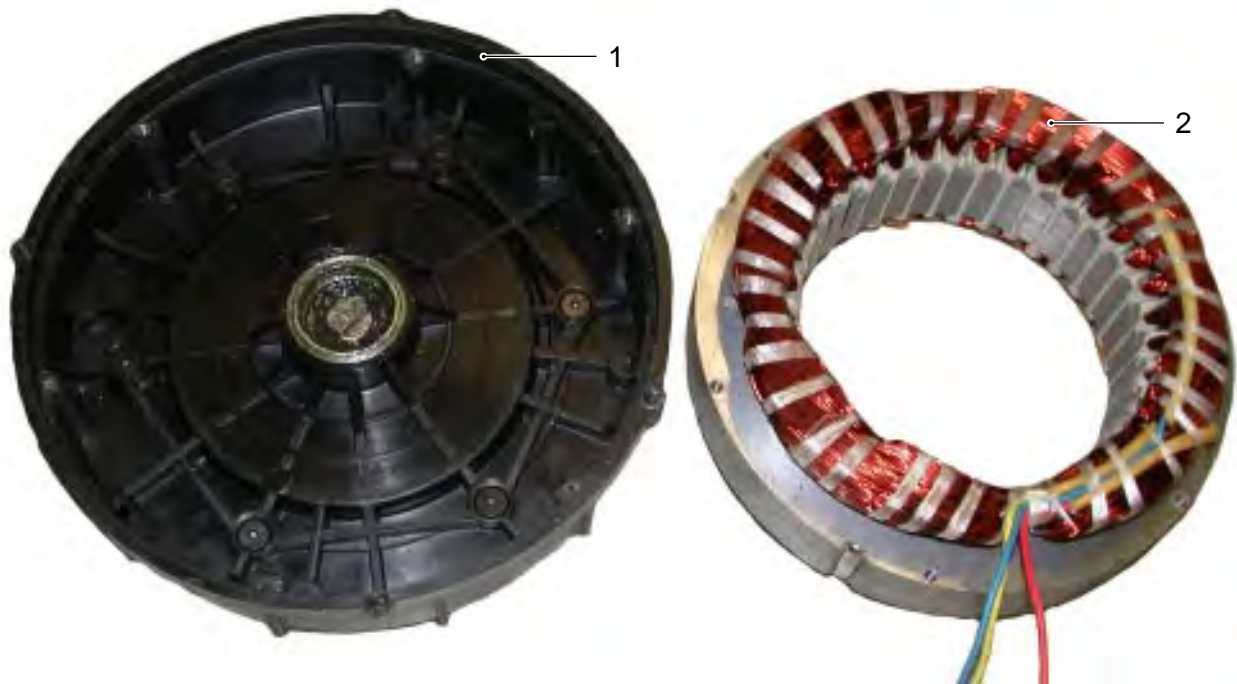

- 1 Planetary gear
- 2 Motor winding (stator)

Note:
The planetary gear assembly is exchanged as a complete unit.

Troubleshooting

Fault	Solution
Poor cleaning result	<ul style="list-style-type: none">– Check pad/brush for wear and replace if necessary.– Remove foreign particles/objects from the pad/brush.– Check the pad/brush for intended application.
Disc won't turn	<ul style="list-style-type: none">– Remove foreign particles/objects from the pad/brush.– Check/replace unit switch.– Check/replace capacitors.– Check/replace motor.– Check/replace gears.– Replace pad (clogged).
Unit runs erratically	<ul style="list-style-type: none">– Pad out of round, replace.– Centre the pad.

Technical specifications

Unit Type	Unit No.	Circuit diagram	Operating instructions	Spare parts list
BDS 33/190 S (220-240 Volt)	1.291-201	0.088-646	5.960-959	5.970-204

The technical data sheet and the circuit diagram will be included in the next issue of the spare parts CD-ROM (DISIS) and are available in the Intranet.

Technical data sheet: Folder: „Central / Service Info Int'l / Technical Specifications“

Circuit diagram: Folder: „Central / Service Info Int'l / Circuit Diagram“

If required, the operating instructions and the spare parts lists can be ordered as a paper copy from the spare parts service by quoting the relevant part number.

Special tools

No special tools are required.

Tightening torque

No details.