

# 24 Cylinder head

Professional \ High pressure cleaner hotwater \ Electric motor \ HDS 1195 \*EU-I \ Spare parts list HDS 1195 \*EUR \ Pump set \ Cylinder head

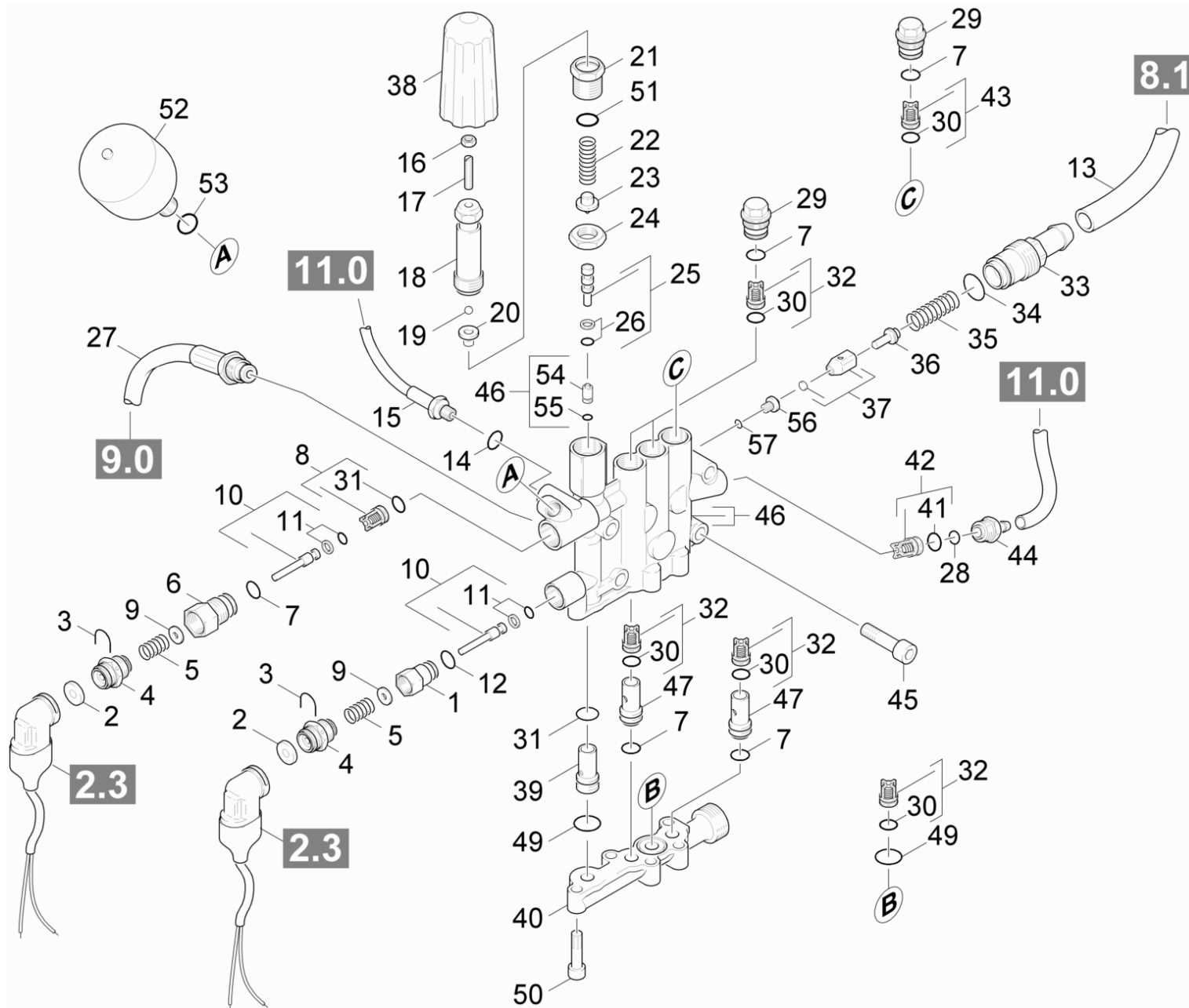

## 24 Cylinder head

Professional \ High pressure cleaner hotwater \ Electric motor \ HDS 1195 \*EU-I \ Spare parts list HDS 1195 \*EUR \ Pump set \ Cylinder head



POS	Preces Nr.	Apraksts	Skaitis	Vienība	Sērijas numurs no	Sērijas numurs līdz	Zemsvītras piezīme
1	5.402-705.0	Savienotājdetāļa	1.000	ST	0000000000	0000000000	
2	5.367-030.0	Membrāna	2.000	ST	0000000000	0000000000	
3	5.034-494.0	Retaining bracket	2.000	ST	0000000000	0000000000	
4	5.411-148.0	Vītņtapa	2.000	ST	0000000000	0000000000	
5	5.332-268.0	Spirālveida atspere	2.000	ST	0000000000	0000000000	
6	5.583-161.0	Vārsta skrūve	1.000	ST	0000000000	0000000000	
7	6.362-481.0	Gredzenblīve 14,0 x 2,0 NBR 80	6.000	ST	0000000000	0000000000	
8	4.580-262.0	Valve complete	1.000	ST	0000000000	0000000000	
9	5.115-796.0	Paplāksne	2.000	ST	0000000000	0000000000	
10	4.553-197.0	Valve	2.000	ST	0000000000	0000000000	
11	6.363-037.0	Gredzenblīve, pilns komplekts 1ST.-R.	2.000	ST	0000000000	0000000000	
12	6.362-853.0	Gredzenblīve 4,47x1,78	1.000	ST	0000000000	0000000000	
13	6.388-167.0	Hose DN15	1.000	M	0000000000	0000000000	TO ORDER AS CUT GOODS
14	7.362-003.0	Blīvgredzens A10x13,5 -Cu DIN 7603	1.000	ST	0000000000	0000000000	
15	6.389-635.0	Augstspiediena šļūtenes manometrs	1.000	ST	0000000000	0000000000	
16	7.311-002.0	hexagon nut	1.000	ST	0000000000	0000000000	
17	7.307-017.0	threaded pin	1.000	ST	0000000000	0000000000	
18	5.304-070.0	Skrūve ar sešstūru galvu	1.000	ST	0000000000	0000000000	
19	7.401-931.0	locking ring	1.000	ST	0000000000	0000000000	
20	5.582-121.0	Vārstu plate	1.000	ST	0000000000	0000000000	
21	5.404-082.0	hollow screw	1.000	ST	0000000000	0000000000	
22	5.332-444.0	Spirālveida atspere	1.000	ST	0000000000	0000000000	
23	5.584-114.0	valve pin	1.000	ST	0000000000	0000000000	
24	5.311-204.0	Sešstūra uzgrieznis M22 x 1,5	1.000	ST	0000000000	0000000000	
25	4.553-198.0	Piston complete only for replacement	1.000	ST	0000000000	0000000000	
26	6.362-468.0	Gredzenblīve, pilns komplekts 1ST.-R.	1.000	ST	0000000000	0000000000	
27	4.440-790.0	Hose SDS	1.000	ST	0000000000	0000000000	
28	6.362-151.0	Gredzenblīve 10 x 2 NBR 70	1.000	ST	0000000000	0000000000	
29	5.583-146.0	Vārsta skrūve	3.000	ST	0000000000	0000000000	

## 24 Cylinder head

Professional \ High pressure cleaner hotwater \ Electric motor \ HDS 1195 \*EU-I \ Spare parts list HDS 1195 \*EUR \ Pump set \ Cylinder head



POS	Preces Nr.	Apraksts	Skaits	Vienība	Sērijas numurs no	Sērijas numurs līdz	Zemsvītras piezīme
30	6.363-003.0	Gredzenblīve 13,0 X 2,0-NBR 90	6.000	ST	0000000000	0000000000	
31	6.362-381.0	Gredzenblīve 13x2 - NBR 70	2.000	ST	0000000000	0000000000	
32	2.884-512.0	Valve (3 Stueck)	1.000	ST	0000000000	0000000000	
33	5.583-168.0	valve screw safety	1.000	ST	0000000000	0000000000	
34	6.362-169.0	Gredzenblīve 12,0 X 2,0	1.000	ST	0000000000	0000000000	
35	5.332-473.0	Helical spring	1.000	ST	0000000000	0000000000	
36	5.584-122.0	valve pin	1.000	ST	0000000000	0000000000	
37	4.582-019.0	Valve disc complete	1.000	ST	0000000000	0000000000	
38	5.321-579.0	Handle	1.000	ST	0000000000	0000000000	
39	5.110-867.0	Čaula	1.000	ST	0000000000	0000000000	
40	5.587-202.0	Vārsta korpuss	1.000	ST	0000000000	0000000000	
41	6.362-077.0	Gredzenblīve 10 x 2,2 NBR 70	1.000	ST	0000000000	0000000000	
42	4.580-349.0	Valve complete chemistry	1.000	ST	0000000000	0000000000	
43	4.580-589.0	Valve with slot	1.000	ST	0000000000	0000000000	
44	5.443-474.0	Šļūtenes nipelis	1.000	ST	0000000000	0000000000	
45	7.306-155.0	Cil. galvas skr. M12x100 -8.8-A3E IS	4.000	ST	0000000000	0000000000	
46	4.550-606.0	Cilinder head	1.000	ST	0000000000	0000000000	
47	5.110-853.0	Uzmava	2.000	ST	0000000000	0000000000	
49	6.362-547.0	Gredzenblīve 20,0x1,5-NBR 70	2.000	ST	0000000000	0000000000	
50	7.306-043.0	Cil. galvas skr. M8x30 -8.8-A2E ISO	5.000	ST	0000000000	0000000000	
51	6.362-079.0	Gredzenblīve 18,0 X 2,5	1.000	ST	0000000000	0000000000	
52	6.505-054.0	Spiediena akumulators	1.000	ST	0000000000	0000000000	
53	6.362-176.0	Gredzenblīve 6,07x1,78	1.000	ST	0000000000	0000000000	
54	5.581-239.0	Vārsta ligzda	1.000	ST	0000000000	0000000000	
55	6.362-386.0	Gredzenblīve 5,0 x 1,5-NBR 80	1.000	ST	0000000000	0000000000	
56	5.581-231.0	Vārsta ligzda	1.000	ST	0000000000	0000000000	
57	6.362-703.0	Gredzenblīve 6,0x1,5-NBR 70	1.000	ST	0000000000	0000000000	
100	2.883-914.0	Spare part set pump HDS 1295	1.000	ST	0000000000	0000000000	