

## Display

Battery charge indicator (approx. 45 min. run time)

Akkuladestand (ca. 45 Min. Laufzeit)

Dirty water tank full  
Schmutzwassertank voll

Level 2

Boost button  
Boost-Taste



Fresh water tank empty  
Frischwassertank leer

Level 1

Switch button  
Einstellungstaste

On/Off switch  
Ein-/Aus-Schalter

Scan code for videos  
Code scannen für Videos



[www.kaercher.com/fc7](http://www.kaercher.com/fc7)

**KÄRCHER**

# FC 7 CORDLESS QUICKSTART GUIDE

First assembly  
Erstmontage

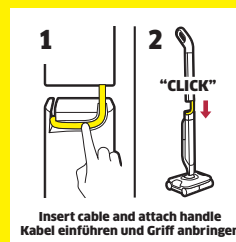

First steps before use  
Erste Schritte vor dem Einsatz

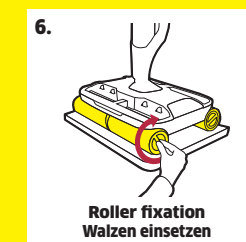
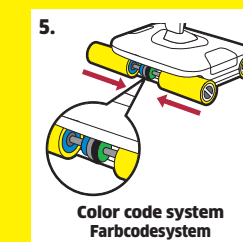
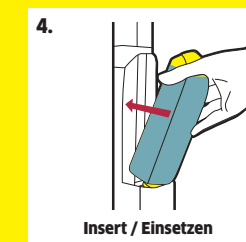
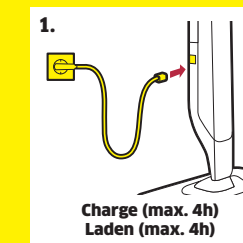



**Switch cleaning mode**  
**Reinigungsmodus wechseln**

Level 1



Level 2



**Activate boost function**  
**Boost-Funktion aktivieren**

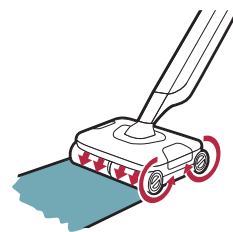

**Please note:**  
Frequent boosting causes dirty water tank to fill quickly.

**Hinweis:**  
Durch Anwenden der Boostfunktion wird der Schmutzwassertank schneller voll.

**Cleaning and storing**  
**Reinigung und Verstaung**

**Step 1: Clean the device**  
**Schritt 1: Gerat reinigen**

1.

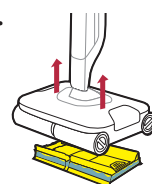

2.



3.

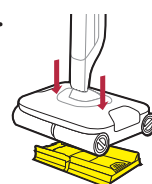

4.

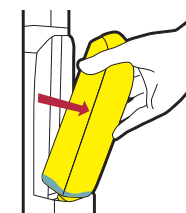

5.

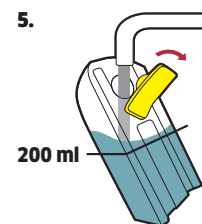

6.

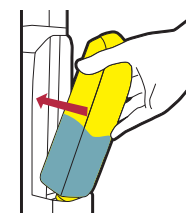

7.

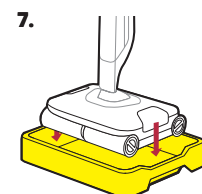

8.

Press 3 sec.  
3 Sek. gedruck halten



9.

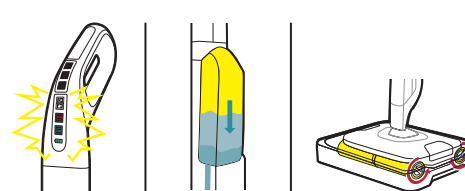

Please wait about 2 min. Bitte ca. 2 Min. warten

**Step 2: Store the device**  
**Schritt 2: Gerat verstauen**



10.

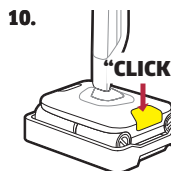

11.

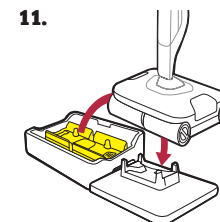

12.

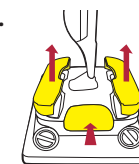

13.

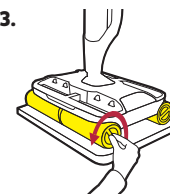

14.

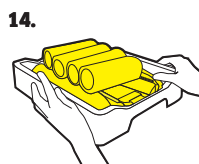

15.

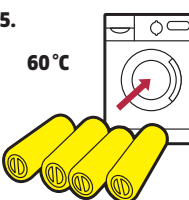

16.



17.

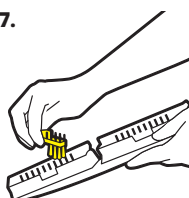

18.

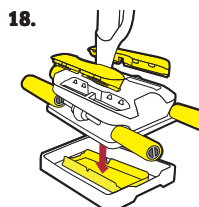

19.

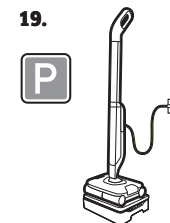

**Refill fresh water tank**  
**Frischwassertank auffullen**

1.



2.

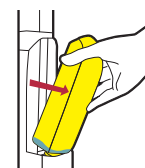

3.

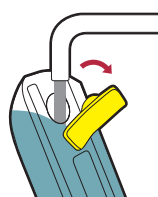

4.

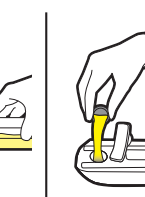

5.

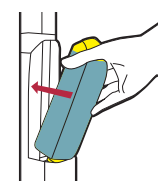

**Empty dirty water tank**  
**Schmutzwassertank leeren**

1.



2.

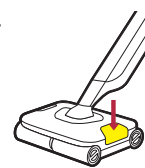

3.

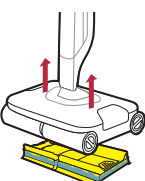

4.



5.

