

USAfix™ - Repair Guide (RG) - Master

- Replace the brush motor

Level of Difficulty - Medium

Estimated Completion Time - 15 minutes

TASKI - SWINGO 150





Tools Required

Tool	
Screwdriver-phillips	

Parts Required

Part	Description	Price	Available	Purchase
192-9911	120V 60Hz brush motor	\$275.24	Back Order	Qty: <input type="text" value="1"/>

Step		Procedure & Parts & Tools
1		PUSH IN ON THE 2 ORANGE TABS TO REMOVE THE BASE COVER.
2		REMOVE THE BASE COVER.
3		LOOSEN THE BRUSH HEIGHT KNOB AND REMOVE IT. SET IT ASIDE.

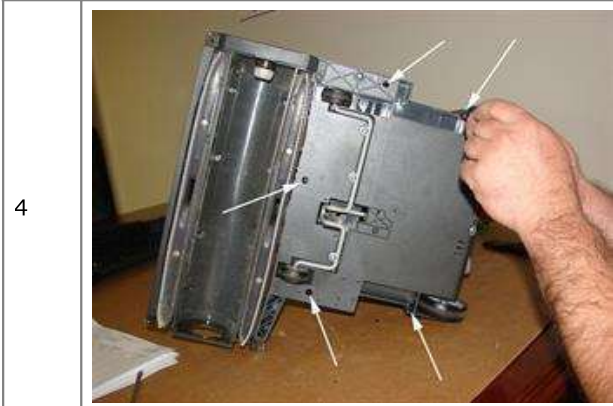

FLIP THE BASE OVER AND REMOVE THE 5 SCREWS.

Screwdriver-phillips



FLIP THE BASE BACK OVER AND REMOVE THE BRUSH MOTOR COVER.

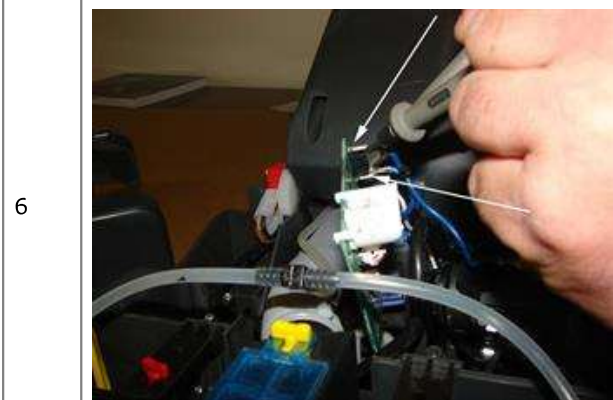

REMOVE THE 2 SCREWS HOLDING THE BRUSH MOTOR IN PLACE.

Screwdriver-phillips



PULL TO DISCONNECT ALL THE WIRES FROM THE BRUSH MOTOR.

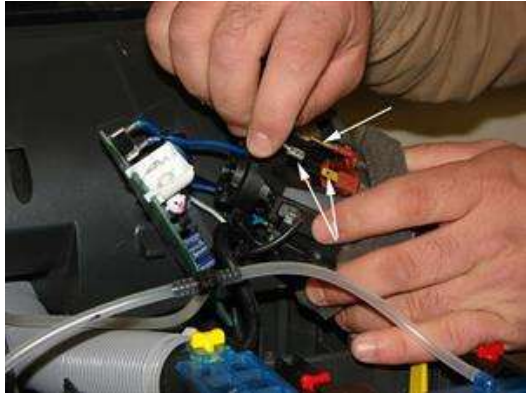

8 

REVERSE STEPS 1 THRU 7 TO INSTALL A NEW BRUSH MOTOR.

Part	Description	Price	Qty
192-9911	120V 60Hz brush motor	\$275.24	Qty: <input type="text" value="1"/>