



The Puzzi 30/4 spray extraction machine is the economical cleaning solution for large carpet surfaces and makes cleaning ergonomic, stress-free and quick.

1 User-friendly EASY-Operation operating concept

2 Removable dirty water tank

- To protect against dirt, the dirty water tank's handle is attached to the outside.
- The dirty water tank is easy to remove and can also be used to fill the fresh water tank.

3 Extremely quiet

- At just 66 dB(A), the Puzzi 30/4 is the quietest wet vacuum cleaner of its kind.
- Thanks to the low noise volume, the machine can be used everywhere, even during business hours and in hotels.

4 For large areas



Puzzi 30/4

- Removable dirty water tank
- Fresh water tank filling level display
- Horizontal transport possible with full fresh water tank

Technical data

Order no.	1.101-120.0	
EAN code	4039784632417	
Max. area performance	m ² /h	60-75
Air flow	l/s	74
Vacuum	mbar / kPa	254 / 25.4
Spray rate	l/min	3
Spray pressure/back pressure	bar	4
Fresh/dirty water tank	l	30 / 15
Turbine power	W	1200
Pump power rating	W	70
Weight	kg	26
Dimensions (L × W × H)	mm	580 × 460 × 930
Voltage	V	220-240
Frequency	Hz	50-60

Equipment

Spray hose with integrated water feed	m	4
Power outlet for professional power brush		PW 30/1
Spray suction hose with handle	m	4
Additional handle		■
Handle with trigger		■
Wide floor nozzle, complete with flexible suction lip		■
■ Included in delivery.		

Accessories for Puzzi 30/4 1.101-120.0

KÄRCHER

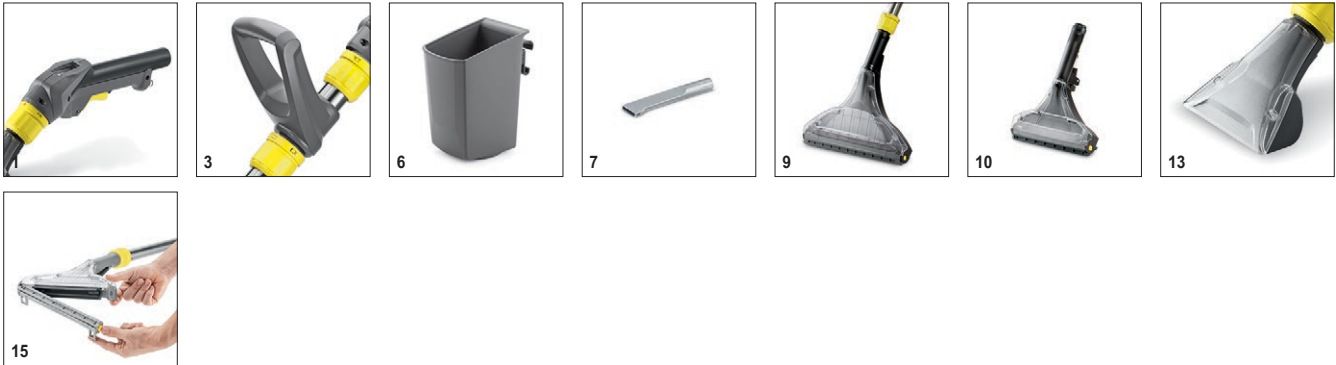

		Order no.	Quantity	ID	Width	Length	Price	Description	
Other									
Handle	1	4.130-000.0	1 piece(s)	ID 32				Enables quick change of floor, upholstery and crevice nozzles. With sight glass for checking the vacuumed dirty water. Adapters for spray and suction hose.	■
Extension tube	2	4.025-004.0	1 piece(s)	ID 32	780 mm			Extension tube, individual.	■
D-handle	3	4.321-001.0	1 piece(s)					D-handle, individual, for extension tube 4.025-004.0. Adjustable without tools	■
Cleaning agent tank, individual	4	5.070-010.0	1 piece(s)					For attaching with Home Base adapter.	■
Defoamer agent tank	5	4.006-907.0	1 piece(s)	ID 32				Container for defoamer solution.	□
Cleaning agent container, complete	6	4.070-006.0	1 piece(s)					Kit consisting of cleaning agent container and Home base adapter. For connecting Home base rail.	□
Crevice nozzle	7	4.130-010.0	1 piece(s)	ID 32				Crevice nozzle for spray extraction cleaners.	□
Floor tools									
Flexible floor nozzle, 350 mm, complete	8	4.130-011.0	1 piece(s)	ID 32	350 mm			Kit consisting of floor nozzle (350 mm), suction pipe and D-handle. Transparent sight glass for checking the vacuumed dirty water. Flexible squeegee.	■
Flexible floor nozzle, 350 mm, individual	9	4.130-009.0	1 piece(s)	ID 32	350 mm			Floor nozzle (350 mm), individual. Transparent field of view for checking the vacuumed dirty water. Flexible squeegee. Included in kit 4.130-011.0.	■
Flexible floor nozzle, 240 mm, complete	10	4.130-007.0	1 piece(s)	ID 32	240 mm			Kit consisting of floor nozzle (240 mm), suction pipe and D-handle. Transparent sight glass for checking the vacuumed dirty water. Flexible squeegee.	□
Flexible floor tool, 240 mm, single	11	4.130-008.0	1 piece(s)	ID 32	240 mm			Floor nozzle (240 mm), individual. Transparent sight glass for checking the vacuumed dirty water. Flexible suction bar. Included in kit 4.130-007.0.	□
Spray suction hoses									
Spray suction hose, 4 m	12	6.394-874.0	1 piece(s)	ID 32		4 m		Standard spray/suction hose.	■
Upholstery tools									
Upholstery tool	13	4.130-001.0	1 piece(s)	ID 32	110 mm			Upholstery nozzle, 110 mm.	□
Hard surface adapters									
Hard floor rubber adapter small 240 mm	14	4.762-014.0	1 piece(s)		240 mm			Hard surface adapter for floor nozzle, 240 mm.	□
Hard floor rubber adapter big 350 mm	15	4.762-017.0	1 piece(s)		350 mm			Hard surface adapter for floor nozzle, 350 mm.	□

■ Included in delivery. □ Available accessories.

Accessories for Puzzi 30/4 1.101-120.0



		Order no.	Length	Colour	Quantity	Price	Description	
Home Base accessories								
Home Base adaptor	1	5.035-488.0			1 piece(s)		Fastener for various hooks and clips on the machine.	■

■ Included in delivery. □ Available accessories.