

# 10 Suction bar v-shaped 900mm (9.312-173.0)

Professional \ Floor cleaner \ Walk behind \ B 60 W Bp \ Suction bar v-shaped \ Suction bar v-shaped 900mm

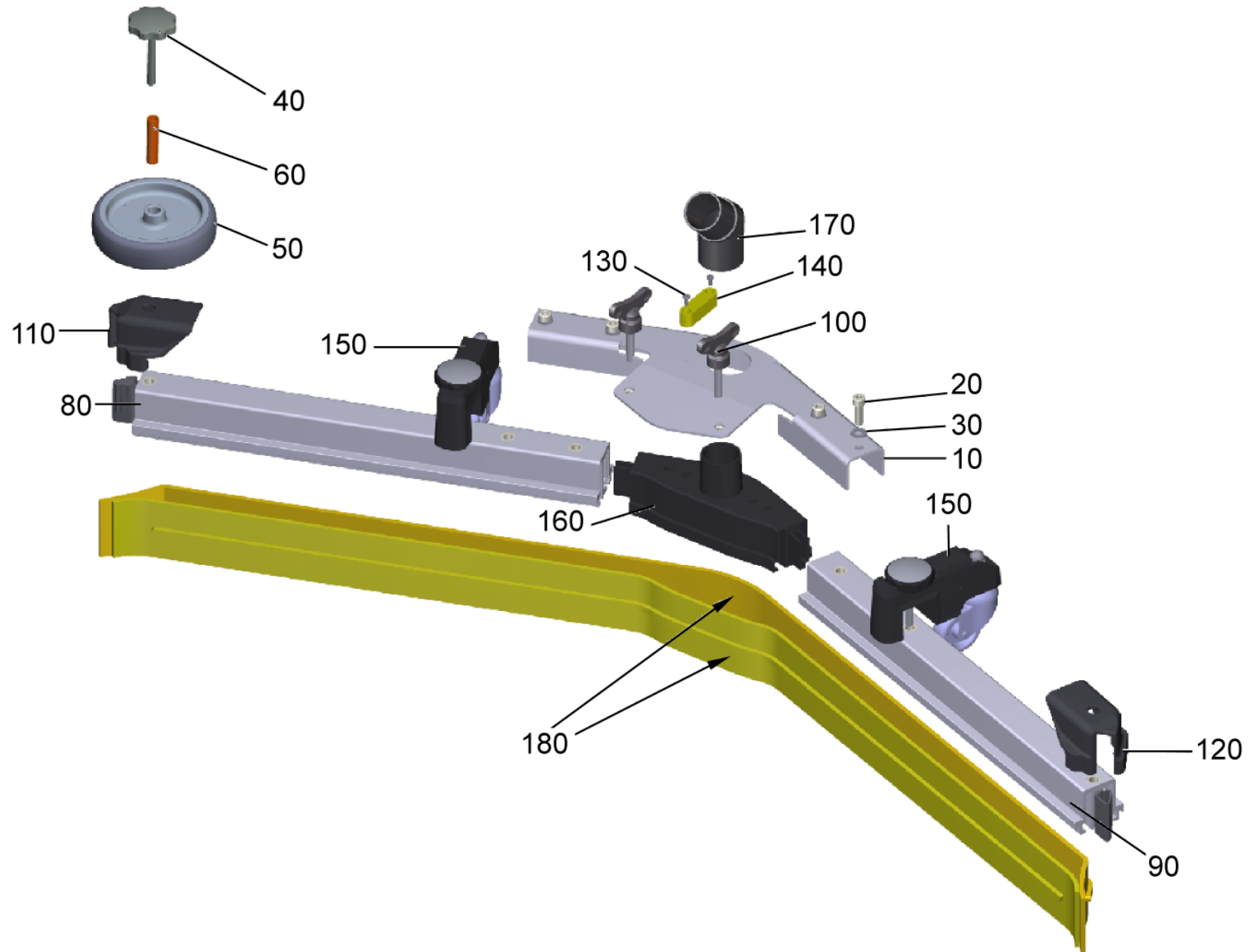

# 10 Suction bar v-shaped 900mm (9.312-173.0)

Professional \ Floor cleaner \ Walk behind \ B 60 W Bp \ Suction bar v-shaped \ Suction bar v-shaped 900mm



POS	Article no.	Description	Quantity	Unit	Remark
170	5.034-056.0	Angle adapter pipe	1	PC	
20	7.306-042.0	Cylinder head screw M8x25 -8.8-A2E ISO4	4	PC	
50	6.435-541.0	Deflector roll D125	2	PC	
110	2.885-294.0	End piece left / right spare parts set	1	PC	Acompanha cantoneira direita e esquerda
120	2.885-294.0	End piece left / right spare parts set	1	PC	Acompanha cantoneira esquerda e direita
10	4.044-003.0	Holder complete V-profile	1	PC	
	<b>Item text1:</b> replaced by 9.753-462.0				
10	9.753-462.0	Holder station V-profile 5mm	1	PC	
	<b>Item text1:</b> successor of 4.044-003.0				
140	6.803-071.0	Level	1	PC	
90	4.035-163.0	Profile pre-assembled left AB 900 mm	1	PC	
80	4.035-162.0	Profile pre-assembled right AB 900 mm	1	PC	
180	6.273-023.0	Rubber lip set corrugated oil resistant	1	PC	
130	9.386-163.0	SELF TAPPING SCREW M4 X 20	2	PC	
60	5.094-496.0	Sleeve suction bar VA	2	PC	
40	6.321-170.0	Star grip M8X60 - VA	2	PC	
	<b>Item text1:</b> replaced by 6.321-353.0				
40	6.321-353.0	Star grip M8X70 - VA	2	PC	
	<b>Item text1:</b> successor of 6.321-170.0				
160	4.034-007.0	Suction nipple complete	1	PC	
150	4.035-557.0	Support roller complete replacement	1	PC	
30	7.312-004.0	Washer 8 -200HV-A3E ISO 7089	12	PC	
50	6.435-342.0	Wheel gummed D124 Di12	2	PC	
	<b>Item text1:</b> replaced by 6.435-541.0				
100	5.305-008.0	Wing screw M8x30 VA	2	PC	