

# 22 Cylinder head

Professional \ High pressure cleaner hotwater \ Electric motor \ HDS 695 M ECO \*EU \ Spare parts list HDS 695 M ECO \ Pump set \ Cylinder head

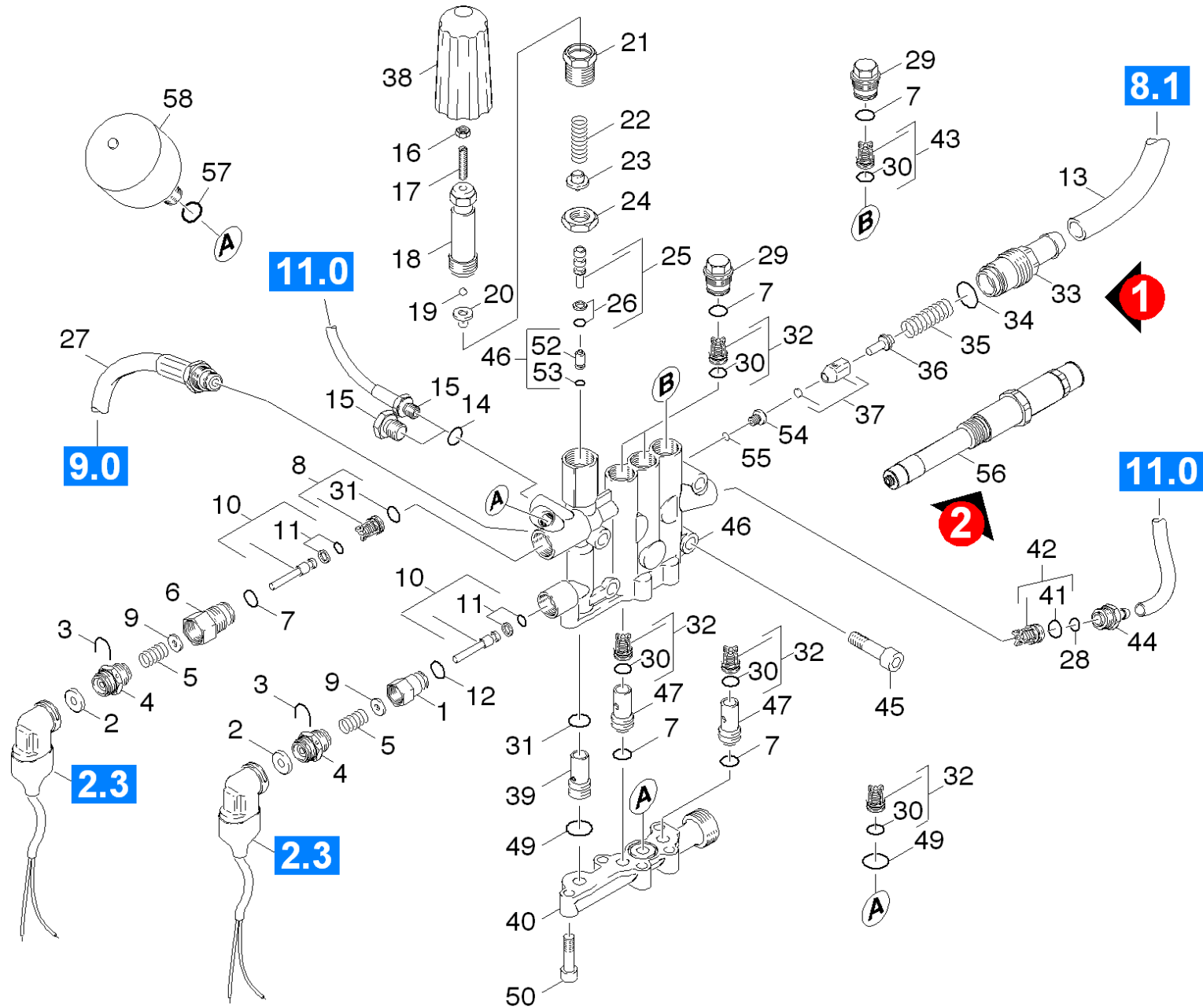

## 22 Cylinder head

Professional \ High pressure cleaner hotwater \ Electric motor \ HDS 695 M ECO \*EU \ Spare parts list HDS 695 M ECO \ Pump set \ Cylinder head



POS	Article no.	Description	Quantity	Unit	Remark	Foot note text
1	5.402-705.3	Joining piece	1.000	ST		
2	5.367-030.0	Diaphragm	2.000	ST		
3	5.034-494.0	Retaining bracket	2.000	ST		
4	5.411-148.0	Screw plug	2.000	ST		
5	5.332-268.0	Helical spring	2.000	ST		
6	5.583-161.0	Valve screw	1.000	ST		
7	6.362-481.0	O-Ring seal 14,0 x 2,0 NBR 80	6.000	ST		
8	4.580-262.0	Valve complete	1.000	ST		
9	5.115-796.0	Washer	2.000	ST		
10	4.553-197.0	Piston complete only for replacement	2.000	ST		
11	6.363-037.0	O-Ring seal complete 1ST.-R.	2.000	ST		
12	6.362-853.0	O-Ring seal 4,47x1,78	1.000	ST		
13	6.388-167.0	Hose DN15	1.000	M		TO ORDER AS CUT GOODS
14	7.362-003.0	Joint ring A10x13,5 -Cu DIN 7603	1.000	ST		
15	6.389-635.0	High pressure hose pressure gauge	1.000	ST		
	<b>Item text1:</b> / 1.025-311.0 / -312.0 / -315.0 / -316.0					
	<b>Item text2:</b> / -317.0 / -325.0					
15	5.411-070.0	Screw plug	1.000	ST		
	<b>Item text1:</b> / 1.025-318.0 /-319.0 /-320.0					
	<b>Item text2:</b> /-324.0 /-351.0 /-352.0					
16	7.311-002.0	Hexagon nut M5 -8-A2E ISO 4032	1.000	ST		
17	7.307-017.0	Threaded pin M5x40 -St-45H-A2E ISO 4026	1.000	ST		
18	5.304-070.0	Hexagonal head screw	1.000	ST		
19	7.401-931.0	Sphere 5 KI3 -1.4401 DIN 5401	1.000	ST		
20	5.582-121.0	Valve disc	1.000	ST		
21	5.404-082.0	Hollow screw	1.000	ST		
22	5.332-444.0	Helical spring	1.000	ST		
23	5.584-114.0	Valve pin	1.000	ST		
24	5.311-204.0	Hexagon nut M22x1,5	1.000	ST		
25	4.553-198.0	Piston complete only for replacement	1.000	ST		
26	6.362-468.0	O-Ring seal complete 1ST.-R.	1.000	ST		
27	6.391-596.0	High pressure hose DN 13	1.000	ST		

## 22 Cylinder head

Professional \ High pressure cleaner hotwater \ Electric motor \ HDS 695 M ECO \*EU \ Spare parts list HDS 695 M ECO \ Pump set \ Cylinder head



POS	Article no.	Description	Quantity	Unit	Remark	Foot note text
27	6.389-568.0	High pressure hose DN 8	1.000	ST		
	<b>Item text1:</b> 1.025-351.0 /-352.0					
28	6.362-151.0	O-Ring d. 10 x 2 NBR 70	1.000	ST		
29	5.583-146.3	Valve screw	3.000	ST		
30	6.363-003.0	O-Ring seal 13,0 X 2,0-NBR 90	6.000	ST		
31	6.362-381.0	O-Ring seal 13x2 - NBR 70	2.000	ST		
32	2.884-512.0	Valve (3 Stueck)	5.000	ST		
33	5.583-168.0	Valve screw safety valve	1.000	ST	VERSION 1	
34	6.362-169.0	O-Ring seal 12,0 X 2,0	1.000	ST	VERSION 1	
35	5.332-473.0	Helical spring	1.000	ST	VERSION 1	
36	5.584-122.0	Valve pin	1.000	ST	VERSION 1	
37	4.582-019.0	Valve disc complete	1.000	ST	VERSION 1	
38	5.321-579.0	Handle	1.000	ST		
39	5.110-863.0	Sleeve	1.000	ST		
	<b>Item text1:</b> 1.025-311.0 / -312.0 / -315.0 / -316.0 / -317.0 /-318.0 /-319.0 /-320.0 /-324.0 / -325.0					
39	5.110-797.0	Sleeve	1.000	ST		
	<b>Item text1:</b> / 1.025-351.0 /-352.0					
40	5.587-202.0	Valve housing	1.000	ST		
41	6.362-077.0	O-Ring seal 10 x 2,2 NBR 70	1.000	ST		
42	4.580-349.0	Valve complete chemistry	1.000	ST		
43	4.580-589.0	Valve with slot	1.000	ST		
44	5.443-474.0	Hose stem	1.000	ST		
45	7.306-155.0	Cylinder head screw M12x100 -8.8-A3E IS	4.000	ST		
46	4.550-607.0	Cylinder head complete only for replacem	1.000	ST		
47	5.110-853.0	Sleeve	2.000	ST		
49	6.362-547.0	O-Ring seal 20,0x1,5-NBR 70	2.000	ST		
50	7.306-043.0	Cylinder head screw M8x30 -8.8-A2E ISO	5.000	ST		
52	5.581-239.0	Valve seat	1.000	ST		
53	6.362-386.0	O-Ring seal 5,0 x 1,5-NBR 80	1.000	ST		
54	5.581-231.0	Valve seat	1.000	ST	VERSION 1	
55	6.362-703.0	O-Ring seal 6,0x1,5-NBR 70	1.000	ST	VERSION 1	
56	4.580-727.0	Safety valve kpl. Ersatz	1.000	ST	pos.55 mitbestellen / order pos.55 also	VERSION 2

## 22 Cylinder head

Professional \ High pressure cleaner hotwater \ Electric motor \ HDS 695 M ECO \*EU \ Spare parts list HDS 695 M ECO \ Pump set \ Cylinder head



POS	Article no.	Description	Quantity	Unit	Remark	Foot note text
57	6.362-176.0	O-Ring seal 6,07x1,78	1.000	ST		
58	6.505-054.0	Pressure accumulator	1.000	ST		
100	2.883-913.0	Spare part set pump	1.000	ST		